

LAKE COUNTY
LAK-2-16.49

Approx. 1 mile East of East Corporation Line of Painesville.

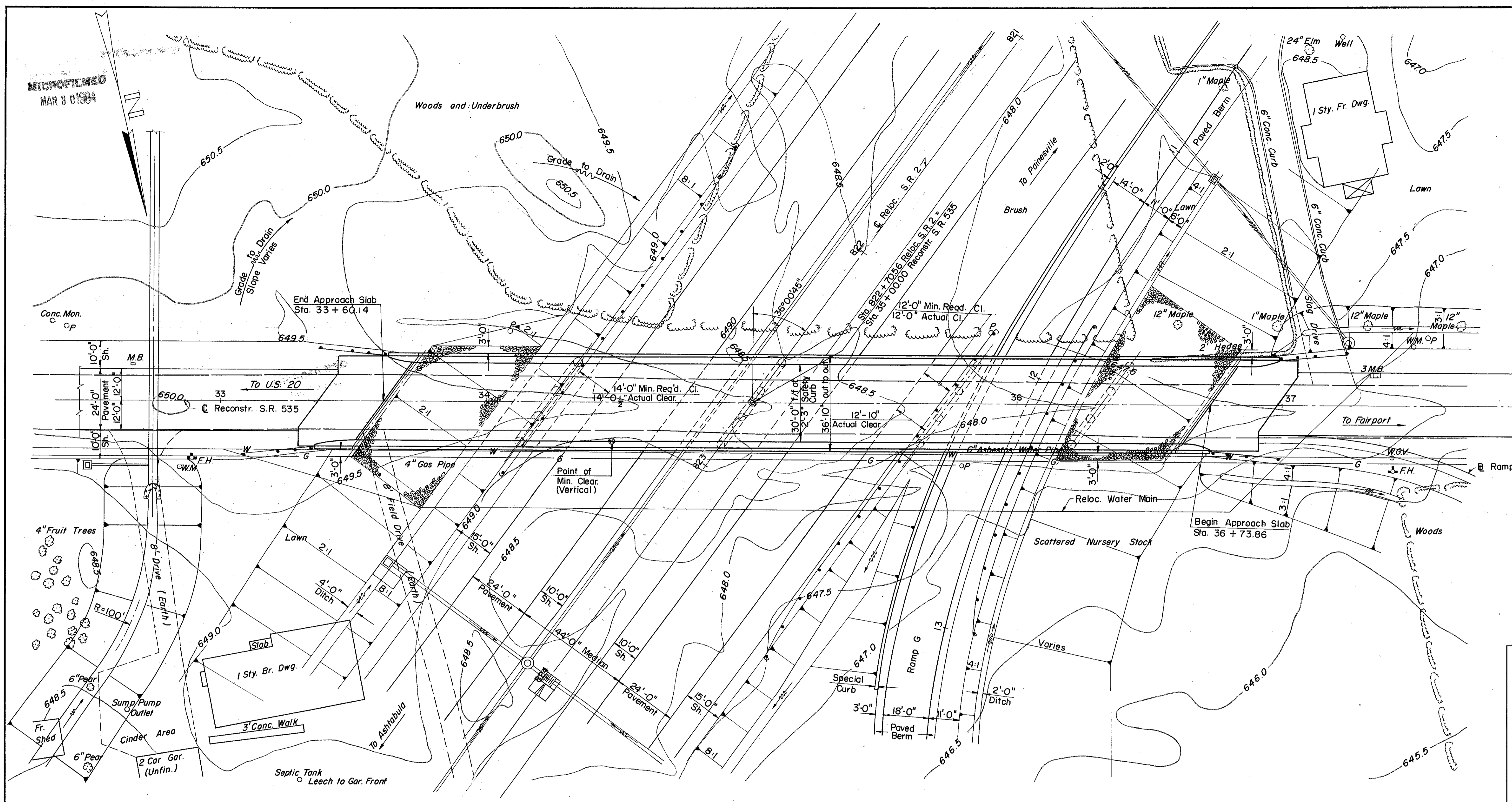

B.M. # 84 - Iron pin in concrete property corner. Northeast corner of intersection S.R. 535 and U.S. Rt. 20. 26' Lt. of Sta. 55 + 50 on U.S. 20. 508' Rt. of Sta. 827 + 095 on Reloc. S.R. 2. El. 655.560

FOUNDATION SOUNDINGS: Foundation design and foundation quantities are based on a study of rod soundings and soil-sampling soundings made at the site. This sounding information may be inspected in the office of the Bureau of Bridges in Columbus or in the Division Office, but the State does not guarantee the accuracy thereof.

PROPOSED STRUCTURE

TYPE: 5 Span continuous Steel Beam with Reinforced Concrete Deck & Substructure.
 SPANS: 61'-0", 76'-1", 74'-7", 57'-6", 39'-0" % Brgs.
 ROADWAY: 30'-0" 1/4 Safety Curbs
 LOAD FREQUENCY: CF 400 (57)
 WEARING SURFACE: 1" monolithic concrete
 APPROACH SLABS: Special (25'-0" Long)
 ALIGNMENT: S.R.2 & S.R.535 - Tangent
 SKEW: 36°00'45" L.F.
 A.D.T. Reloc. S.R.2 11,020 (1980)
 A.D.T. Reconstr. S.R.535 4,170 N, 1,100 S. (1980)

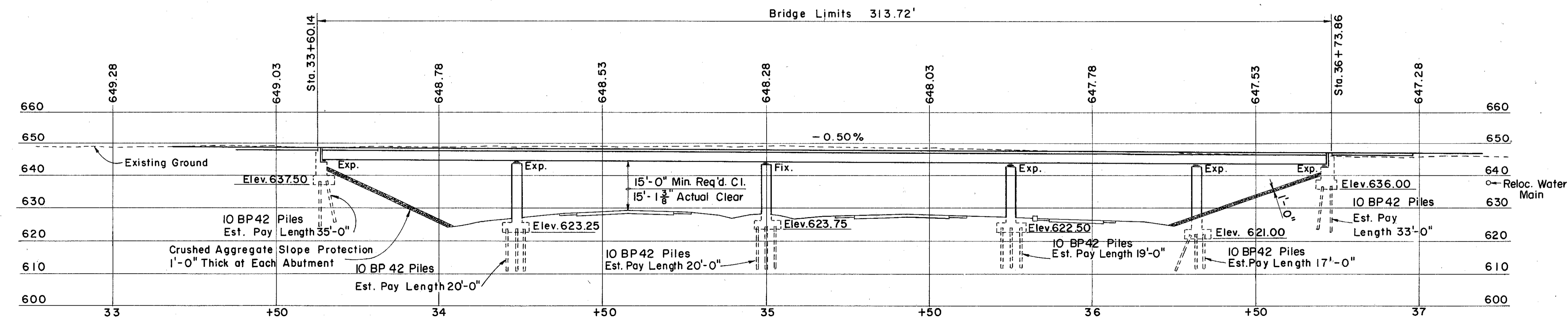

PREPARED BY
CAPITOL ENGINEERING ASSOCIATES, DILLSBURG, PA.
FOR
STATE OF OHIO
DEPARTMENT OF HIGHWAYS
DIVISION OF DESIGN AND CONSTRUCTION
BUREAU OF BRIDGES
SITE PLAN
BRIDGE NO. LAK-2-1748
RELOC. S.R.2 UNDER RECONSTR. S.R. 535
LAKE COUNTY
STA. 822 + 70.56

DESIGNED	DRAWN	TRACED	CHECKED	REVIEWED	DATE	REVISED
	M.J.F.	FW.B.	L.L.D.	J.H.T.		

MICROFILMED
MAR 3 01984