

LAKE COUNTY  
LAK-2-16.49

Located 0.8 Miles East of East Corporation Line of Painesville.

B.M. #85A - R.R. Spike in North Side of 18" Walnut Tree  
199' Rt. of Sta. 816+38  
Elev. 614.919

FOUNDATION SOUNDINGS: Foundation design and foundation quantities are based on a study of soil-sampling soundings made at the site. This sounding information, the accuracy of which the State does not guarantee, may be examined in the office of the Bureau of Bridges in Columbus or in the Division office.

**PROPOSED STRUCTURE**

TYPE: Two 1-Span Reinf. Conc. Slab and Substructure.

SPAN: 20'-0"

ROADWAY: Full width, distance  $\frac{1}{4}$  of parapets varies.

LOAD FREQUENCY: CF = 2000 (57)

WEARING SURFACE: 1" monolithic concrete.

APPROACH SLABS: AS-1-54 (25'-0" Long)

ALIGNMENT: Tangent

SKEW: 20° R.F.

A.D.T. 17,160 (1980)

DRAINAGE AREA: 5,700 Acres

DESIGN FLOW: 1,570 c.f.s. (Q<sub>25</sub>)

PREPARED BY  
CAPITOL ENGINEERING ASSOCIATES, DILLSBURG, PA.  
FOR

STATE OF OHIO  
DEPARTMENT OF HIGHWAYS  
DIVISION OF DESIGN AND CONSTRUCTION  
BUREAU OF BRIDGES

**SITE PLAN**  
BRIDGE NO. LAK-2-1731 L. & R.  
RELOC. S.R.2 OVER RED CREEK  
LAKE COUNTY  
STA. 813 + 98.94  
STA. 814 + 21.06

DESIGNED	DRAWN	TRACED	CHECKED	REVIEWED	DATE	REVISED
	M.J.F.	F.W.B.	J.H.T.			

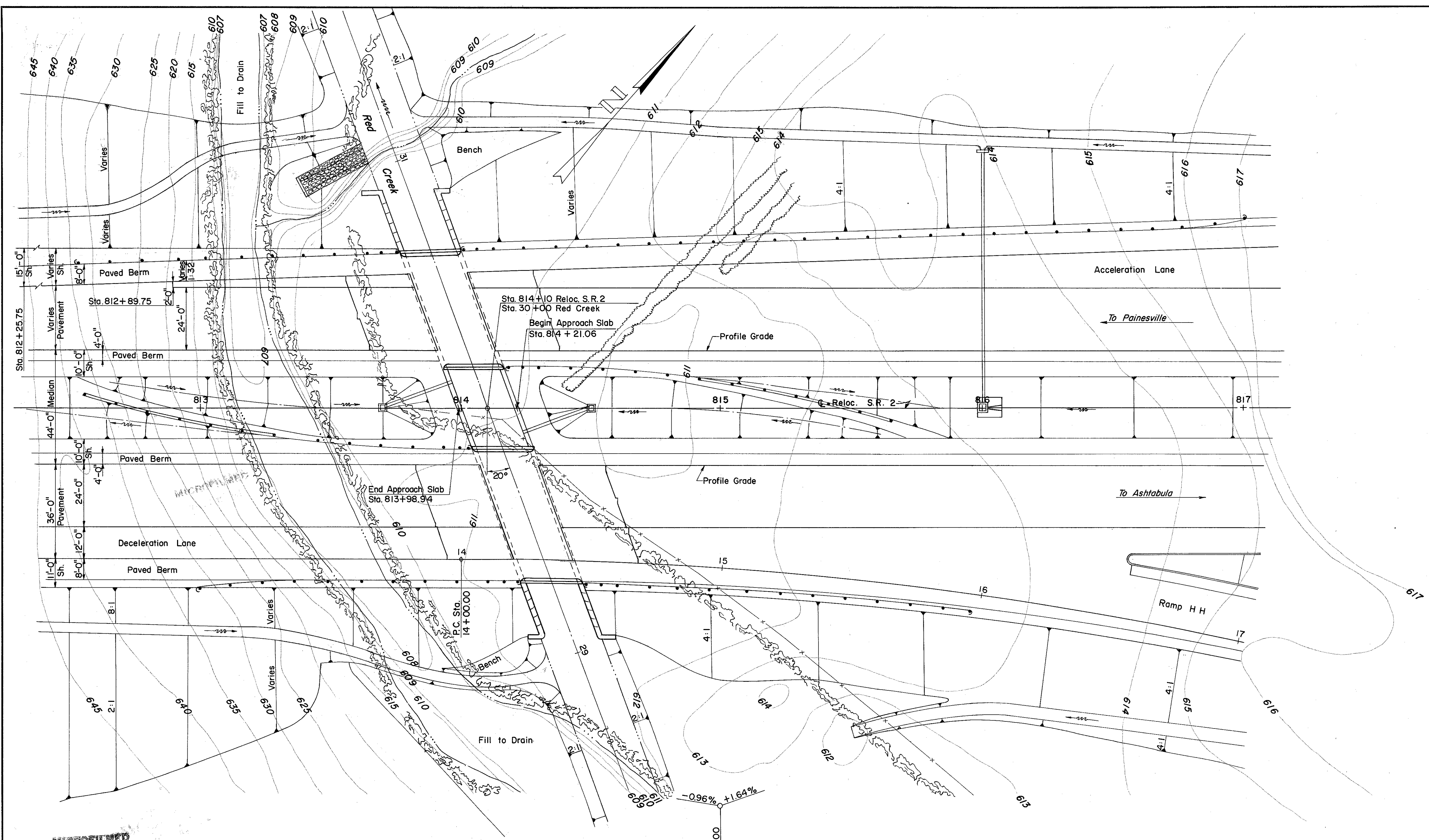

MICROFILMED  
MAR 3 0 1984

