

SEEDING  
END  
WIDTH

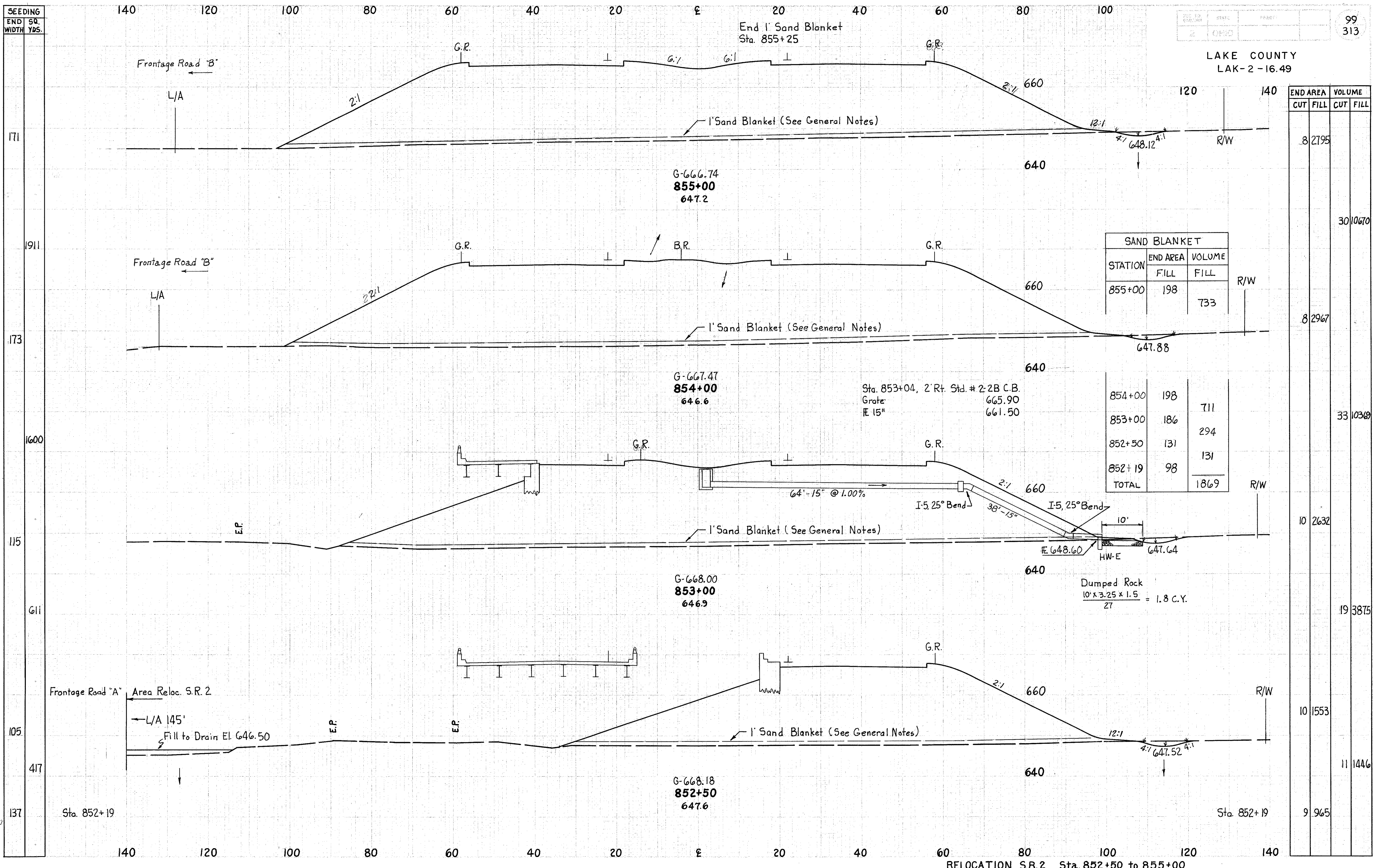

SAND BLANKET		
STATION	END AREA	VOLUME
855+00	198	733

854+00	198	711
853+00	186	294
852+50	131	131
852+19	98	131
<b>TOTAL</b>		<b>1869</b>

Dumped Rock  
 $\frac{10' \times 3.25 \times 1.5}{27} = 1.8 \text{ C.Y.}$

END AREA	VOLUME	
	CUT	FILL
8 2195		
		30 10670
8 2967		
		33 10369
10 2632		
		19 3875
10 1553		
		11 1446
9 965		

RELOCATION S.R. 2 Sta. 852+50 to 855+00

Fill to Drain  
 25x5 11/16/63  
 10' x 3.25 x 1.5  
 11/19/63  
 10' x 3.25 x 1.5  
 11/19/63  
 10' x 3.25 x 1.5  
 11/19/63  
 10' x 3.25 x 1.5  
 11/19/63