

SEEDING
END WIDTH SQ. YDS.

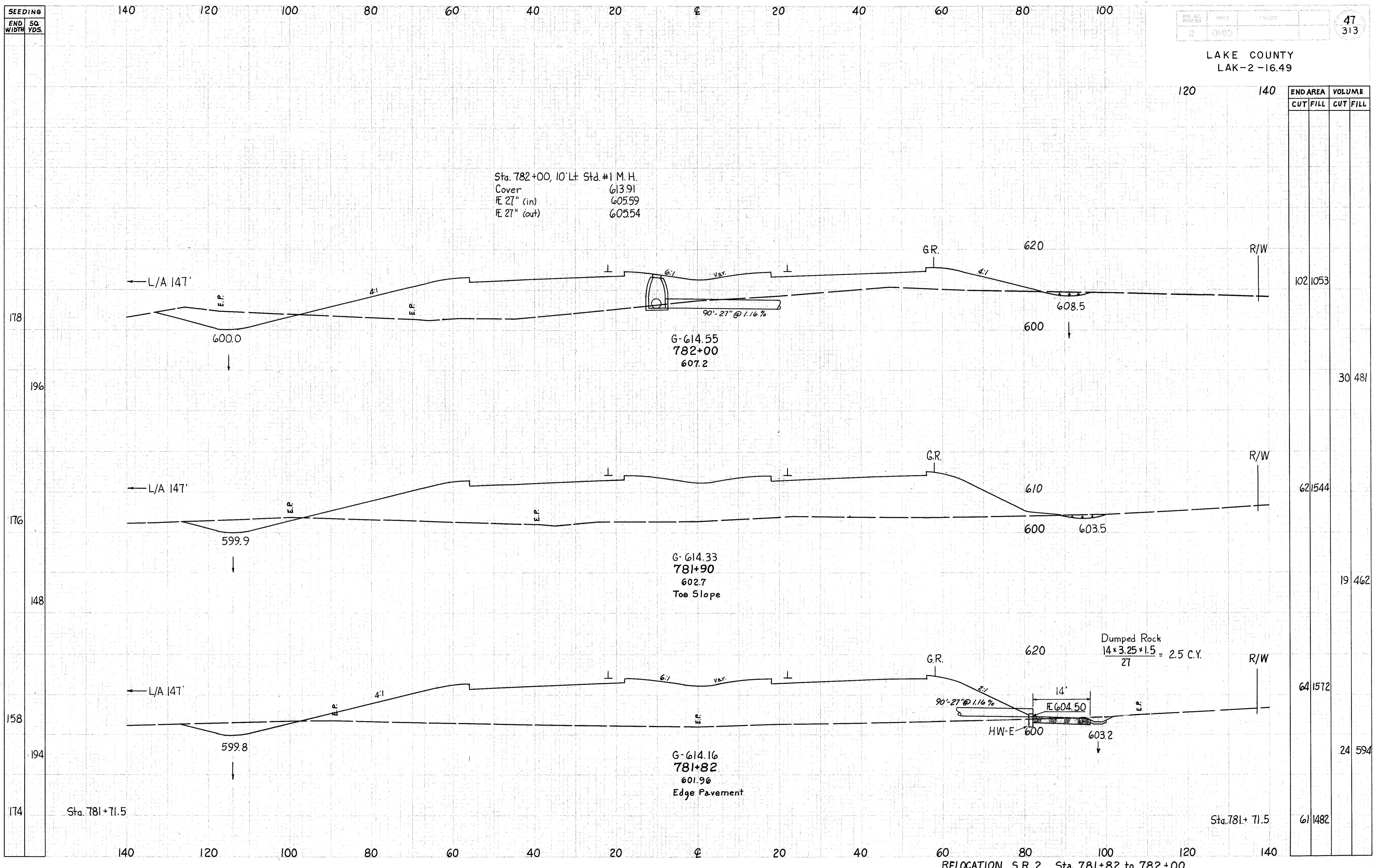

Sta. 782+00, 10' Lt. Std. #1 M.H.
Cover 613.91
E 27" (in) 605.59
E 27" (out) 605.54

G-614.55
782+00
607.2

G-614.33
781+90
602.7
Toe Slope

G-614.16
781+82
601.96
Edge Pavement

Dumped Rock
 $14 \times 3.25 \times 1.5 = 2.5 \text{ C.Y.}$
27

Sta. 781+71.5

Sta. 781+71.5

RELOCATION S.R. 2 Sta. 781+82 to 782+00

END AREA	VOLUME
CUT	FILL
102	1053
30	481
62	544
19	462
64	1572
24	594
61	1482

1/2" = 10' HORIZ.
1" = 10' VERT.
1/2" = 10' HORIZ.
1" = 10' VERT.
1/2" = 10' HORIZ.
1" = 10' VERT.