

LAKE COUNTY
LAK-2-16.49

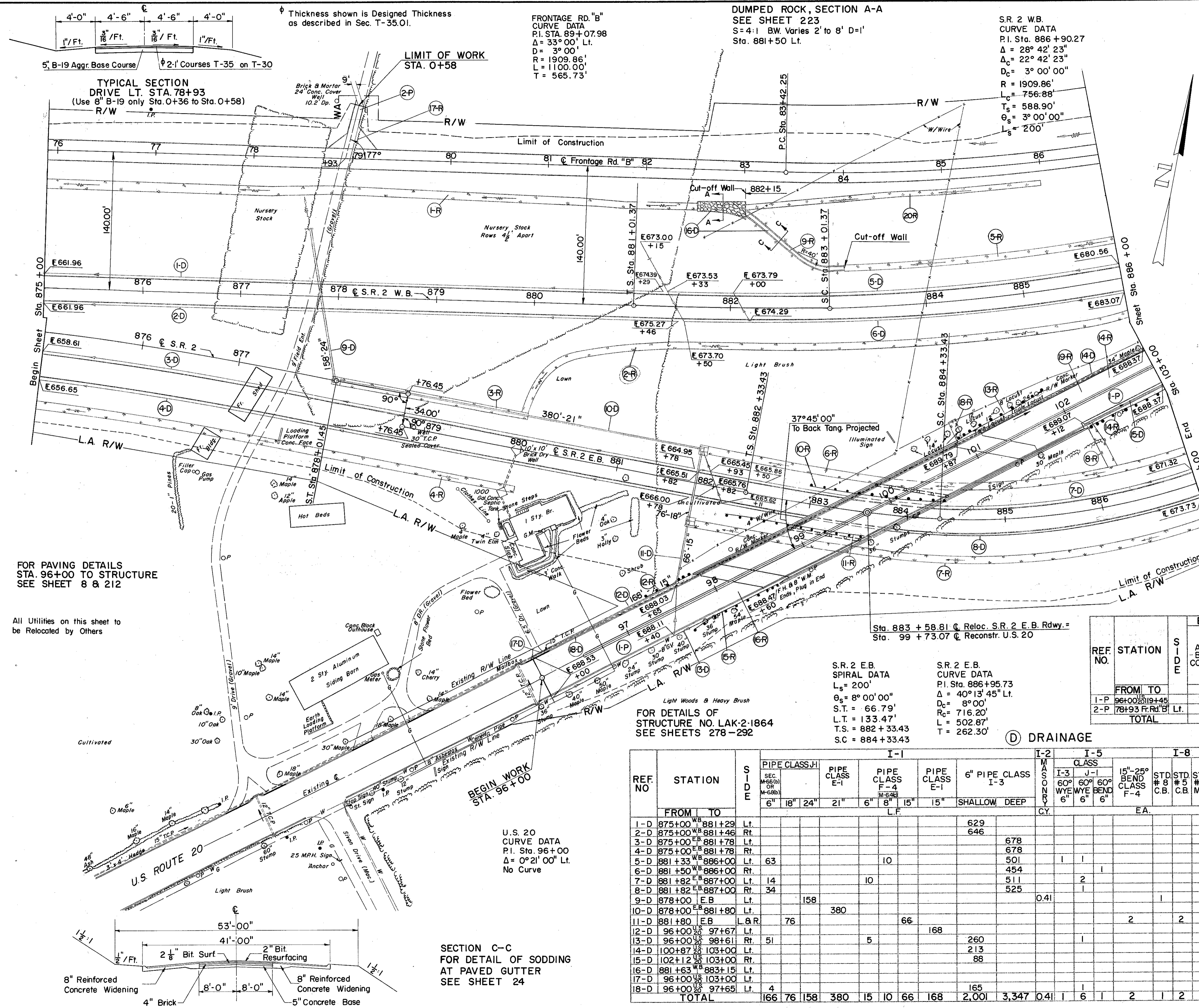

FRONTAGE RD. "B"

STATION	WIDTH OF SODDING FT.	LENGTH OF SODDING FT.	S.Y.
75+50	9.0	300	300
78+50	9.0	400	360
82+50	7.2		
SUB TOTAL			660
83+00	5.0	300	167
86+00	5.0		

E.B. RDWY. SODDING RIGHT DITCH

STATION	WIDTH OF SODDING FT.	LENGTH OF SODDING FT.	S.Y.
875+00	9.0	500	439
880+00	6.8		
881+88	7.3	512	416
887+00	7.3		

E.B. RDWY. SODDING LEFT DITCH

STATION	WIDTH OF SODDING FT.	LENGTH OF SODDING FT.	S.Y.
878+10	8.0	190	150
880+00	6.2		
881+88	7.3	512	416
887+00	7.3		

W.B. RDWY. SODDING RIGHT DITCH

STATION	WIDTH OF SODDING FT.	LENGTH OF SODDING FT.	S.Y.
880+00	7.3		
886+00	6.0	638	471

W.B. RDWY. SODDING LEFT DITCH

STATION	WIDTH OF SODDING FT.	LENGTH OF SODDING FT.	S.Y.
883+15	7.3	285	216
886+00	6.3		

(R) ROADWAY

REF. NO.	STATION	SIDE	E-1		E-8		I-15		L-10	
			COMPACT SUBGRADE	DISPOSAL OF EXISTING PAVEMENT	REMOVAL OF EXISTING PAVEMENT	DISPOSAL OF EXISTING PAVEMENT	GUARD RAIL BEAM TYPE (DEEP)	SODDING	SODDING FOR SPECIAL BERM & SLOPE PROTECT.	
			S.Y.	S.Y.	S.Y.	S.Y.	LF	S.Y.	S.Y.	
1-R	75+50	Rt.							660	
2-R	880+00	Rt.							471	
3-R	878+10	Lt.							150	
4-R	875+00	Rt.							439	
5-R	883+15	Lt.							216	
6-R	881+88	Lt.							416	
7-R	881+88	Rt.							416	
8-R	102+15	U.S. 20								47
9-R	882+13	U.S. 20								40
10-R	882+20	Lt.							137.50	
11-R	882+20	Rt.							137.5	
12-R	97+34	Lt.							50.0	
13-R	100+90	Lt.							100.0	
14-R	102+15	Rt.							362.5	
15-R	97+61	Rt.							100.0	
16-R	96+00	Lt.	14,018							
17-R	78+93	Rt.	72							
18-R	100+91	Lt.								17
19-R	96+00	Lt.		10,683						
20-R	83+00	Rt.							167	
TOTAL			14,090	10,683	887.5	2,975	64			

(P) PAVEMENT

REF. NO.	STATION	SIDE	AGGR. BASE COURSE	WATER-PROOFED AGGR. BASE COURSE	REINF. CONC. APR. SLABS T=13"	TYP. CONC. CURB		STAB. CRUSHED AGGR. BASE COURSE	PORT. CEMENT CONC. MEDIAN TYPE I	SUBBASE	BIT. NO. 6 MATL. AGGR.	T-31	T-71	T-30	T-35		
						2-A	6									S.Y.	C.Y.
1-P	96+00	Lt.		244	247	4,267	48	574	421	503	2,441	732	23	10,843	29	4	
2-P	78+93	Rt.		15	244	247	4,267	48	574	421	503	2,441	732	23	10,843	29	4
TOTAL				259	491	8,534	96	1,148	842	1,006	4,882	1,464	46	21,686	58	8	

S.R. 2 E.B. SPIRAL DATA
L_s = 200'
θ_s = 8° 00' 00"
S.T. = 66.79'
L.T. = 133.47'
T.S. = 882 + 33.43
S.C. = 884 + 33.43

S.R. 2 E.B. CURVE DATA
P.I. Sta. 886 + 95.73
Δ = 40° 13' 45" Lt.
D_c = 8° 00'
R_c = 716.20'
L.T. = 502.87'
T = 262.30'

(D) DRAINAGE

REF. NO.	STATION	SIDE	I-1		I-2		I-5		I-8		I-10		I-14		E-12	
			PIPE CLASS	PIPE CLASS	PIPE CLASS	PIPE CLASS	CLASS	CLASS	CLASS	CLASS	CLASS	CLASS	CLASS	CLASS	CLASS	CLASS
1-D	875+00	Lt.														
2-D	875+00	Rt.														
3-D	875+00	Lt.														
4-D	875+00	Rt.														
5-D	881+33	Lt.	63													
6-D	881+50	Rt.														
7-D	881+82	Lt.														
8-D	881+82	Rt.														
9-D	878+00	Lt.		158												
10-D	878+00	Rt.			380											
11-D	881+80	Lt.				66										
12-D	96+00	Lt.														
13-D	96+00	Rt.														
14-D	100+87	Lt.														
15-D	102+12	Rt.														
16-D	881+63	Lt.														
17-D	96+00	Lt.														
18-D	96+00	Rt.														
TOTAL			166	76	158	380	15	10	66	168	2,001	3,347	0.41	6	1	432

RECONSTRUCTION U.S. 20

EXCAVATION	=	100,274 C.Y.
EMBANKMENT	=	6,909 C.Y.
EMBANKMENT + 20%	=	8,291 C.Y.

FRONTAGE ROAD "B"

EXCAVATION	=	5,965 C.Y.
EMBANKMENT	=	4,128 C.Y.
EMBANKMENT + 20%	=	4,954 C.Y.

EXCAVATION	=	4,279 C.Y.
EMBANKMENT	=	6,565 C.Y.
EMBANKMENT + 20%	=	7,878 C.Y.

FOR PAVING DETAILS
STA. 96+00 TO STRUCTURE
SEE SHEET 8 & 212

All Utilities on this sheet to
be Relocated by Others

FOR DETAILS OF
STRUCTURE NO. LAK-2-1864
SEE SHEETS 278-292

U.S. 20
CURVE DATA
P.I. Sta. 96+00
Δ = 0° 21' 00" Lt.
No Curve

SECTION C-C
FOR DETAIL OF SODDING
AT PAVED GUTTER
SEE SHEET 24

TYPICAL SECTION EXISTING ROUTE U.S. 20