

FOR DETAILS OF
F.P. & E. RR. TEMPORARY RUNAROUND
SEE SHEETS 159 & 160

FOR DETAILS OF
STRUCTURE NO. LAK-2-1721
SEE SHEETS 245 - 254

DUMPED ROCK, SECTION A-A
SEE SHEET 223
S=2:1 B.W.=3' D=1'
Sta. 813+50 Lt.
Sta. 814+30 Rt.

FOR DETAILS OF
STRUCTURE NO. LAK-2-1731
SEE SHEETS 255 - 260

FOR PROFILE AT RED CREEK
CHANNEL CHANGE
SEE SHEET 166

FOR ADDITIONAL
UDRAIN
QUANTITIES
SEE SHEETS
176 & 177

LAKE COUNTY
LAK-2-16.49

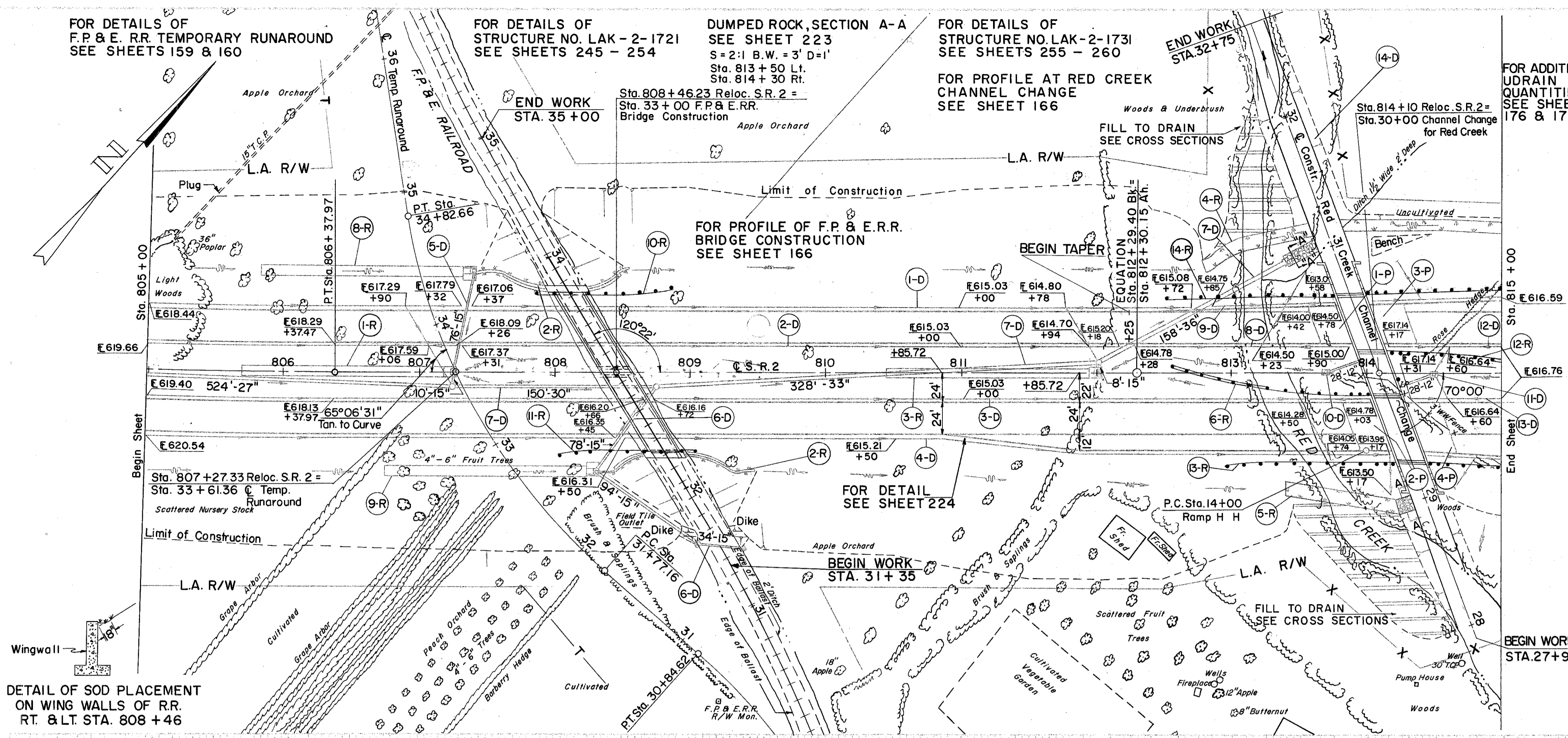

DETAIL OF SOD PLACEMENT
ON WING WALLS OF RR.
RT. & LT. STA. 808+46

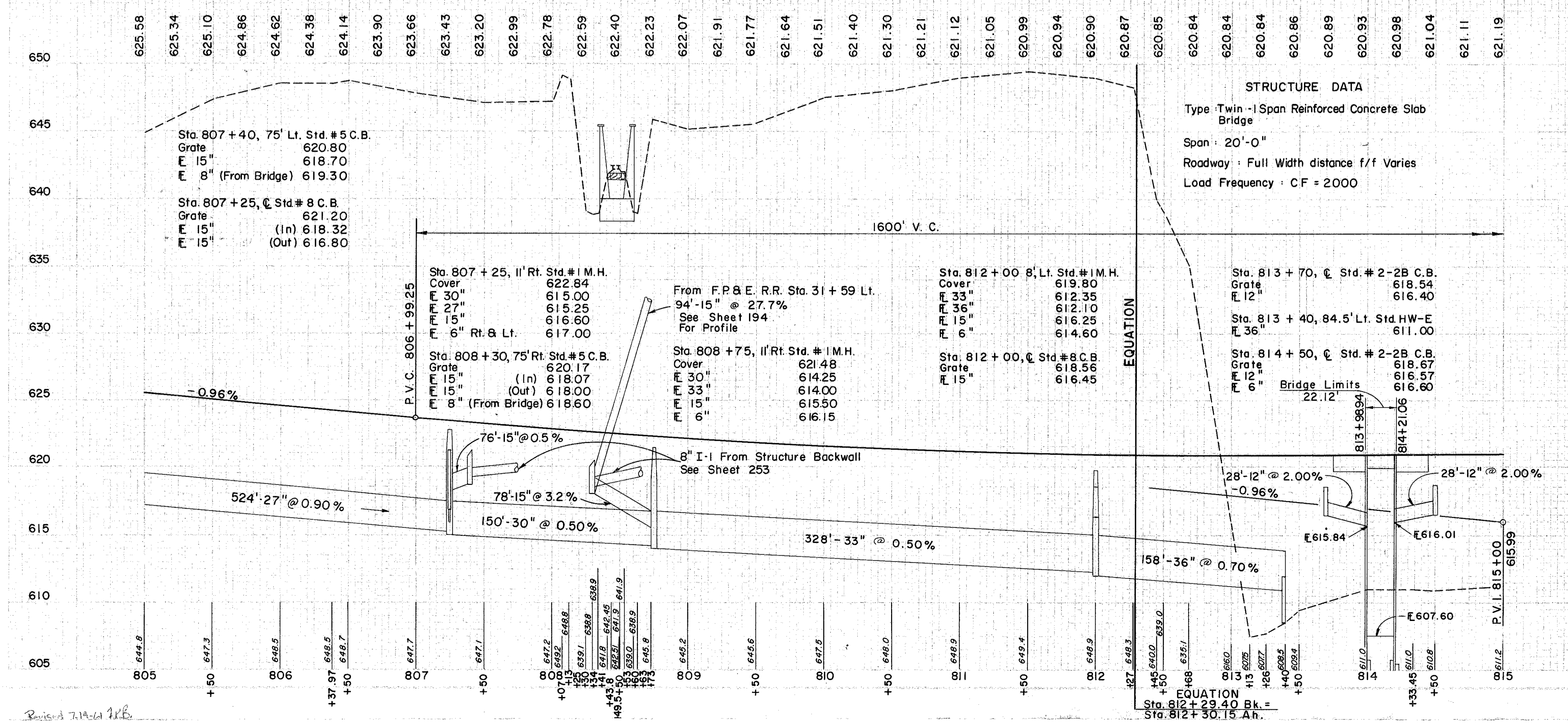

Revised 7/14/14 HKB

(D) DRAINAGE

REF. NO.	STATION	PIPE CLASS		PIPE CLASS	6" PIPE CLASS		CY
		J-1	J-1		I-3	I-3	
1-D	807+37	15"	36"	E-4	15"	33"	1
2-D	807+31	15"	36"	E-4	15"	33"	1
3-D	808+72	15"	36"	E-4	15"	33"	1
4-D	808+50	15"	36"	E-4	15"	33"	1
5-D	807+25	15"	36"	E-4	15"	33"	1
6-D	808+30	15"	36"	E-4	15"	33"	1
7-D	807+25	15"	36"	E-4	15"	33"	1
8-D	812+85	15"	36"	E-4	15"	33"	1
9-D	813+70	15"	36"	E-4	15"	33"	1
10-D	814+50	15"	36"	E-4	15"	33"	1
11-D	814+50	15"	36"	E-4	15"	33"	1
12-D	814+50	15"	36"	E-4	15"	33"	1
13-D	814+50	15"	36"	E-4	15"	33"	1
14-D	815+00	15"	36"	E-4	15"	33"	1
TOTAL		143	154	158	34	18	150
TOTAL		143	154	158	34	18	150

F.P. & E. RAILROAD

EXCAVATION	=	2,933 C.Y.
EMBANKMENT	=	30 C.Y.
EMBANKMENT +20%	=	36 C.Y.

(P) PAVEMENT

REF. NO.	STATION	PAVEMENT		CY
		FROM	TO	
1-P	805+00	805+00	805+00	1
2-P	807+25	807+25	807+25	1
3-P	808+30	808+30	808+30	1
4-P	812+85	812+85	812+85	1
TOTAL				360

(R) ROADWAY

REF. NO.	STATION	ROADWAY		CY
		FROM	TO	
1-R	805+00	805+00	805+00	1
2-R	807+25	807+25	807+25	1
3-R	808+30	808+30	808+30	1
4-R	812+85	812+85	812+85	1
TOTAL				360

(S) SODDING

REF. NO.	STATION	SODDING		CY
		FROM	TO	
1-S	805+00	805+00	805+00	1
2-S	807+25	807+25	807+25	1
3-S	808+30	808+30	808+30	1
4-S	812+85	812+85	812+85	1
TOTAL				360

(T) TRENCH

REF. NO.	STATION	TRENCH		CY
		FROM	TO	
1-T	805+00	805+00	805+00	1
2-T	807+25	807+25	807+25	1
3-T	808+30	808+30	808+30	1
4-T	812+85	812+85	812+85	1
TOTAL				360

* Includes embankment shown on Red Creek Channel Change cross sections

STA. 805+00 TO STA. 815+00