

SOIL PROFILE
LAKE COUNTY
LAK-2-14.22
 OHIO STATE HIGHWAY
 TESTING LABORATORY
 O. S. U. CAMPUS, COLUMBUS, OHIO

3
5

Revised July 30, 1959

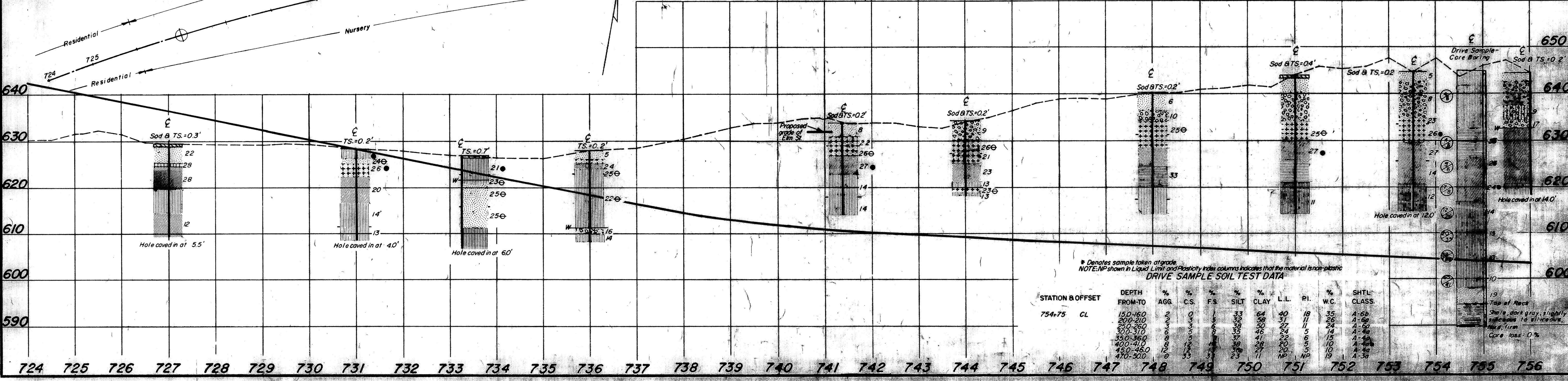
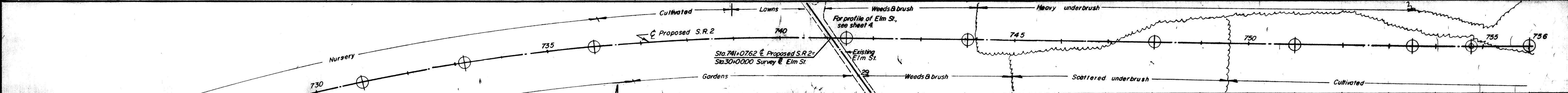
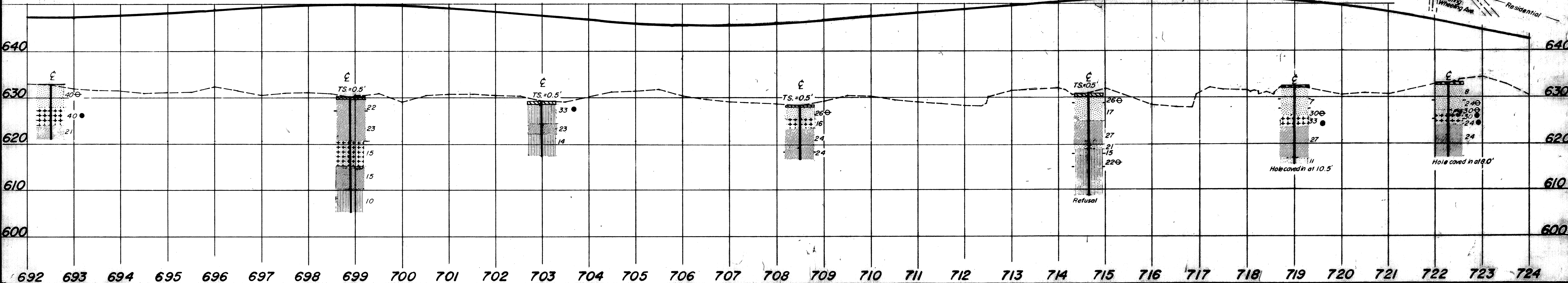
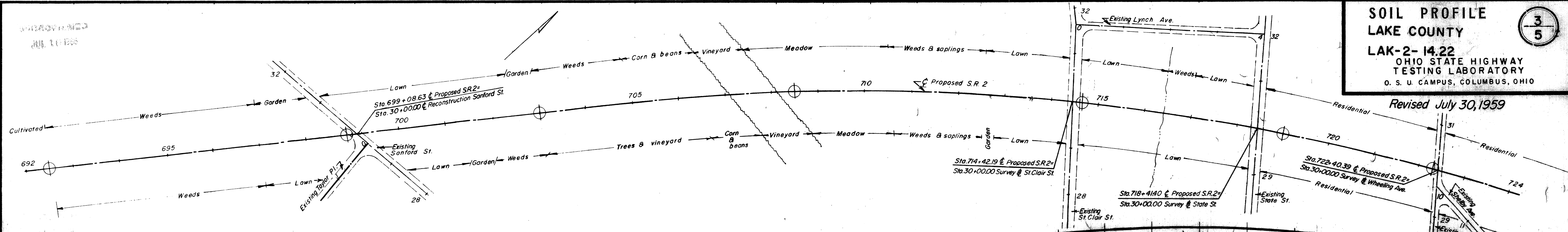

* Denotes sample taken at grade
 NOTE: NP shown in Liquid Limit and Plasticity Index columns indicates that the material is non-plastic

DRIVE SAMPLE SOIL TEST DATA

STATION & OFFSET	DEPTH FROM-TO	% AGG	% C.S.	% F.S.	% SILT	% CLAY	L.L.	P.I.	% W.C.	SHTL CLASS
754-75 CL	150-160	100	0	0	33	64	40	19	35	A-6p
	200-210	100	0	0	33	64	40	19	35	A-6p
	250-260	100	0	0	33	64	40	19	35	A-6p
	300-310	100	0	0	33	64	40	19	35	A-6p
	350-360	100	0	0	33	64	40	19	35	A-6p
	400-410	100	0	0	33	64	40	19	35	A-6p
	450-460	100	0	0	33	64	40	19	35	A-6p
470-500	100	0	0	33	64	40	19	35	A-6p	

Top of Road
 Shale, dark gray, slightly silty, 14' at grade,
 1/2" firm
 Core loss - 0%