

MICROFILMED
JUL 9 1986

FED. RD. DIVISION	STATE	PROJECT
2	OHIO	

309
384

LAKE COUNTY
SEC. LAK-2-14.22

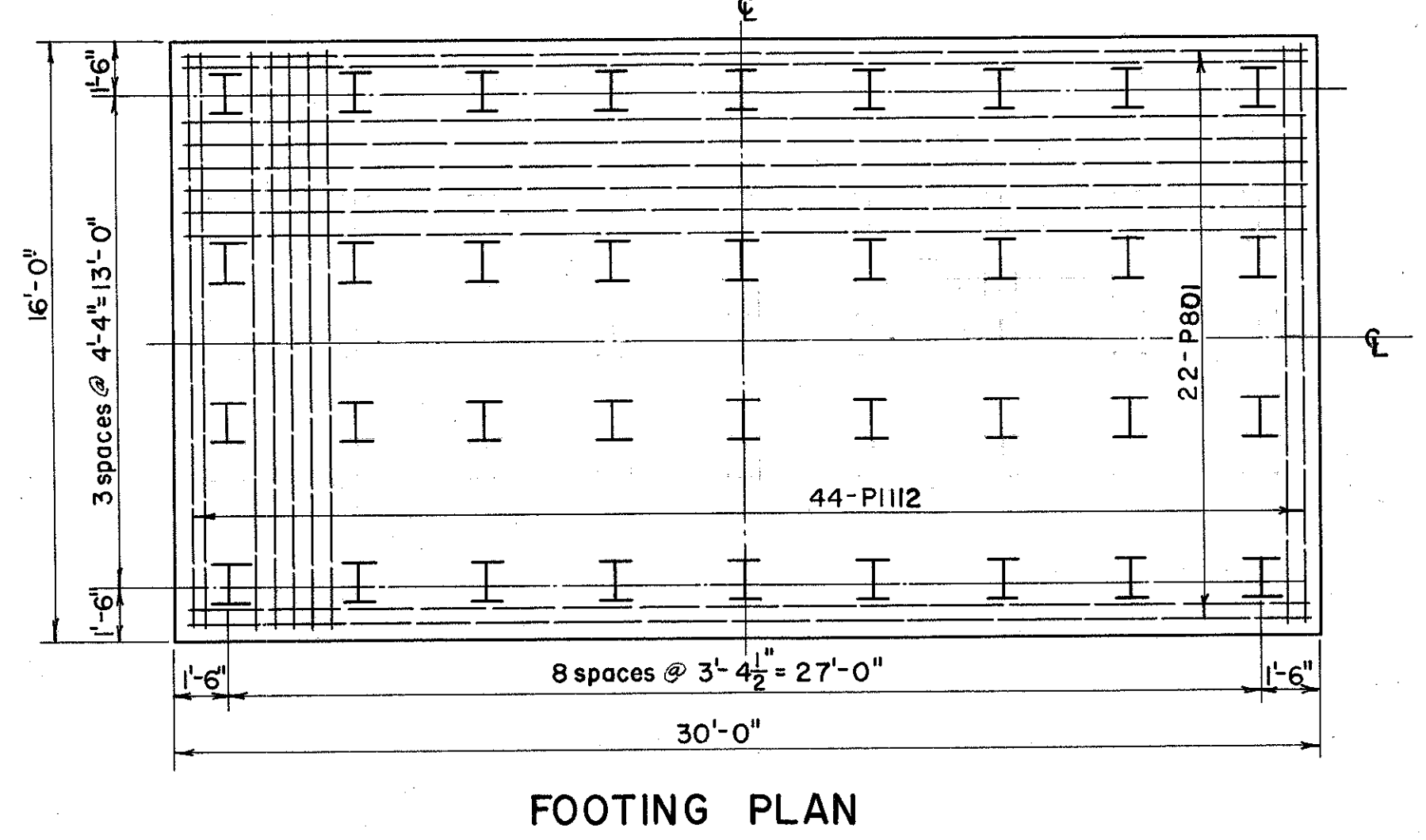
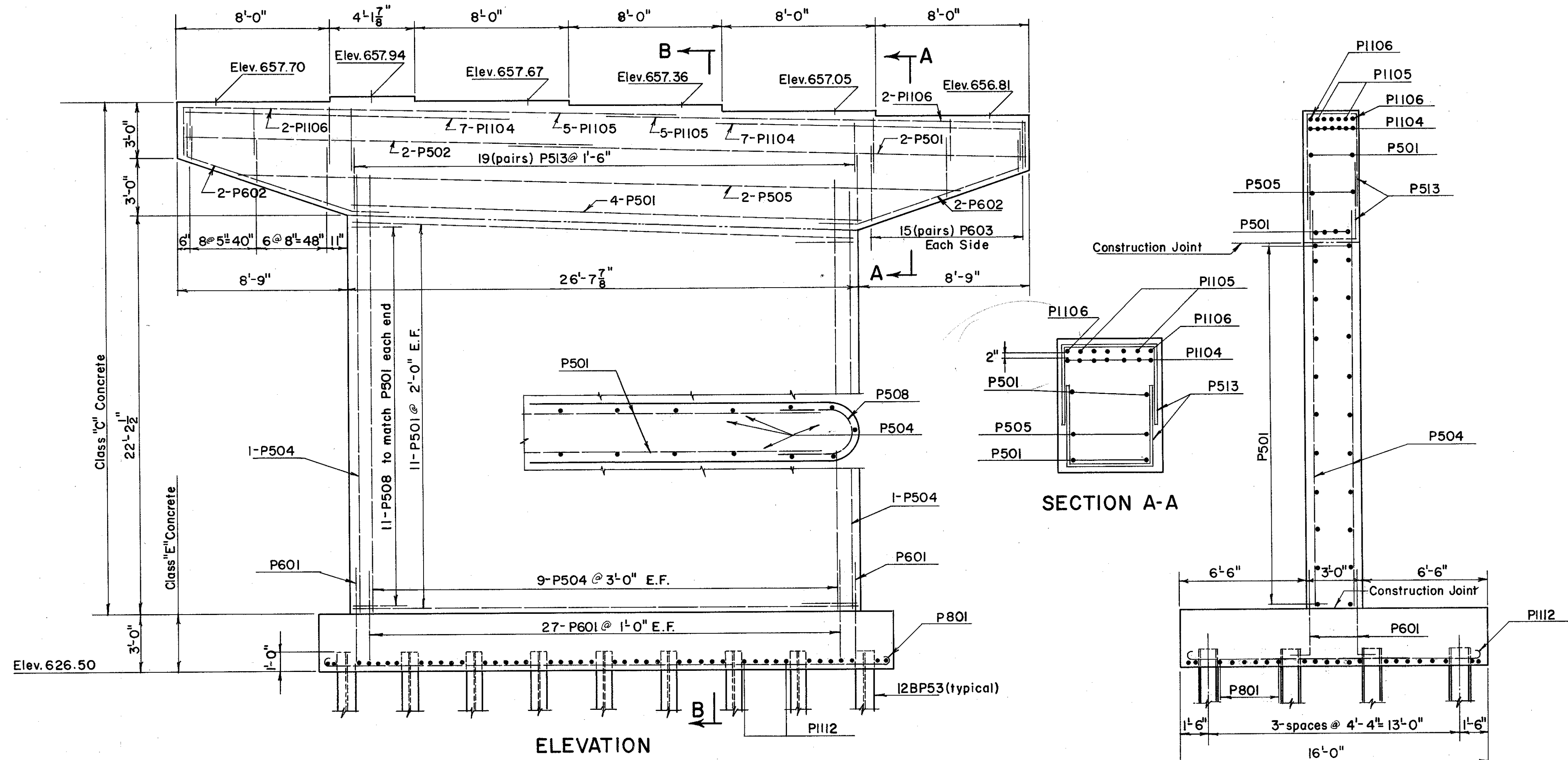
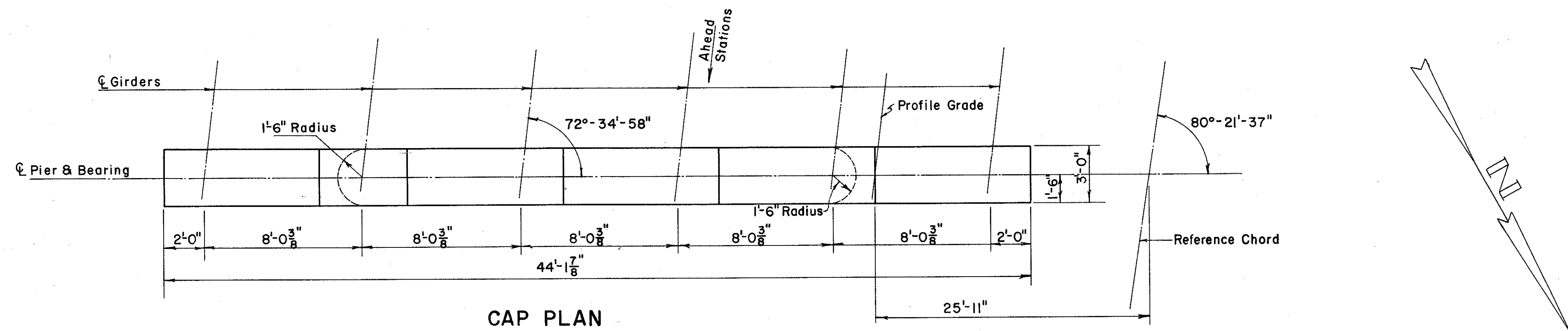

For notes and footing layout see drawing Pier #1 Left Bridge

PREPARED BY CAPITOL ENGINEERING ASSOCIATES, DILLSBURG, PA. FOR					
STATE OF OHIO DEPARTMENT OF HIGHWAYS DIVISION OF DESIGN AND CONSTRUCTION BUREAU OF BRIDGES					
PIER #1 RIGHT BRIDGE BRIDGE NO. LAK-2-1471 L&R RELOC. S.R. 2 OVER B.&O. R.R. - S.R. 283 LAKE COUNTY					
STA. 680 + 56.97					
DESIGNED H.C.M.	DRAWN M.C.P.	TRACED R.L.K.	CHECKED M.C.P.	REVIEWED DATE D.R.T.	REVISED