

LAKE COUNTY
LAK-2-14.22

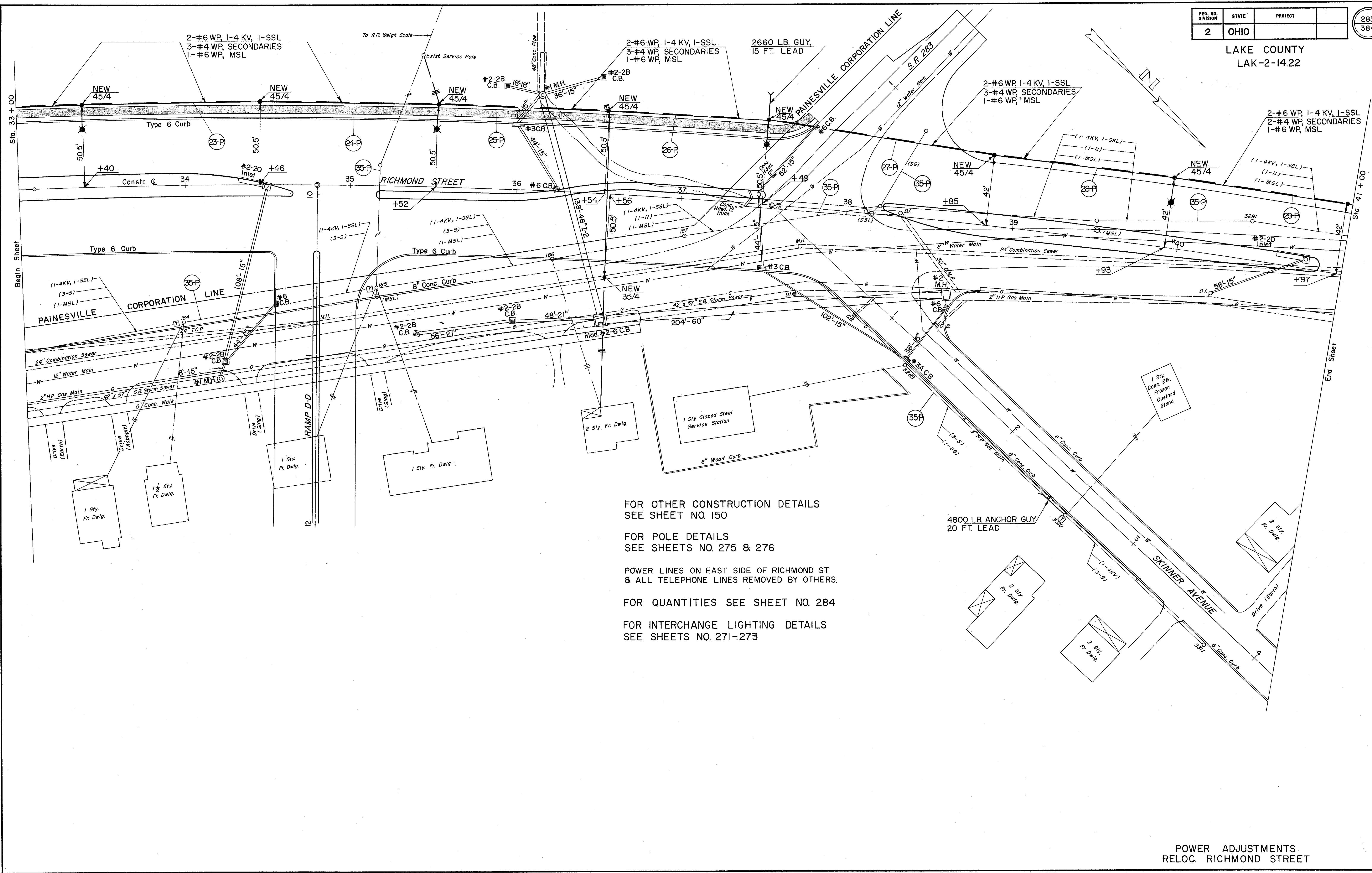

FOR OTHER CONSTRUCTION DETAILS
SEE SHEET NO. 150

FOR POLE DETAILS
SEE SHEETS NO. 275 & 276

POWER LINES ON EAST SIDE OF RICHMOND ST
& ALL TELEPHONE LINES REMOVED BY OTHERS.

FOR QUANTITIES SEE SHEET NO. 284

FOR INTERCHANGE LIGHTING DETAILS
SEE SHEETS NO. 271-273

POWER ADJUSTMENTS
RELOC. RICHMOND STREET