

Scale: 1" = 10'

AREA = 0.51 ACRES  
Q<sub>10</sub> = 1.30 C.F.S.

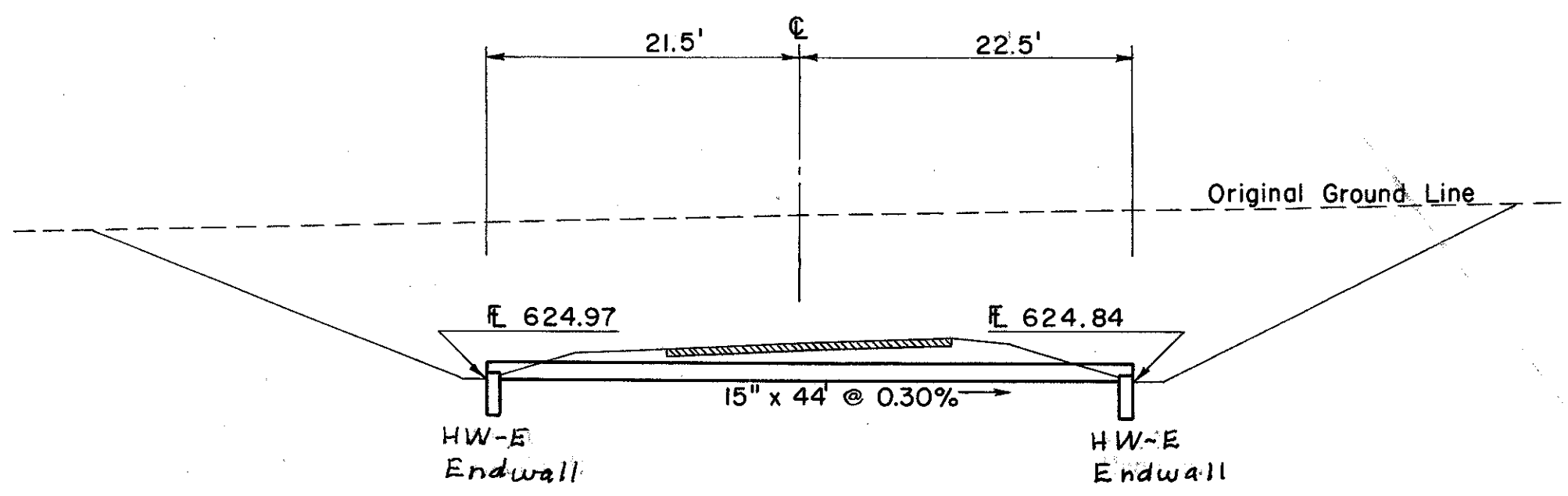

**CULVERT DATA**  
 TYPE: Pipe Culvert, Sec. M-6.4(d)  
 SIZE: 15" x 44"  
 WORK REQUIRED: Build 15" Pipe Culvert with HW-E Endwalls Lt. & Rt. Place 18" Sodding behind Endwalls

**ESTIMATED QUANTITIES**  
 E-2 Excavation for Structures 115 C.Y.  
 I-2 Masonry (Headwall) 0.52 C.Y.  
 I-17 15" Pipe Class C-1 Sec. M-6.4(d) 44 L.F.  
 L-10 Sodding 4 S.Y.

PIPE CULVERT STA. 12 + 23  
ACCESS ROAD CONNECTOR

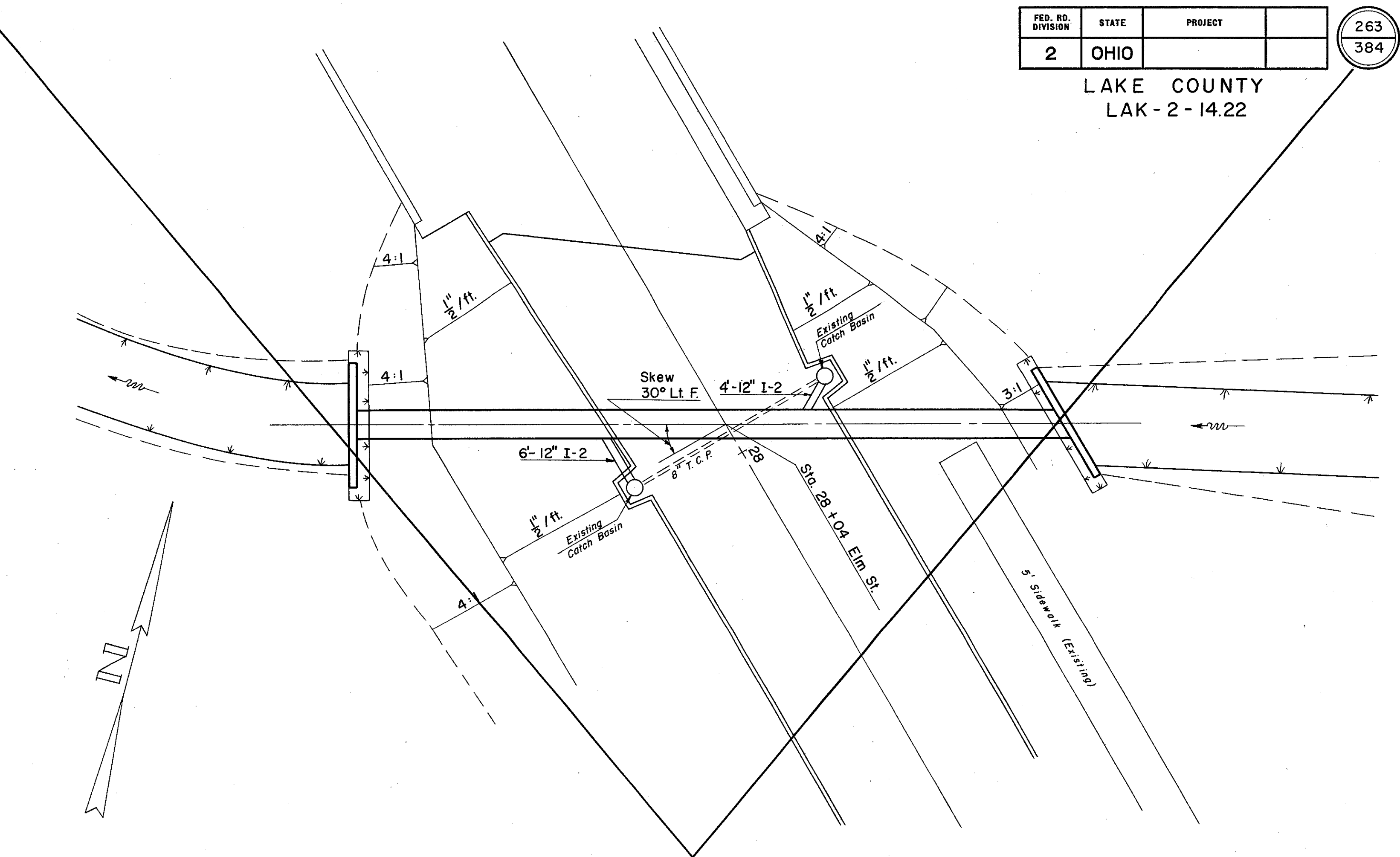

Scale: 1" = 10'

AREA = 31 ACRES  
Q<sub>25</sub> = 44 C.F.S.

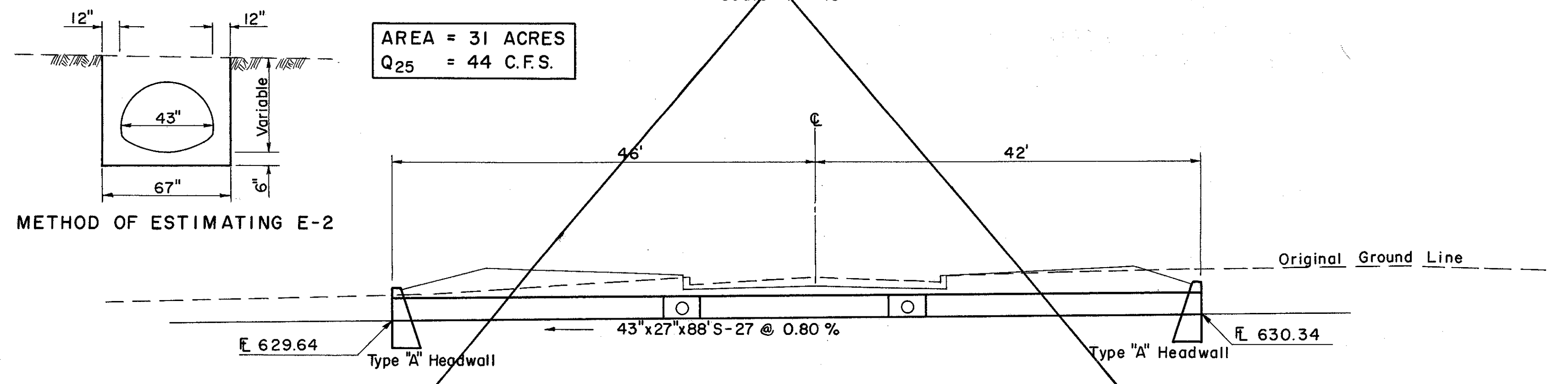

**CULVERT DATA**  
 TYPE: Pipe Arch, S-27, Sec. M-6.4(i) & (d) with Std. Type "A" Headwalls  
 SIZE: 43" x 27" x 88"  
 WORK REQUIRED: Build a 43" x 27" Pipe Arch with Type "A" Headwalls Rt. & Lt. Place 18" Sodding around Headwalls.

**ESTIMATED QUANTITIES**  
 E-2 Excavation for Structures 115 C.Y.  
 S-1 Concrete for Structures, Class "C" 14.6 C.Y.  
 S-27 43" x 27" Pipe for Roadway Culverts 88 L.F. Sec. M-6.4(i) & (d)  
 S-4 Reinforcing Steel 572 Lbs.  
 L-10 Sodding 7 S.Y.

PIPE CULVERT STA. 28+04 ELM ST.