

LAKE COUNTY  
LAK-2-14.22

SECTION A-A THROUGH DUMPED  
ROCK LT. STA. 13+70 & STA. 17+25  
RAMP D-D. SEE SHEET NO. 30

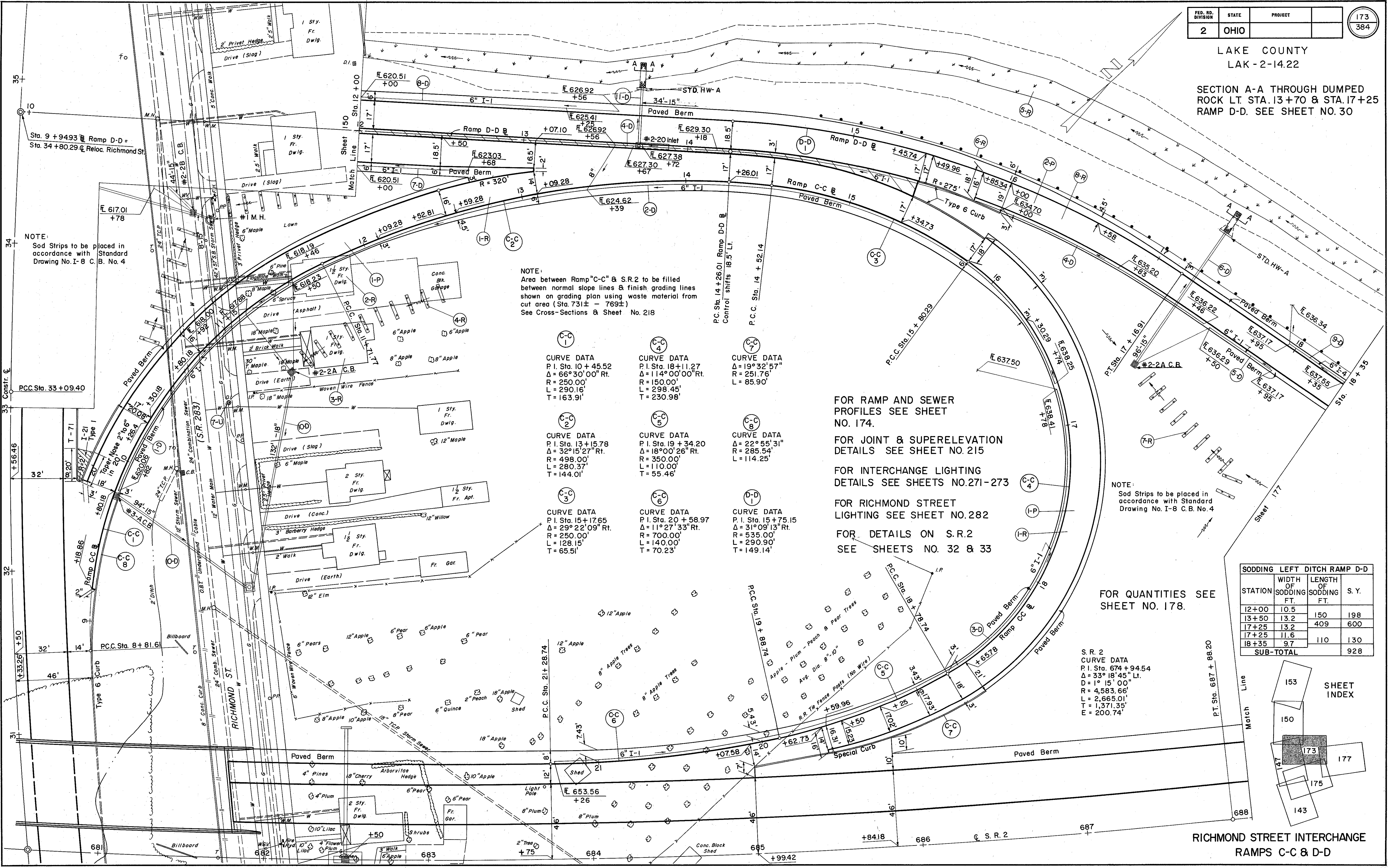

- NOTE:  
Area between Ramp "C-C" & S.R.2 to be filled between normal slope lines & finish grading lines shown on grading plan using waste material from cut area (Sta. 73± - 769±)  
See Cross-Sections & Sheet No. 218
- C-C 1 CURVE DATA  
P.I. Sta. 10 + 45.52  
Δ = 66° 30' 00" Rt.  
R = 250.00'  
L = 290.16'  
T = 163.91'
  - C-C 2 CURVE DATA  
P.I. Sta. 13 + 15.78  
Δ = 32° 15' 27" Rt.  
R = 498.00'  
L = 280.37'  
T = 144.01'
  - C-C 3 CURVE DATA  
P.I. Sta. 15 + 17.65  
Δ = 29° 22' 09" Rt.  
R = 250.00'  
L = 128.15'  
T = 65.51'
  - C-C 4 CURVE DATA  
P.I. Sta. 18 + 11.27  
Δ = 114° 00' 00" Rt.  
R = 150.00'  
L = 298.45'  
T = 230.98'
  - C-C 5 CURVE DATA  
P.I. Sta. 19 + 34.20  
Δ = 18° 00' 26" Rt.  
R = 350.00'  
L = 110.00'  
T = 55.46'
  - C-C 6 CURVE DATA  
P.I. Sta. 20 + 58.97  
Δ = 11° 27' 33" Rt.  
R = 700.00'  
L = 140.00'  
T = 70.23'
  - C-C 7 CURVE DATA  
P.I. Sta. 15 + 75.15  
Δ = 31° 09' 13" Rt.  
R = 535.00'  
L = 290.90'  
T = 149.14'
  - C-C 8 CURVE DATA  
P.I. Sta. 15 + 75.15  
Δ = 22° 55' 31"  
R = 285.54'  
L = 114.25'

STATION	WIDTH OF SODDING FT.	LENGTH OF SODDING FT.	S. Y.
12+00	10.5		198
13+50	13.2	150	600
17+25	13.2	409	
17+25	11.6		130
18+35	9.7	110	
SUB-TOTAL			928

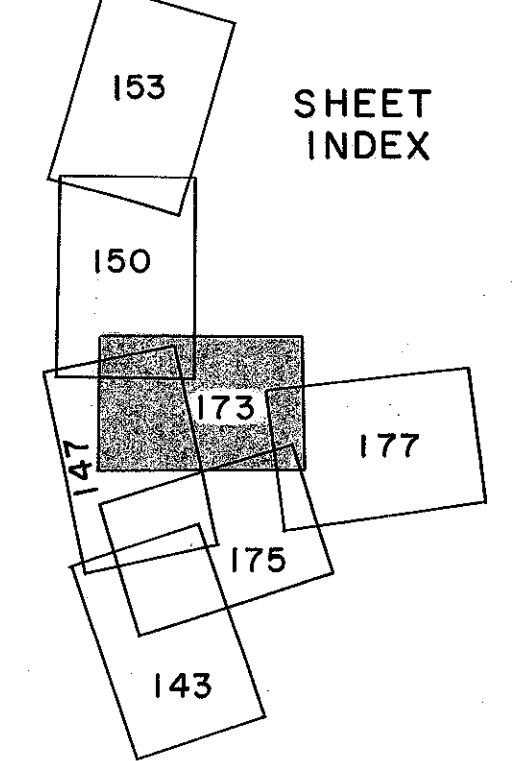

RICHMOND STREET INTERCHANGE  
RAMPS C-C & D-D