

FOR CULVERT DETAILS  
SEE SHEET NO. 262

SECTION A-A THROUGH DUMPED ROCK  
LT. STA. 2+60 SEE SHEET NO. 120

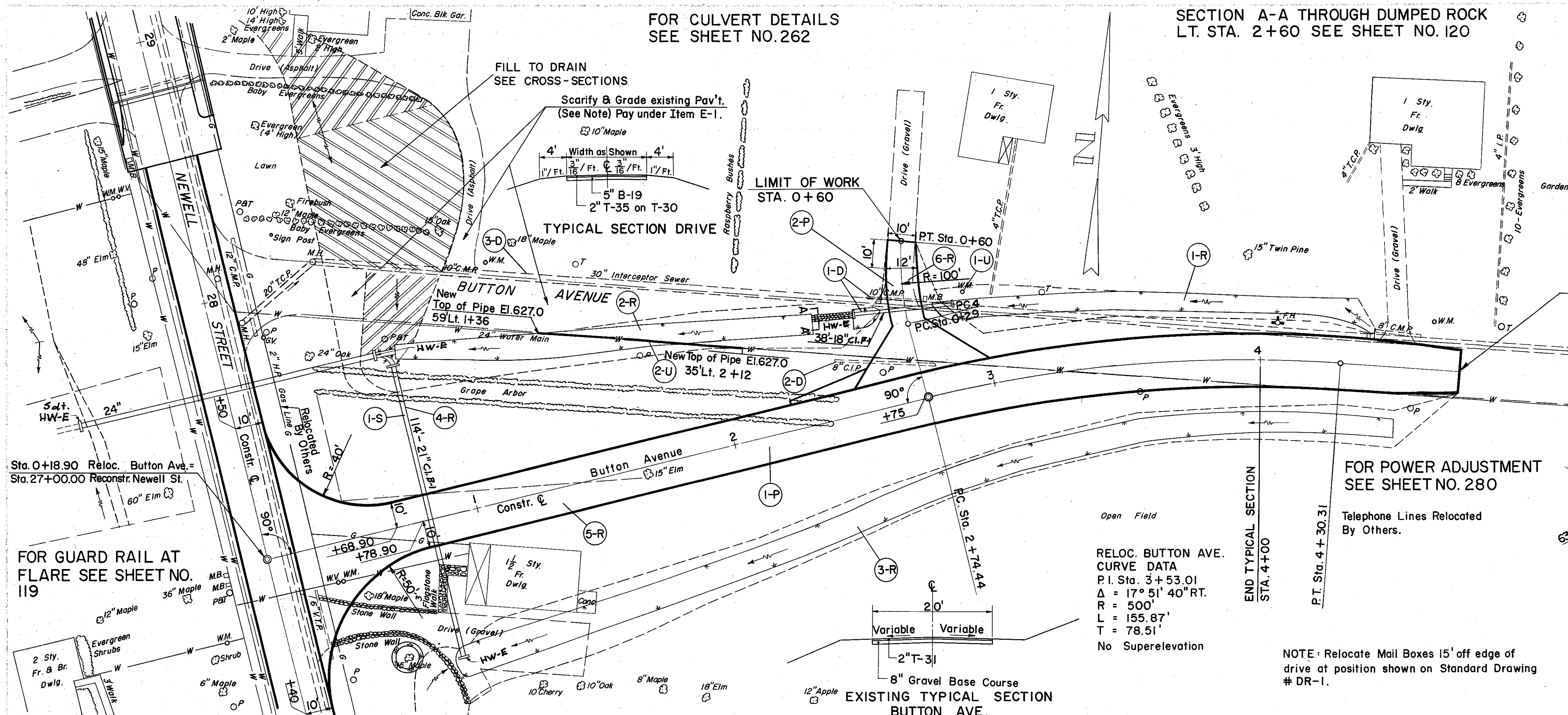

Sta. 4+50 to Sta. 4+75  
Transition Pavt. to meet Existing Pavt. Taper Full Width  
Shoulders as shown on Typical Section to meet  
Existing Earth Shoulders, Rt.

Sta. 4+50 Lt.  
Clean out Existing Outlet from Drive Pipe to Drain  
to New Ditch. Adjust Drive to meet New Pavt.

Sta. 4+00 to Sta. 4+75 Lt.  
Transition Shoulders as shown  
on Cross-Sections.

LIMIT OF WORK  
STA. 4+75

INTERSECTION DETAILS  
BUTTON AVE. & NEWELL ST.

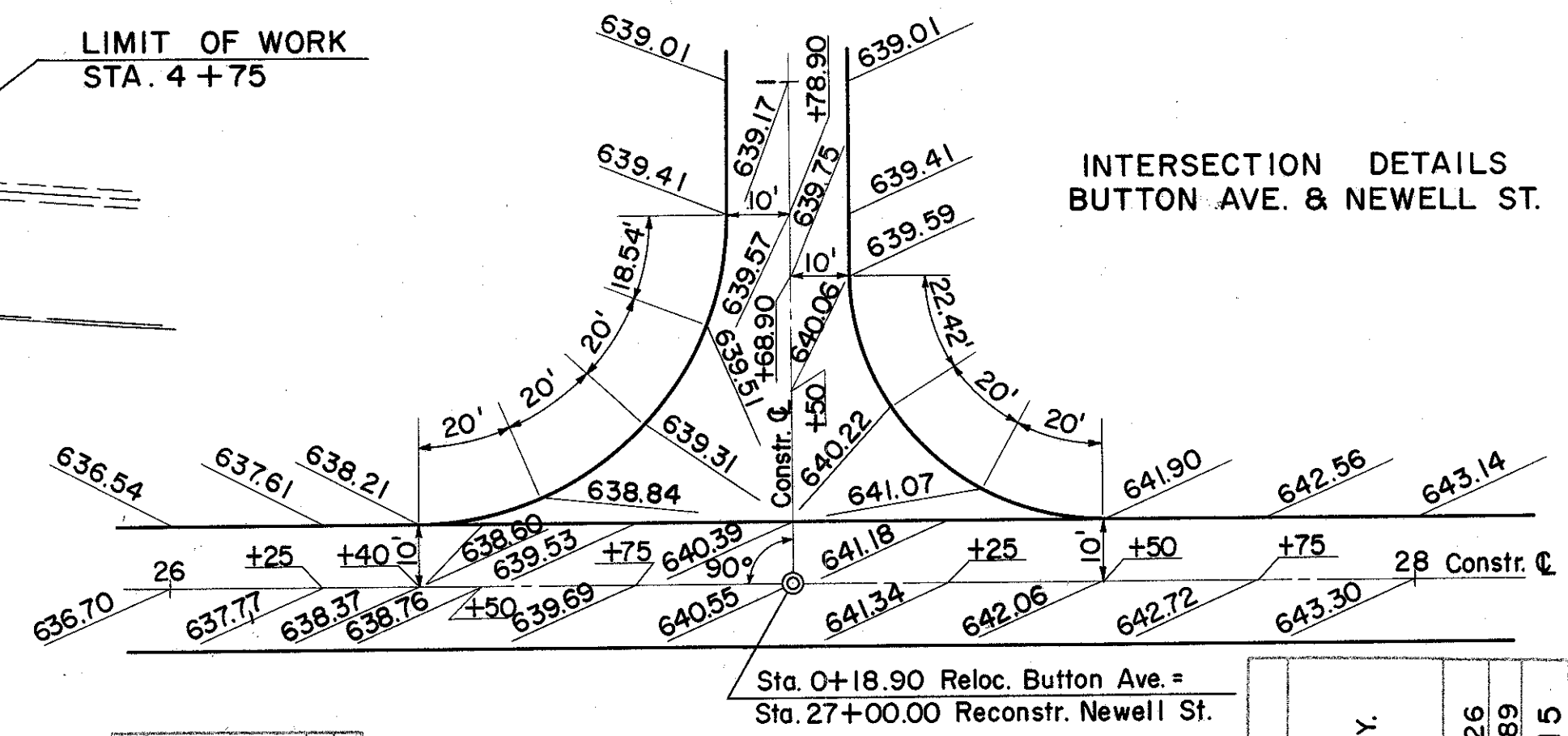

RELOC. BUTTON AVE.  
CURVE DATA  
P.I. Sta. 3+53.01  
 $\Delta = 17^\circ 51' 40''$  RT.  
R = 500'  
L = 155.87'  
T = 78.51'  
No Superelevation

FOR POWER ADJUSTMENT  
SEE SHEET NO. 280

Telephone Lines Relocated  
By Others.

END TYPICAL SECTION  
STA. 4+00

NOTE: Relocate Mail Boxes 15' off edge of  
drive at position shown on Standard Drawing  
# DR-1.

FOR GUARD RAIL AT  
FLARE SEE SHEET NO.  
119

Sta. 0+18.90 Reloc. Button Ave. =  
Sta. 27+00.00 Reconstr. Newell St.

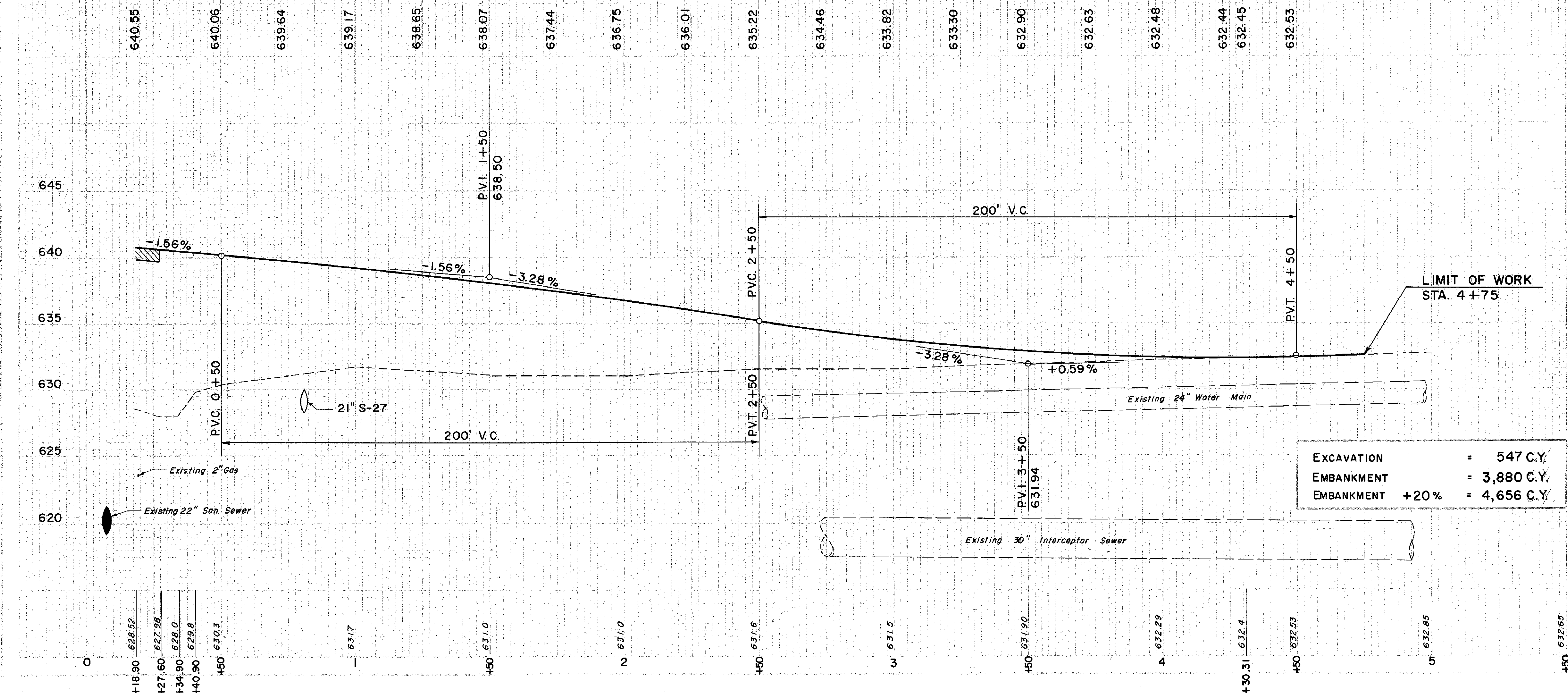

(S) STRUCTURES

REF. NO.	STATION	TYPE	LENGTH	WIDTH	OF SODDING	STATION	LENGTH	OF SODDING	S.Y.
I-1	0+82	21" Pipe Class B-1	11.4	1.6	8.0	0+79	11.6	272	326
I-2	1+36	Masonry Headwall	0.72	1.6	10.0	3+50	10.0	95	89
I-14	2+12	MODIFIED PAVED GUTTER	1.6	1.6	8.0	4+50	6.8	134	134
SUB-TOTAL									415

(U) UTILITIES

REF. NO.	STATION	DESCRIPTION	LENGTH	WIDTH	OF SODDING	STATION	LENGTH	OF SODDING	S.Y.
I-124.10	1+36	WATER Meters	10.2	1.6	8.0	2+87	7.2	68	57
I-124.11	2+12	BOXES TO REMOVED & RESET	10.2	1.6	8.0	3+50	8.0	63	49
I-124.12	3+20	GRADE	10.2	1.6	8.0	4+09	6.0	25	22
I-124.13	4+12	MAIN	10.2	1.6	8.0	4+34	3.0	8	6
SUB-TOTAL									134

(D) DRAINAGE

REF. NO.	STATION	DESCRIPTION	LENGTH	WIDTH	OF SODDING	STATION	LENGTH	OF SODDING	S.Y.
E-12	2+12	PIPE REMOVED UNDER	15	1.6	8.0	0+65	5.8	15	10
I-10	3+20	DUMPED ROCK CHANNEL PROTECT.	38	2.9	8.0	0+80	8.8	168	157
I-1	4+12	PIPE 18" Class F-1	38	2.9	8.0	2+62	8.0	167	167
TOTAL									4029

(R) ROADWAY

REF. NO.	STATION	DESCRIPTION	LENGTH	WIDTH	OF SODDING	STATION	LENGTH	OF SODDING	S.Y.
E-1	2+12	COMP. SUB-GRADE	11.7	1.6	8.0	0+79	11.6	272	326
L-9	3+20	STONE UNDER DRAINS	220	2.9	8.0	3+50	10.0	95	89
L-10	4+12	COMMER. CIAL FERTILIZER	723	2.9	8.0	4+50	6.8	134	134
TOTAL									4029

(P) PAVEMENT

REF. NO.	STATION	DESCRIPTION	LENGTH	WIDTH	OF SODDING	STATION	LENGTH	OF SODDING	S.Y.
B-19	2+12	AGGR. BASE COURSE	16	1.6	8.0	0+79	11.6	272	326
T-30	3+20	BIT. PRIME COAT	48	1.6	8.0	3+50	10.0	95	89
T-35	4+12	ASPH. CONC. SURF. COURSE	67	1.6	8.0	4+50	6.8	134	134
TOTAL									483

RELOC. BUTTON AVE. STA. 0+18.90 TO STA. 4+75