

**REFERENCE MONUMENTS & BENCHMARKS**

NUMBER	NORTHING	EASTING	ELEVATION	STATION	OFFSET
N/A	N/A	N/A	N/A	N/A	N/A
N/A	N/A	N/A	N/A	N/A	N/A

DESCRIPTION: N/A

- NOTES:
- EARTHWORK LIMITS SHOWN ARE APPROXIMATE. ACTUAL SLOPES SHALL CONFIRM TO PLAN CROSS SECTIONS.
  - ALL DIMENSIONS ARE MM UNLESS OTHERWISE NOTED.

**DRAINAGE INFORMATION**

DRAINAGE AREA = 9.9 km<sup>2</sup>

<b>50 YEAR</b> Q = 30.0 m <sup>3</sup> /s V = 1.64 m/s H.W.E.L. = 192.37	<b>100 YEAR</b> Q = 33.3 m <sup>3</sup> /s V = 1.58 m/s H.W.E.L. = 192.64
---	--

MIN. BOTTOM OF SUPERSTRUCTURE EL = 194.005 AT STA. 10+011.45 (RIGHT BRIDGE, BEAM 9)

MINIMUM CLEARANCE = 1635 FOR 50 YEAR FLOOD

**EXISTING STRUCTURE**

TYPE: DUAL- 3 SPAN CONTINUOUS REINFORCED CONCRETE SLAB & PILE BENTS

SPANS: 6706 (22'-0"), 7925 (26'-0"), & 6706 (22'-0"), C/C BEARING

ROADWAY: TWO @ 12 802 (42'-0") F/F PARAPET

LOADING FREQUENCY: CF-2000

STRUCTURE FILE NO. 4300904 & 4300939

SKEW ANGLE: NONE

WEARING SURFACE: 25 (1") MONOLITHIC CONCRETE

APPROACH SLABS: 7620 (25'-0") LONG

ALIGNMENT: TANGENT

**PROPOSED STRUCTURE**

TYPE: DUAL SINGLE SPAN PRESTRESSED CONCRETE I-BEAMS WITH COMPOSITE REINFORCED CONCRETE DECK, & SUPPORTED BY REINFORCED CONCRETE INTEGRAL ABUTMENTS

SPANS: 23 500 C/C BEARING

ROADWAY: 2 @ 17 200 TOE TO TOE OF BARRIER

LOADING: MS18 AND ALTERNATE MILITARY LOADING

SKEW ANGLE: NONE

WEARING SURFACE: MONOLITHIC CONCRETE

APPROACH SLABS: AS-1-81M, 4600 LONG

ALIGNMENT: TANGENT

CROWN: 0.016

LATITUDE: 42° 06' 40" LONGITUDE: 81° 22' 10"

**TRAFFIC DATA**

CURRENT YEAR ADT (1997): 49,500

DESIGN YEAR ADT (2017): 67,500

DESIGN YEAR ADT (2017): 2,025

SOURCE: oDOT

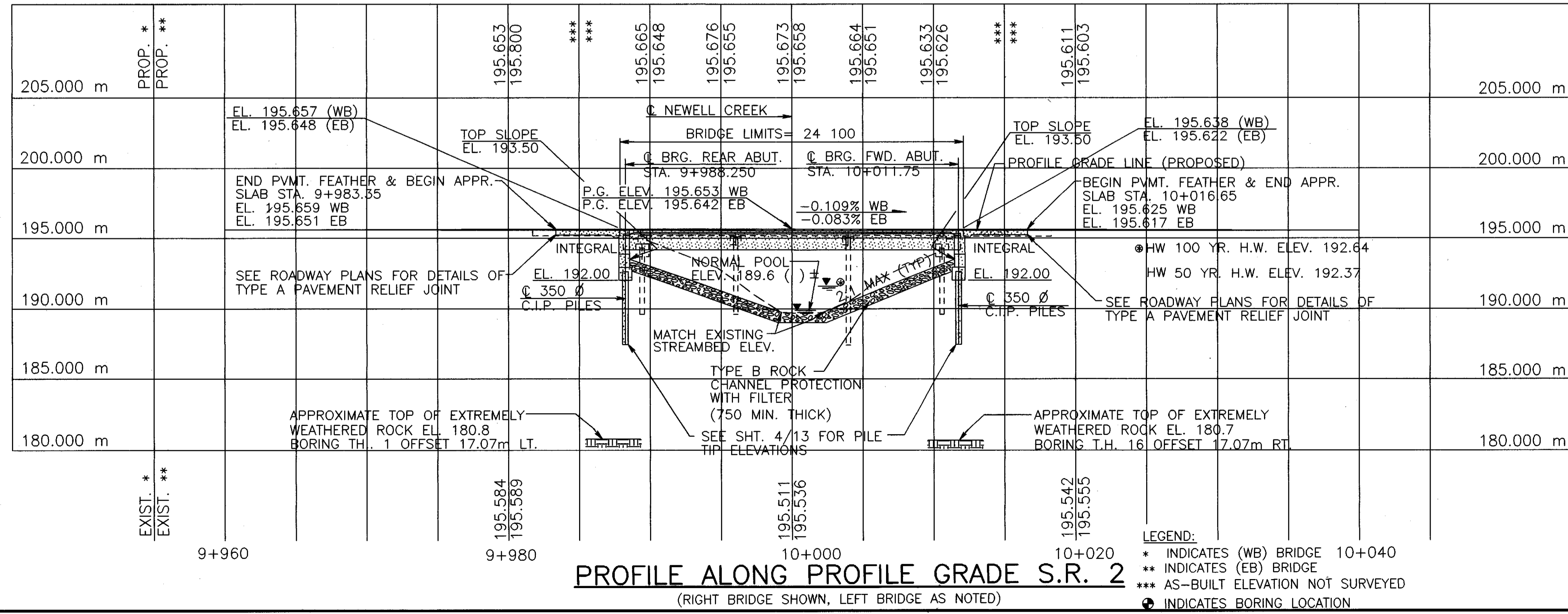

- LEGEND:
- \* INDICATES (WB) BRIDGE 10+040
  - \*\* INDICATES (EB) BRIDGE
  - \*\*\* AS-BUILT ELEVATION NOT SURVEYED
  - INDICATES BORING LOCATION

DESIGN AGENCY: GANNETT FLEMING CORDRY & CARPENTER ENGINEERS AND PLANNERS, 5015 PINE CREEK DR., COLUMBUS, OHIO 43081  
 DATE: 1/97  
 DRAWN BY: BJA  
 CHECKED BY: DEK  
 DESIGNED BY: JR  
 REVISIONS: 1/97  
 STRUCTURE FILE NUMBER: 4300912(L) 4300920(R)  
 LAKE COUNTY SITE PLAN  
 BRIDGE NO. LAK - 2 - 12231  
 S.R. 2 OVER NEWELL CREEK  
 LAKE COUNTY STA. 9+971.350  
 STA. 10+028.650  
 LAK-2-12.231 (L & R)  
 1/13  
 31  
 43