

CROSS REFERENCES	
SHEET NO.	DESCRIPTION

EXISTING STRUCTURE
 TYPE: DUAL - 3 SPAN CONTINUOUS REINFORCED CONCRETE SLAB & PILE BENTS
 SPANS: 6.71m, 7.92 m & 6.71m C/C BEARING
 ROADWAY: TWO @ 12.802 m F/F PARAPET
 LOAD FREQUENCY: CF-2000
 SKEW: NONE
 WEARING SURFACE: 25 mm MONOLITHIC CONCRETE
 APPROACH SLABS: 7.62 m LONG
 ALIGNMENT: TANGENT
 GENERAL CONDITION: POOR
 DISPOSITION: TO BE REMOVED
 STRUCTURE FILE NO.: 4300904 & 4300939
 DATE BUILT: 1959
 SUFFICIENCY RATING:

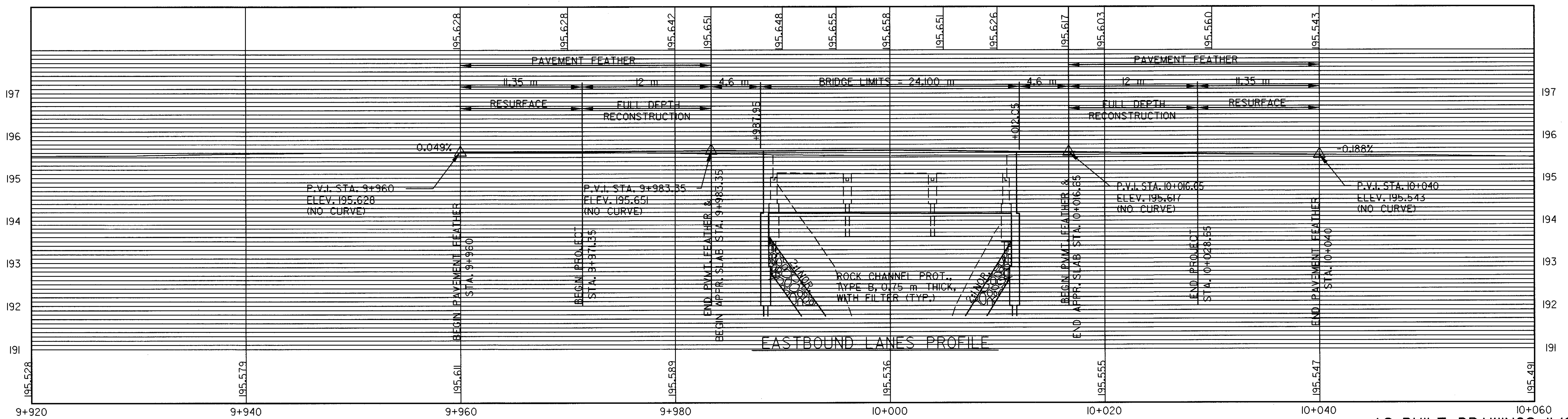

AS-BUILT DRAWINGS 11/97



CALCULATED 5
 SPT
 CHECKED

AS-BUILT PLANS - PROFILE SHEET
 STA. 9+920 TO STA. 10+060

LAK-2-12.231

SDThompson, J:\DWG5\953241\3580903.DWG DATE: NOV. 12, 1997 TIME: 8:45 AM