

LAKE COUNTY
LAK-2-1035

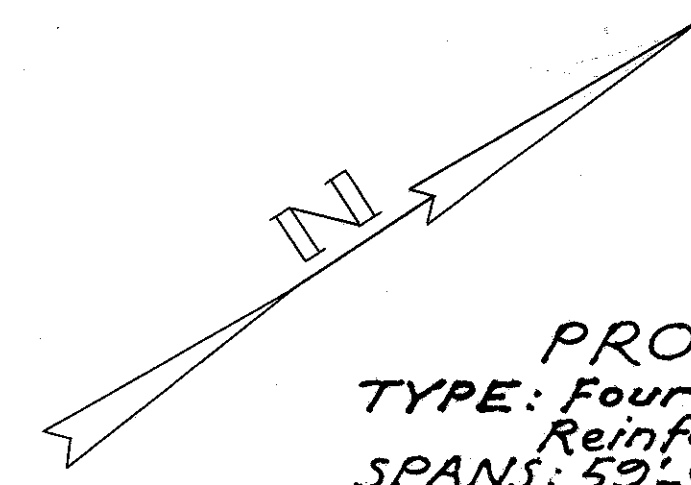

PROPOSED STRUCTURE
 TYPE: Four Span Continuous Plate Girder
 Reinforced Concrete Deck & Substructure
 SPANS: 59'-0", 88'-6", 99'-6", 66'-0"
 ROADWAY: 34'-0" f/f Parapets, 1'-2" Curbs
 LOAD FREQUENCY: C.F. - 2000 Adequate for A.A.S.H.O. Alternate Loading
 SKEW: 37°14'21.82" Lt.
 WEARING SURFACE: 1" Monolithic Concrete
 APPROACH SLABS: 25'-0" Long
 ALIGNMENT: 8°00'00" Curve Rt.
 SUPERELEVATION: 1" per Ft.
 TRAFFIC COUNT: 1975 A.D.T. = 4140

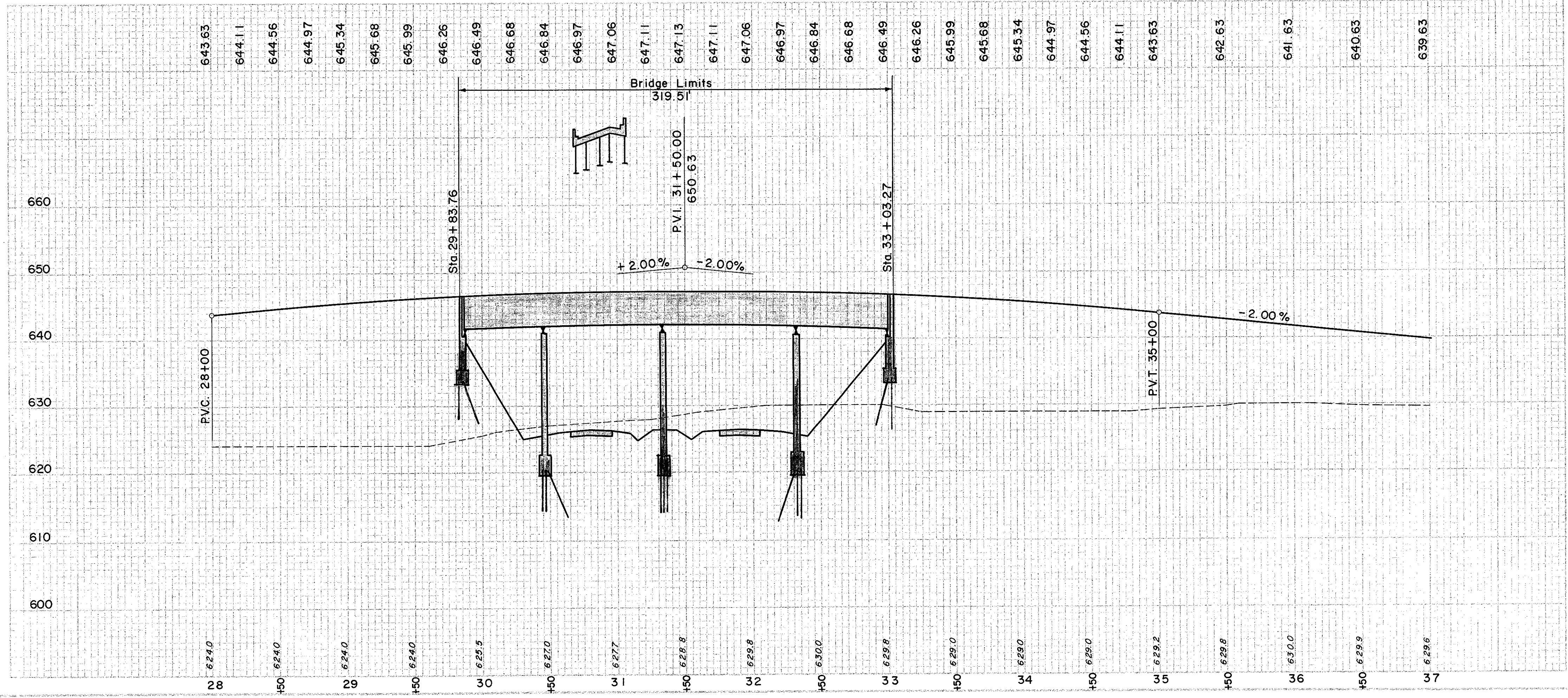
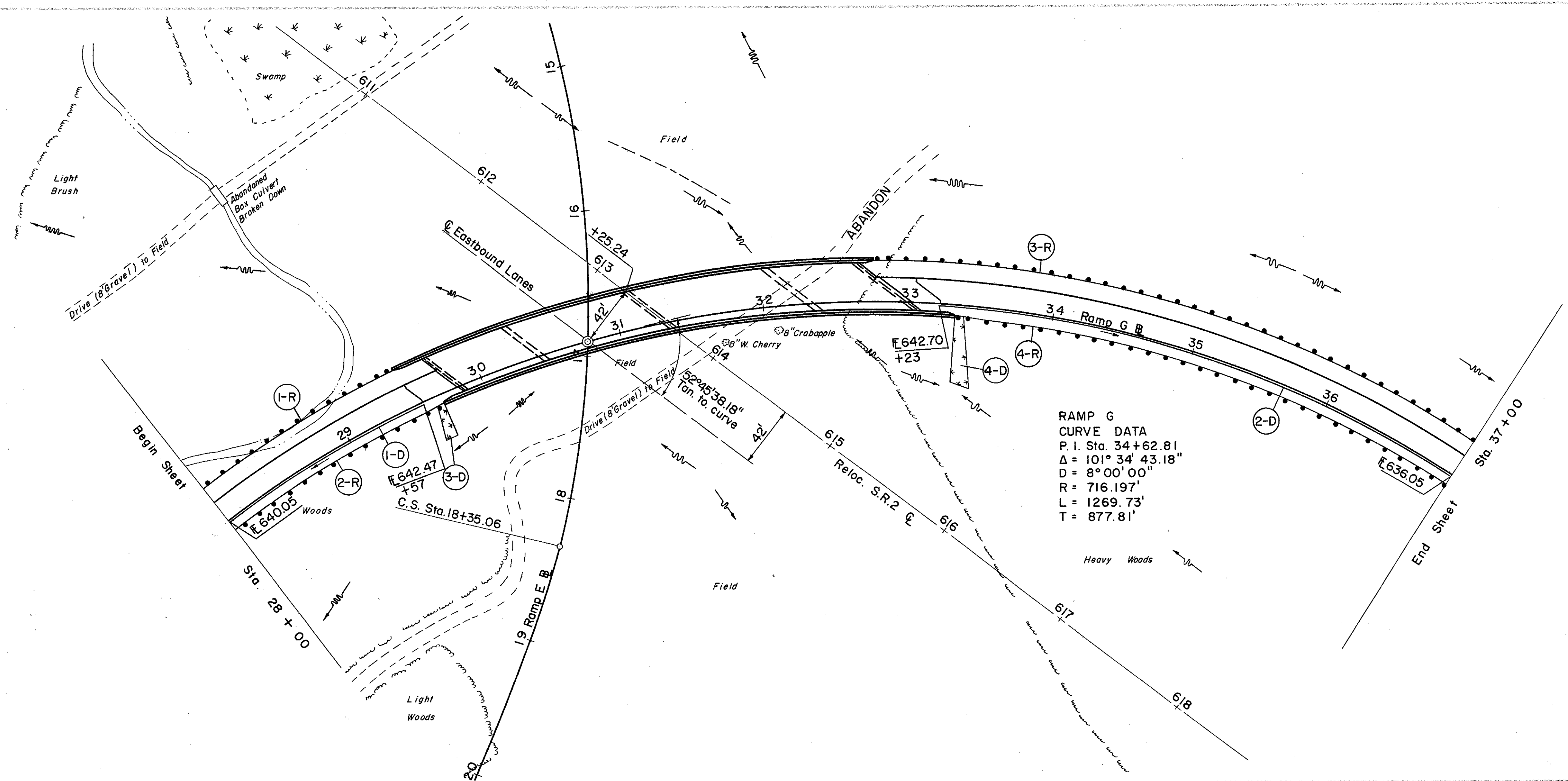

(R) ROADWAY

REF. NO.	STATION		SIDE	I-15 GUARD RAIL STEEL BEAM STD. TYPE (DEEP)
	FROM	TO		
1-R	27+92	28+50	LT.	162.5
2-R	27+92	29+72	RT.	175.0
3-R	32+75	37+00	LT.	437.5
4-R	33+30	37+00	RT.	362.5
TOTAL				1137.5

(D) DRAINAGE

REF. NO.	STATION		SIDE	I-4 6" PIPE UNDER-DRAIN (SHALLOW)	L-10 SODDING FOR SPECIAL BERM & SLOPE PROTECT.
	FROM	TO			
1-D	28+00	29+57	RT.	157	
2-D	33+23	37+00	RT.	377	
3-D	29+70		RT.		22
4-D	33+35		RT.		49

FOR PAVEMENT QUANTITIES
SEE SHEET NO. 206

JUL 1 1995

Excavation	=	4,618 C.Y.
Embankment	=	27,282 C.Y.
Embankment 20'	=	32,738 C.Y.

Traced T.J.S. 11-19-99