

STATE OF OHIO DEPARTMENT OF TRANSPORTATION

PART	COUNTY	ROUTE	BRIDGE NUMBER	WORK LIMITS		NET LENGTH MILES	MUNICIPALITY	S.F.N.	PART	COUNTY	ROUTE	BRIDGE NUMBER	WORK LIMITS		NET LENGTH MILES	MUNICIPALITY	S.F.N.
				BEGIN	END								BEGIN	END			
1	LAKE	2	0055L	129+3.72	130+79.28	0.03	WICKLIFFE	4300092	9	LAKE	2	0399L	310+54.21	312+82.19	0.04	WICKLIFFE	4300572
2	LAKE	2	0055R	129+3.72	130+79.28	0.03	WICKLIFFE	4300122	10	LAKE	2	0399R	310+54.21	312+82.19	0.04	WICKLIFFE	4300602
3	LAKE	2	0180L	195+4.24	196+79.26	0.03	WILLOWICK	4300211	10A	LAKE	2	0451	310+64.70	31+95.70	0.02	WICKLIFFE	4300637
4	LAKE	2	0180R	195+4.24	196+79.26	0.03	WILLOWICK	4300246	11	LAKE	2	0456	310+64.70	31+95.70	0.02	WICKLIFFE	4300661
5	LAKE	2	0255L	234+69.16	236+17.60	0.03	EASTLAKE	4300300	12	LAKE	2	0542	28+84.38	31+31.20	0.05	WICKLIFFE	4300815
6	LAKE	2	0255R	234+69.16	236+17.60	0.03	EASTLAKE	4300335	13	LAKE	2	1029	28+67.14	31+15.85	0.05	MENTOR	4301056
7	LAKE	2	0363L	291+88.11	293+25.53	0.03	EASTLAKE	4300483	14	LAKE	2	1141	28+61.14	31+38.50	0.05	MENTOR	4301110
8	LAKE	2	0363R	291+88.11	293+25.53	0.03	EASTLAKE	4300513	15	LAKE	2	1262	28+33.90	31+66.10	0.06	MENTOR	4301269

BRIDGE PAINTING

1997 SPECIFICATIONS

The standard specifications of the State of Ohio, Department of Transportation, including changes and supplemental specifications listed in the proposal shall govern this improvement.

I hereby approve these plans and declare that the making of this improvement will not require the closing to traffic of the highway and that provisions for the maintenance and safety will be as set forth on plans and estimates.

Approved
Date 2-17-99 *David C. [Signature]*
District Deputy Director of Transportation

Approved
Date 3-12-99 *Gordon Proctor [Signature]*
Director, Department of Transportation

INDEX OF SHEETS	
TITLE SHEET.....	1
LOCATION PLAN.....	2,3
GENERAL NOTES.....	4
ESTIMATED QUANTITIES.....	5-7
BRIDGE DATA.....	8-11
MAINTENANCE OF TRAFFIC.....	12-15

UNDERGROUND UTILITIES

2 WORKING DAYS
BEFORE YOU DIG

CALL TOLL FREE 800-362-2764
OHIO UTILITIES PROTECTION SERVICE
NON MEMBERS
MUST BE CALLED DIRECTLY

PLAN PREPARED BY:
O.D.O.T.
DISTRICT 12 BRIDGE
DEPARTMENT

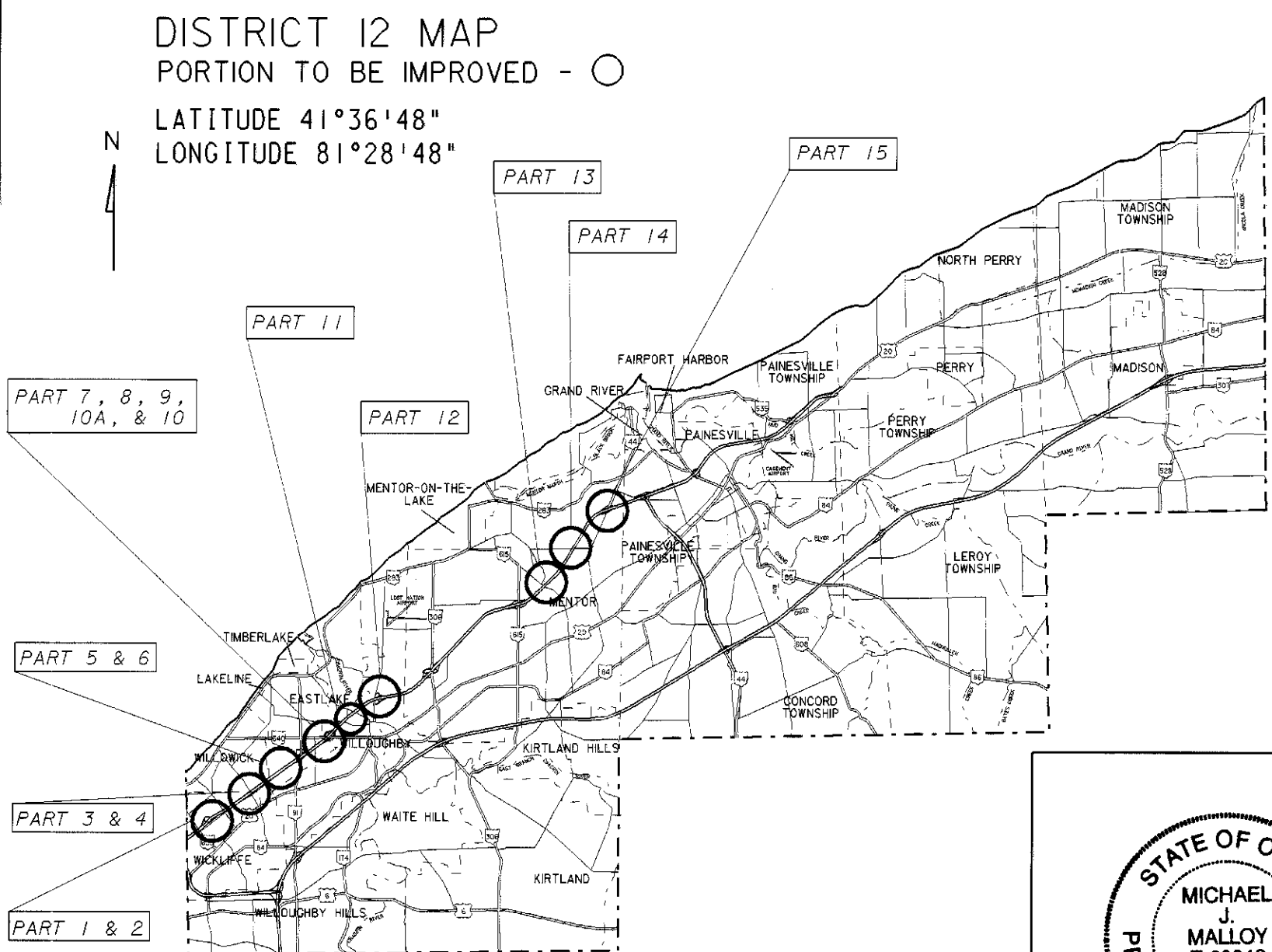

LAK-2-0.55 VARIOUS
990515 06-09-99
DIST. 12 PID # 14743

LAKE COUNTY

FEDERAL PROJECT NO.

PID NO.
14743

CONSTRUCTION PROJECT NO.

RAILROAD INVOLVEMENT

LAK-2-00.55 & VAR.

PLOT SUBMITTED: 24-FEB-1999 13:09
PLOT SUBMITTED BY: mmalloy
I:\user\mmalloy\dgn\mal\20055\1\file.dgn