

FED. RD. DIVISION	STATE	PROJECT	
2	OHIO		

294
394

LAKE - COUNTY
LAK. - 2-0.00

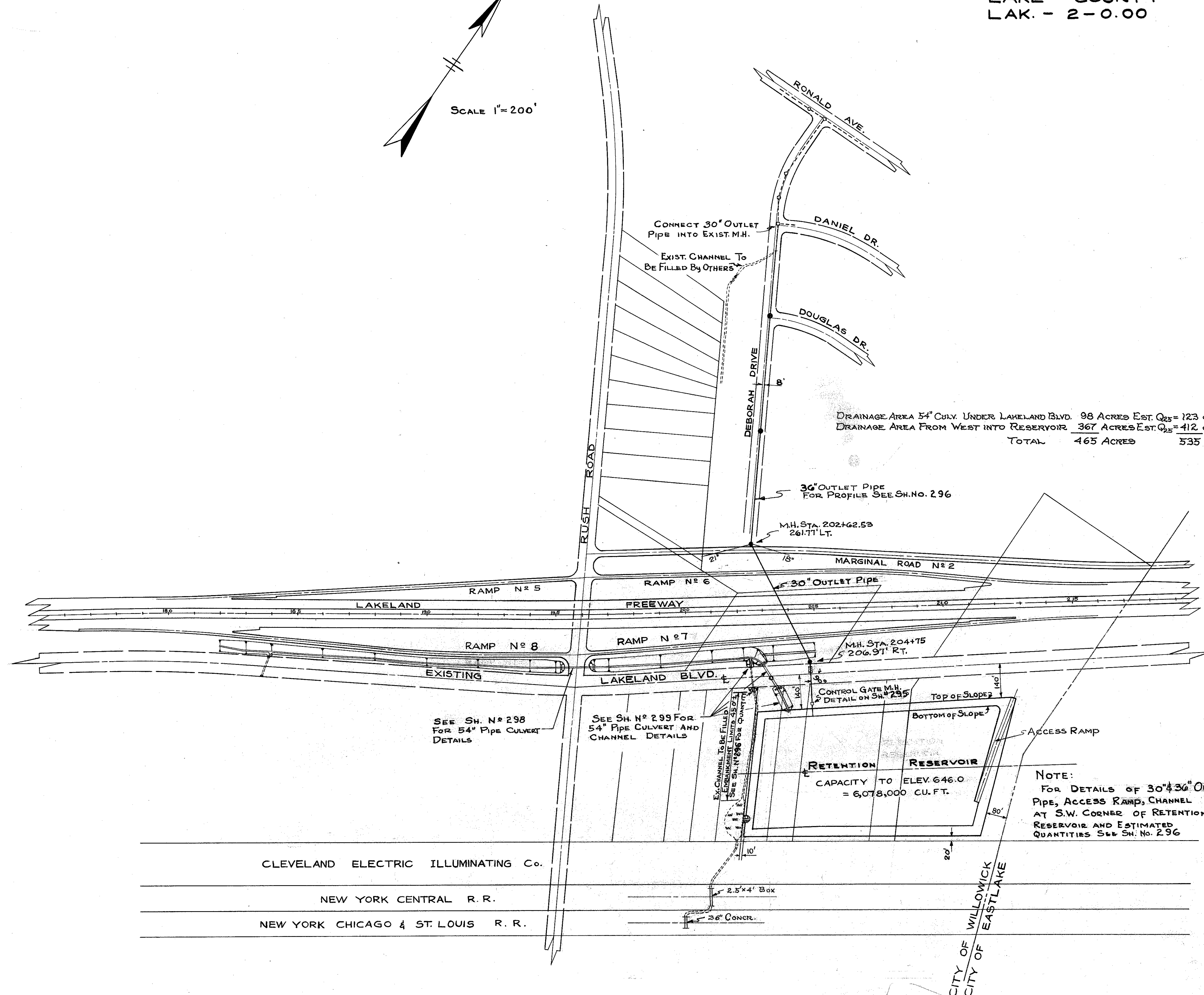
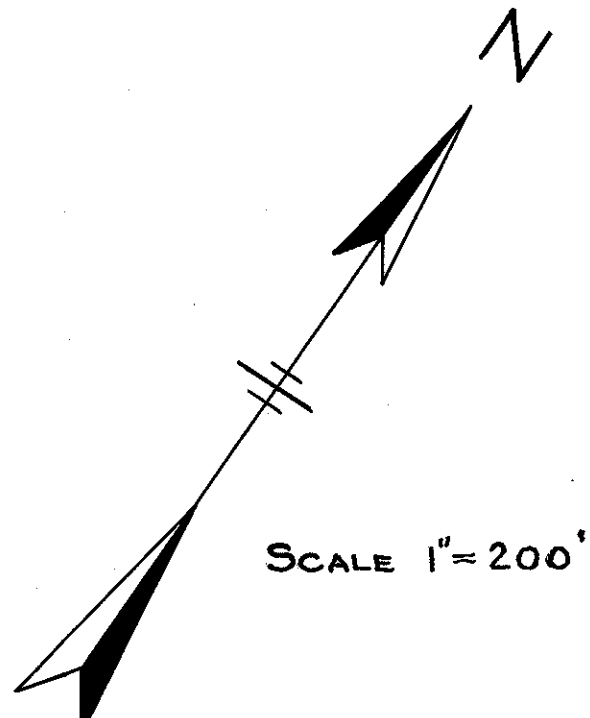

DRAINAGE AREA 54" CULV. UNDER LAKELAND BLVD. 98 ACRES EST. Q₂₅ = 123 C.F.S.
 DRAINAGE AREA FROM WEST INTO RESERVOIR 367 ACRES EST. Q₂₅ = 412 C.F.S.
 TOTAL 465 ACRES 535 C.F.S.

NOTE:
 FOR DETAILS OF 30" x 36" OUTLET PIPE, ACCESS RAMP, CHANNEL AT S.W. CORNER OF RETENTION RESERVOIR AND ESTIMATED QUANTITIES SEE SH. NO. 296

CLEVELAND ELECTRIC ILLUMINATING Co.
 NEW YORK CENTRAL R. R.
 NEW YORK CHICAGO & ST. LOUIS R. R.

LOCATION PLAN - RETENTION RESERVOIR