

LAKE COUNTY
LAK. - 2 - 0.00

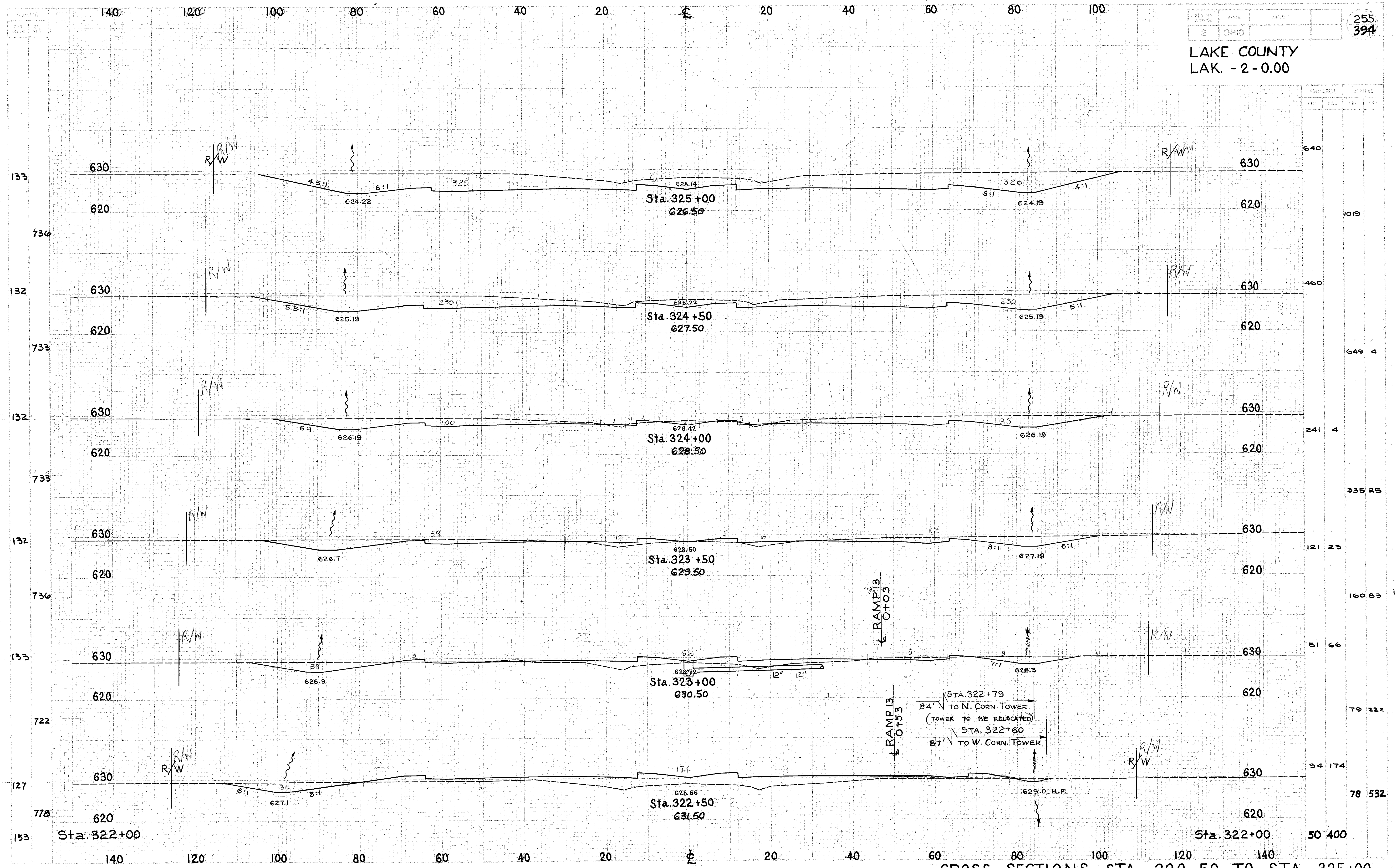

CROSS SECTIONS STA. 322+50 TO STA. 325+00

RAMP 13
O+053

STA. 322+79
84' TO N. CORN. TOWER
(TOWER TO BE RELOCATED)

STA. 322+60
87' TO W. CORN. TOWER

629.0 H.P.