

LAKE - COUNTY
LAK - 2 - 0.00

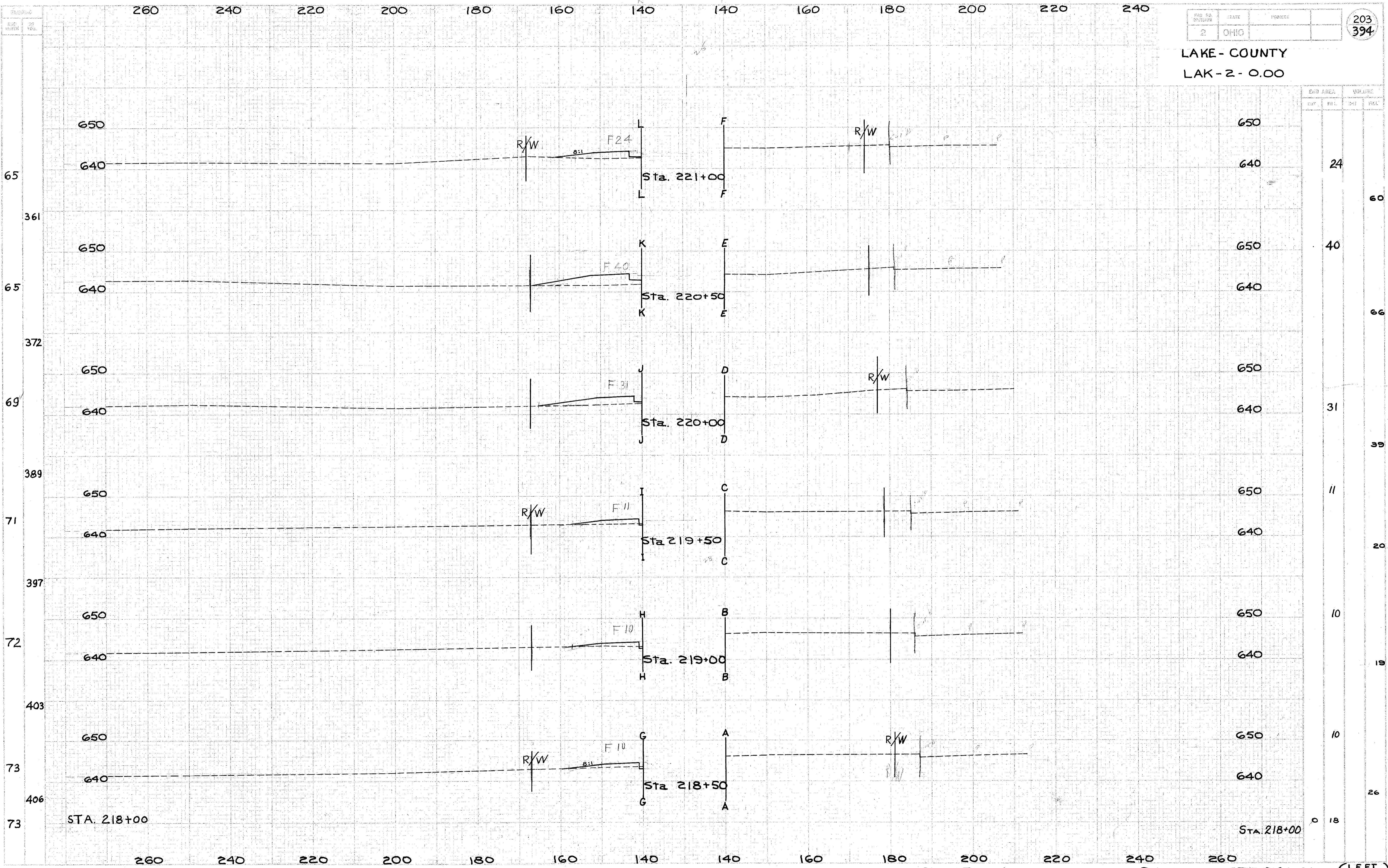

STATION	END AREA		VOLUME	
	CUT	FILL	CUT	FILL
221+00				
220+50				
220+00				
219+50				
218+50				

CROSS SECTION EXTENSIONS STA. 218+50 TO STA. 221+00 (LEFT RIGHT)