

119

140 120 100 80 60 40 20 E 20 40 60 80 100

LAKE COUNTY
LAK.-2-0.00

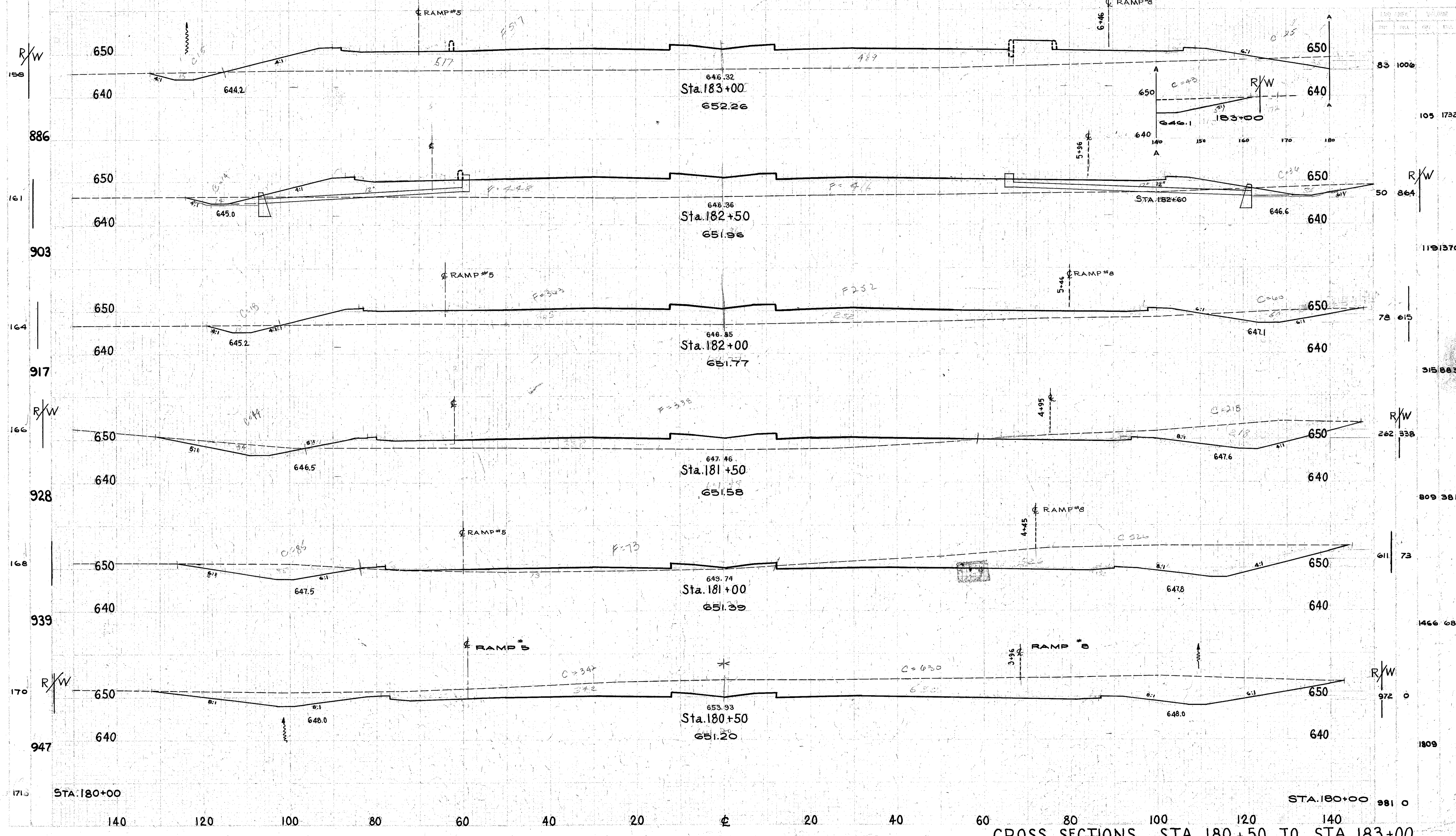

R/W 158
886
161
903
164
917
R/W 166
928
168
939
R/W 170
947
1713

83 1006
105 1732
119 1370
78 615
315 883
262 338
809 381
611 73
1466 68
972 0
1809

STA. 180+00

STA. 180+00 981 0

CROSS SECTIONS STA. 180+50 TO STA. 183+00