

**LAKE COUNTY  
LAK-2-0.00**

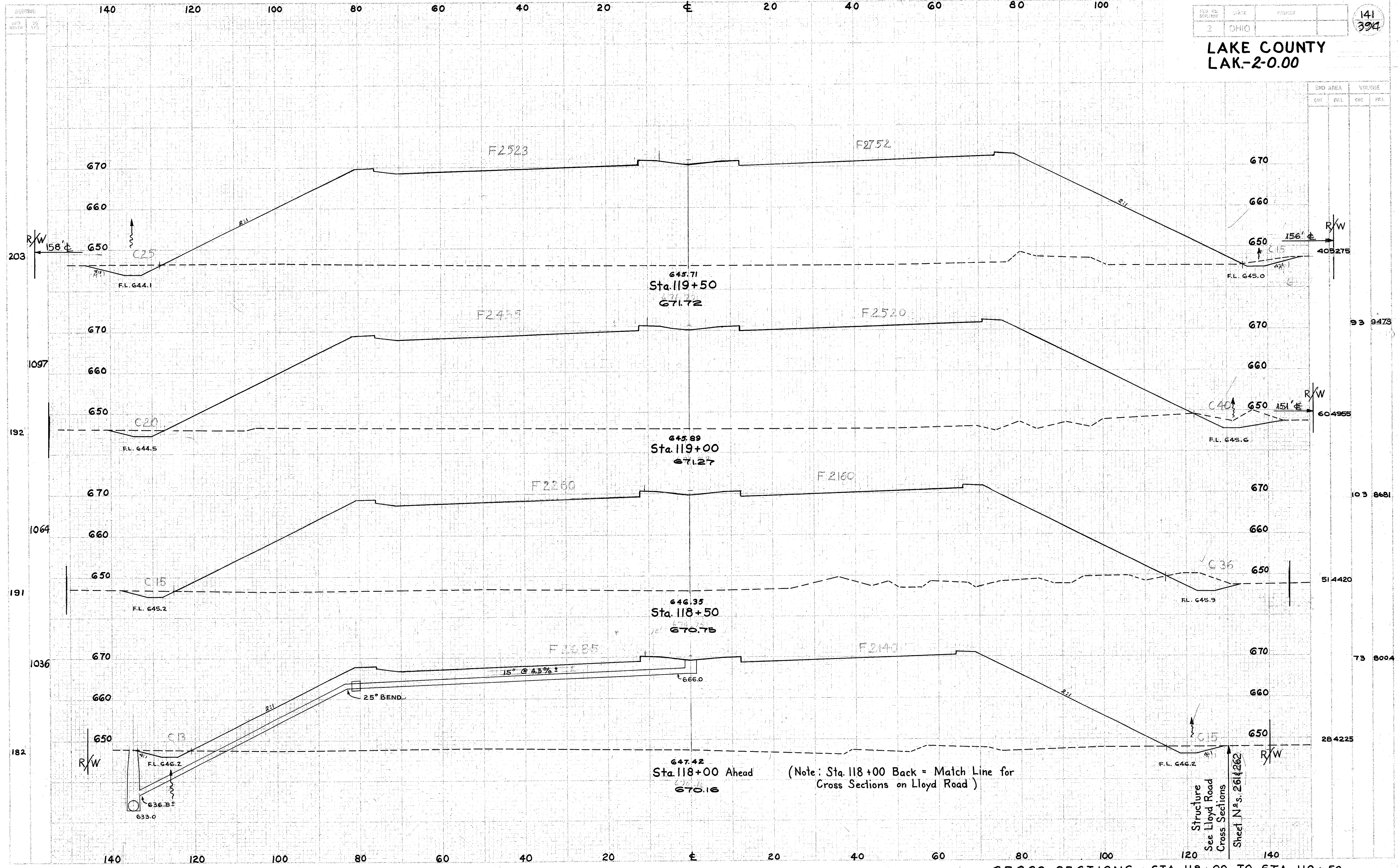

(Note: Sta. 118+00 Back = Match Line for Cross Sections on Lloyd Road)

Structure  
See Lloyd Road  
Cross Sections  
Sheet N<sup>o</sup>s. 261 & 262

CROSS SECTIONS - STA. 118+00 TO STA. 119+50