

CURVE DATA

① Δ: 48°08'52" R: 230.00' T: 102.76' L: 193.28' Ch: 187.64'	② Δ: 48°08'52" R: 238.00' T: 106.33' L: 200.00' Ch: 194.17'	③ Δ: 36°31'07" R: 220.53' L: 140.56' Ch: 138.19' T: 72.76'	④ Δ: 150°00'00" R: 125.00' T: 146.65' L: 132.25' Ch: 241.46'	⑤ Δ: 150°00'00" R: 133.00' T: 49.36' L: 348.19' Ch: 256.94'	⑥ Δ: 150°00'00" R: 141.00' T: 526.22' L: 369.14' Ch: 272.40'	⑦ Δ: 66°17'44" R: 151.00' T: 98.615' L: 174.72' Ch: 165.13'	⑧ Δ: 66°17'44" R: 161.00' T: 105.15' L: 186.29' Ch: 176.07'	⑨ Δ: 66°17'44" R: 177.00' T: 115.60' L: 204.80' Ch: 193.57'	⑩ Δ: 116°08'50" R: 75.00' T: 120.37' L: 152.04' Ch: 127.31'	⑪ Δ: 116°08'50" R: 83.00' T: 133.21' L: 168.08' Ch: 140.89'	⑫ Δ: 71°14'48" R: 91.00' T: 65.21' L: 113.16' Ch: 106.01'	⑬ Δ: 135°05'58" R: 500' L: 11.79'
--	--	---	---	--	---	--	--	--	--	--	--	--

EXTRA AREA DETAIL - RAMP Nos 11 & 12

SCALE 1" = 20'

FED. RD. DIVISION	STATE	PROJECT	FISCAL YEAR
2	OHIO		

LAKE COUNTY
LAK-2-0.00

102
394

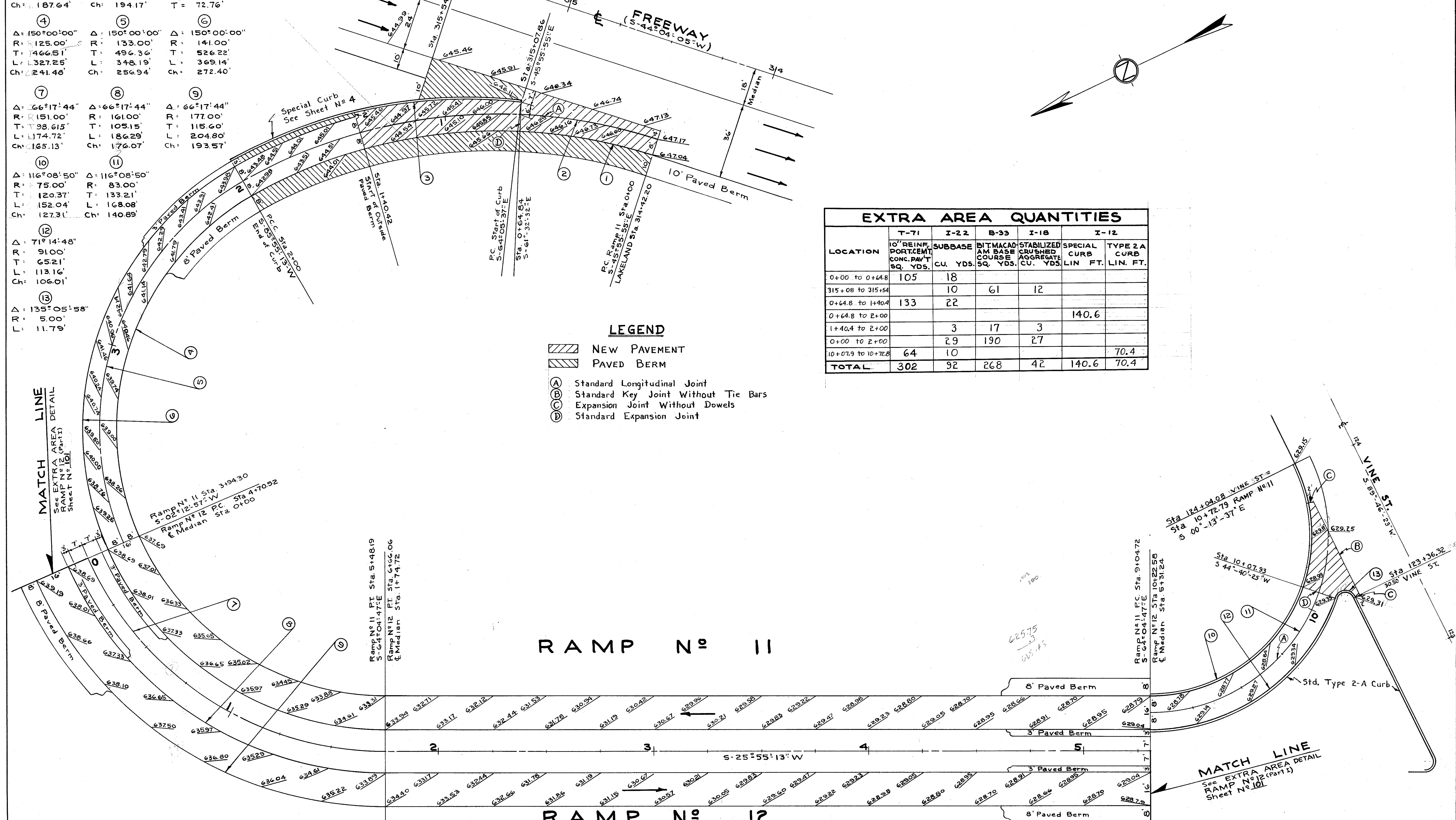

EXTRA AREA QUANTITIES

LOCATION	T-71 10' REINF. PORT.CEMT. CONC. PAV'T SQ. YDS.	I-22 SUBBASE CU. YDS.	B-33 BIT.MACAD. AM BASE COURSE SQ. YDS.	I-18 STABILIZED CRUSHED AGGREGATE CU. YDS.	SPECIAL CURB LIN. FT.	I-12 TYPE 2A CURB LIN. FT.
0+00 to 0+64.8	105	18				
315+08 to 315+54		10	61	12		
0+64.8 to 1+40.4	133	22				
0+64.8 to 2+00					140.6	
1+40.4 to 2+00		3	17	3		
0+00 to 2+00		29	190	27		
10+07.9 to 10+72.8	64	10				70.4
TOTAL	302	92	268	42	140.6	70.4

LEGEND

- NEW PAVEMENT
- PAVED BERM
- (A) Standard Longitudinal Joint
- (B) Standard Key Joint Without Tie Bars
- (C) Expansion Joint Without Dowels
- (D) Standard Expansion Joint

RAMP No 11

RAMP No 12

EXTRA AREA DETAIL - RAMP Nos 11 & 12 (PART II)