

EXTRA AREA DETAIL RAMP N: 8 SCALE 1"=20'

FED. RD. DIVISION	STATE	PROJECT	FISCAL YEAR
2	OHIO		

97
394

LAKE COUNTY
LAK-2-0.00

EXTRA AREA QUANTITIES						
LOCATION	T-71 10" REINF. PORT. CEMT. CONC. PAV'T SQ. YDS.	I-22 SUBBASE CU. YDS.	B-33 BIT. MACAD. AM. BASE COURSE SQ. YDS.	I-18 STABILIZED CRUSHED AGGREGATE CU. YDS.	I-12 TYPE 6 CURB LIN. FT.	I-21 4" PORT. CEM'T. CONC. MEDIAN SQ. YDS.
176+53.79 to 183+53.63	1476	353	662	94	106.0	26
5+97.84 to 6+94.82	183	51	129	20	97.0	
TOTAL	1659	404	791	114	203.0	26

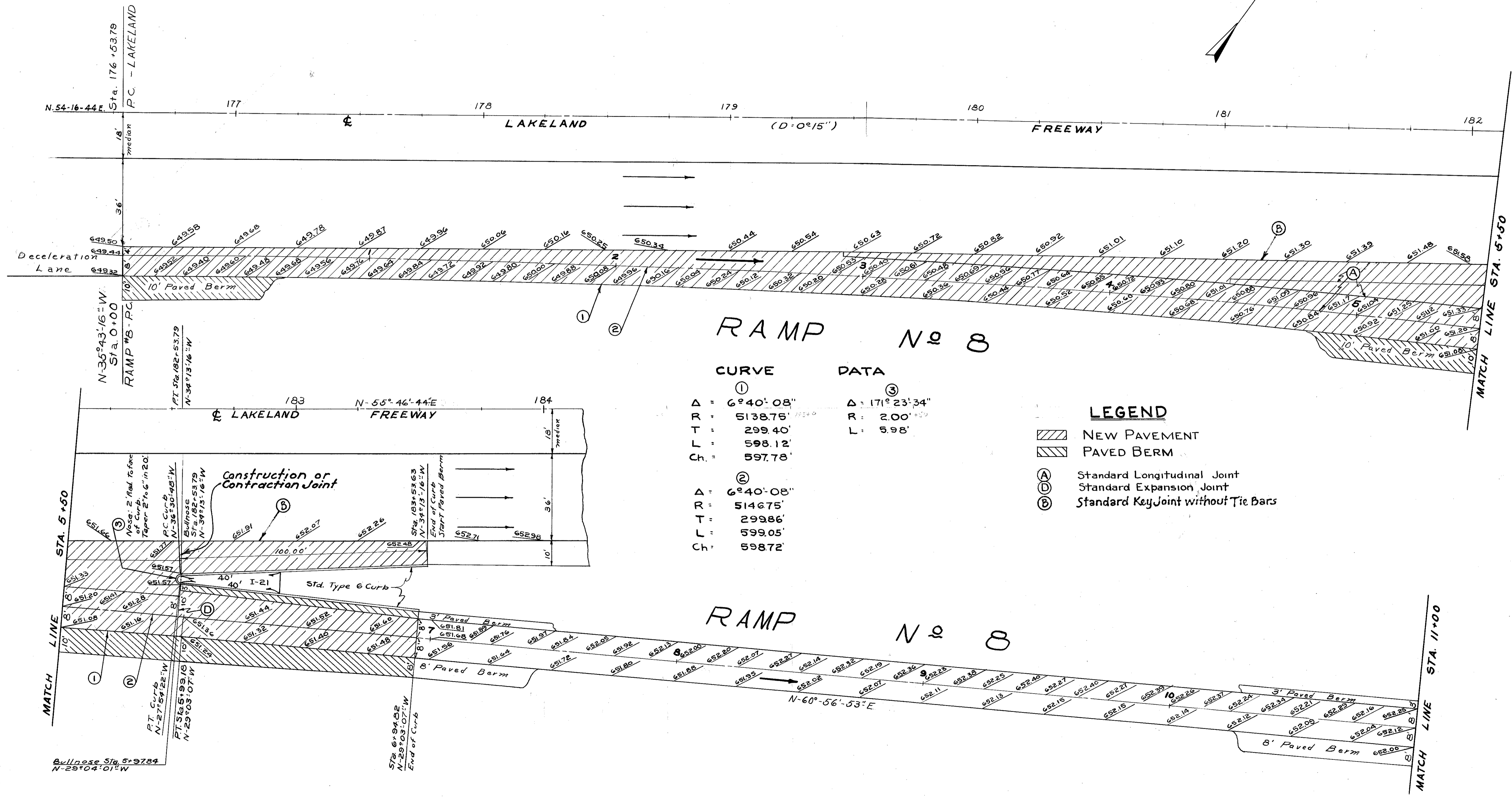
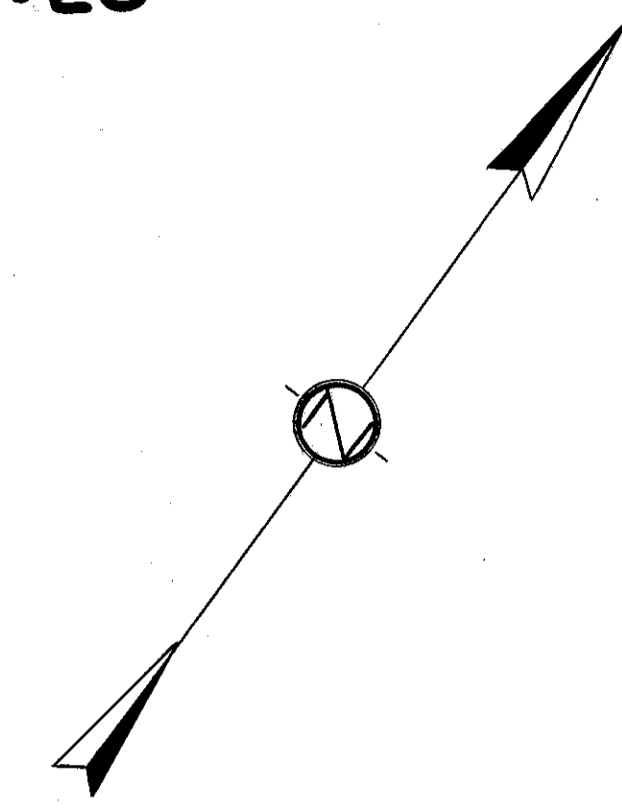

CURVE DATA

①	③
Δ = 6°40'08"	Δ = 171°23'34"
R = 5138.75'	R = 2.00'
T = 299.40'	L = 5.98'
L = 598.12'	
Ch. = 597.78'	
②	
Δ = 6°40'08"	
R = 5146.75'	
T = 299.86'	
L = 599.05'	
Ch. = 598.72'	

- LEGEND**
- NEW PAVEMENT
 - PAVED BERM
 - Ⓐ Standard Longitudinal Joint
 - Ⓓ Standard Expansion Joint
 - Ⓑ Standard Key Joint without Tie Bars

