

EXTRA AREA DETAIL - RAMP N^o 4

SCALE 1" = 20'

FED. RD. DIVISION	STATE	PROJECT	FISCAL YEAR
2	OHIO		

LAKE COUNTY
LAK-2-0.00

92
394

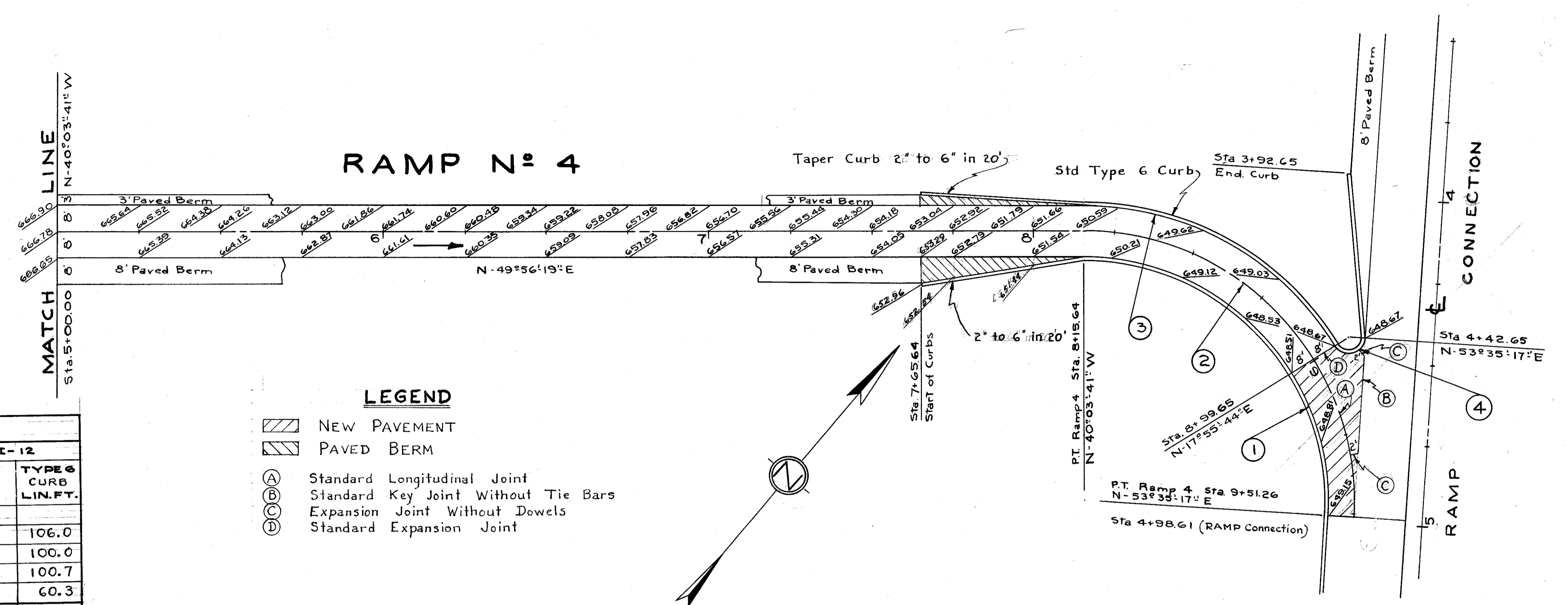

LEGEND

- NEW PAVEMENT
- PAVED BERM
- (A) Standard Longitudinal Joint
- (B) Standard Key Joint Without Tie Bars
- (C) Expansion Joint Without Dowels
- (D) Standard Expansion Joint

EXTRA AREA QUANTITIES						
LOCATION	T-71 10" REINF. PORT. CEMENT CONC. PAVT. SQ. YDS.	I-22 SUBBASE CU. YDS.	I-18 STABILIZED CRUSHED AGGREGATE CU. YDS.	B-33 BITUMACAD AM BASE COURSE SQ. YDS.	I-21 4" PORT. CEM. CONC. MEDIAN SQ. YDS.	I-12 TYPE 6 CURB LIN. FT.
0+00 to 3+35	872	201	53	372		
3+35 to 4+34.98	189	56	21	133	26	106.0
123+88.44 to 124+88.56	134	23				100.0
7+65.64 to 8+15.64		5	6	31		100.7
8+99.65 to 9+51.26	75	13				60.3
TOTAL	1270	298	80	536	26	367.0

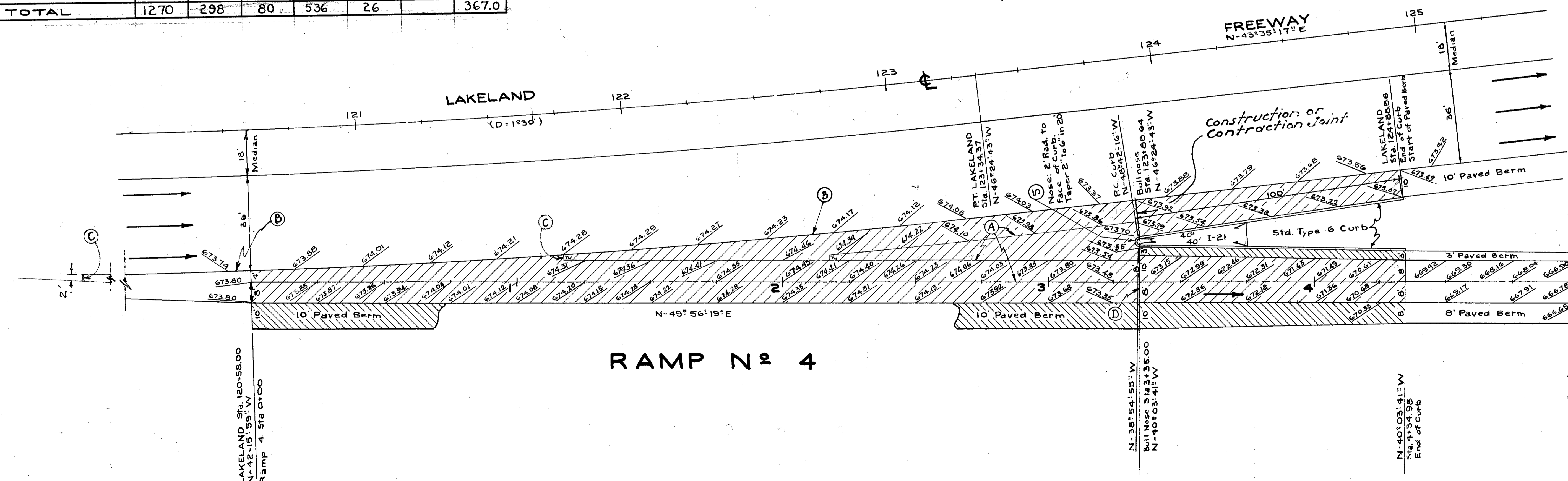

CURVE DATA

(1)	Δ: 93°38'58"	R: 75.00'	T: 79.94'	L: 122.59'	Ch: 109.39'
(2)	Δ: 93°38'58"	R: 83.00'	T: 88.46'	L: 135.62'	Ch: 121.06'
(3)	Δ: 57°59'25"	R: 91.00'	T: 50.43'	L: 92.10'	Ch: 86.22'
(4)	Δ: 154°20'27"	R: 5.00'	L: 13.47'		
(5)	Δ: 170°22'40"	R: 2.00'	L: 5.95'		

EXTRA AREA DETAIL - RAMP N° 4