

# EXTRA AREA DETAIL - RAMP N° 1

SCALE 1" = 20'

FED. RD. DIVISION	STATE	PROJECT	FISCAL YEAR
2	OHIO		

LAKE COUNTY  
LAK-2-0.00

87  
394

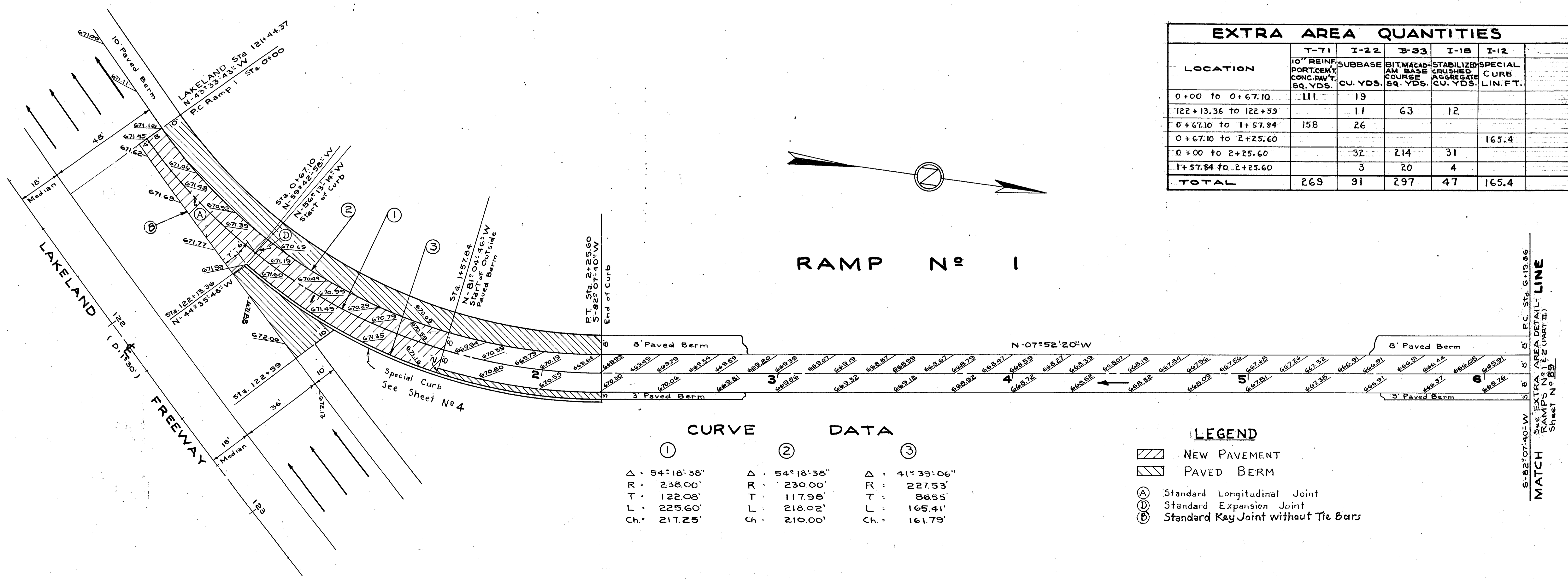

LOCATION	T-71 10" REINF. PORT. CEMENT CONC. PAVT. SQ. YDS.	I-22 SUBBASE CU. YDS.	B-33 BIT. MACAD- AM. BASE COURSE SQ. YDS.	I-18 STABILIZED CRUSHED AGGREGATE CU. YDS.	I-12 SPECIAL CURB LIN. FT.
0+00 to 0+67.10	111	19			
122+13.36 to 122+59		11	63	12	
0+67.10 to 1+57.84	158	26			
0+67.10 to 2+25.60					165.4
0+00 to 2+25.60		32	214	31	
1+57.84 to 2+25.60		3	20	4	
<b>TOTAL</b>	<b>269</b>	<b>91</b>	<b>297</b>	<b>47</b>	<b>165.4</b>

①	②	③
Δ : 54° 18' 38"	Δ : 54° 18' 38"	Δ : 41° 39' 06"
R : 238.00'	R : 230.00'	R : 227.53'
T : 122.08'	T : 117.98'	T : 86.55'
L : 225.60'	L : 218.02'	L : 165.41'
Ch : 217.25'	Ch : 210.00'	Ch : 161.79'

	NEW PAVEMENT
	PAVED BERM
	Standard Longitudinal Joint
	Standard Expansion Joint
	Standard Key Joint without Tie Bars

MATCH  
 S-82°07'40"W  
 See EXTRA AREA DETAIL -  
 RAMP N° 1, SHEET (PART II)  
 Sheet N° 89