

MICROFILMED  
SEP 17 1986

# LOCATION PLAN

SCALE 1" = 500'

FED. RD. DIVISION	STATE	PROJECT
2	OHIO	

2A  
394

LAKE COUNTY  
LAK.-2-0.00

### LIGHTS, SIGNS AND BARRICADES

The Contractor shall, in addition to the general requirements of Sec. G-7.07 on this project, perform the following:

- Provide, erect and maintain movable gates on intersecting roads closed to traffic at all points where local traffic movement terminates.
- Provide, erect and maintain lights, signs and barricades at the work limits on all intersecting roads which remain open to traffic.
- Provide, erect and maintain standard 40" x 24" size "Road Closed" signs, sign supports and lights at the following locations during periods in which the affected roads are closed to traffic:
  - On Rush Road at Euclid Ave. (U.S.R. 20)
  - On Rush Road at Barjode Rd.
  - On Beidler Rd. at Buffalo Ave. (U.S.R. 20)
  - On Beidler Rd. at Vine St.

Lights, barricades, danger and warning signs shall be provided at locations shown in accordance with Sec. G-7.07. Barricades and gates shall be as detailed on Std. Dwg. G-7.07. Sign supports and lights for "Road Closed" signs shall be as detailed in the Ohio Manual of Uniform Traffic Control Devices.

Payment for providing, erecting, maintaining and subsequently removing barricades, gates, lights, signs and sign supports shall be included in the lump sum price bid for "Maintaining Traffic."

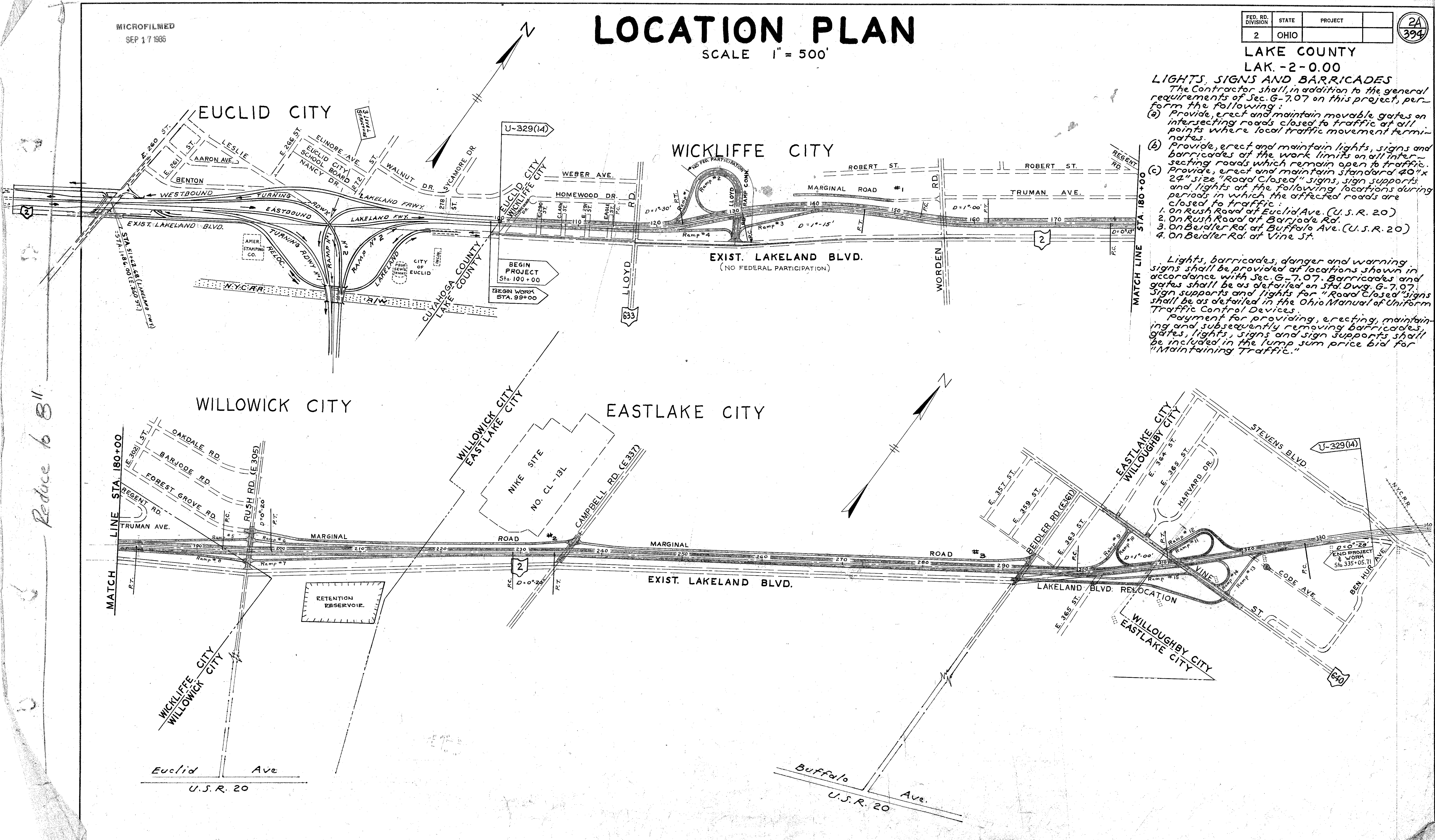

Reduce to 8"