

EXTRA AREA DETAIL

SCALE 1" = 20'

FED. RD. DIVISION	STATE	PROJECT	9 21
2	OHIO		

LAKE COUNTY
LAKE 174-3.80

EXTRA AREA QUANTITIES											
T-71	T-35	B-35	B-35	I-22	I-21	I-12	T-30	E-8	E-8	S-23	SPECIAL
8" REINFORCED PORTLAND CEMENT CONCRETE PAVEMENT	1"-1 1/2" ASPHALTIC CONCRETE SURFACE COURSE	ASPHALTIC CONCRETE LEVELING COURSE VARIABLE THICKNESS	ASPHALTIC CONCRETE LEVELING COURSE	SUBBASE VARIABLE THICKNESS	4" PORT. CEM. CONC. TRAFFIC ISLAND PAVEMENT	CONCRETE CURB TYPE 2-A	BITUMINOUS TACK COAT 0.10 GAL/SQ. YD.	REMOVAL & DISPOSAL OF EXIST. CONC. CURB	Removal + Disposal of Existing Wearing Course	DOWEL HOLES	STANDARD EXPANSION BOLTS
SQ. YDS.	CU. YDS.	CU. YDS.	CU. YDS.	CU. YDS.	SQ. YDS.	LIN. FT.	GAL.	LIN. FT.	Sq. Yd.	EACH	EACH
921	3.4	5.3		172	72	514	10.8	244	71	49	49

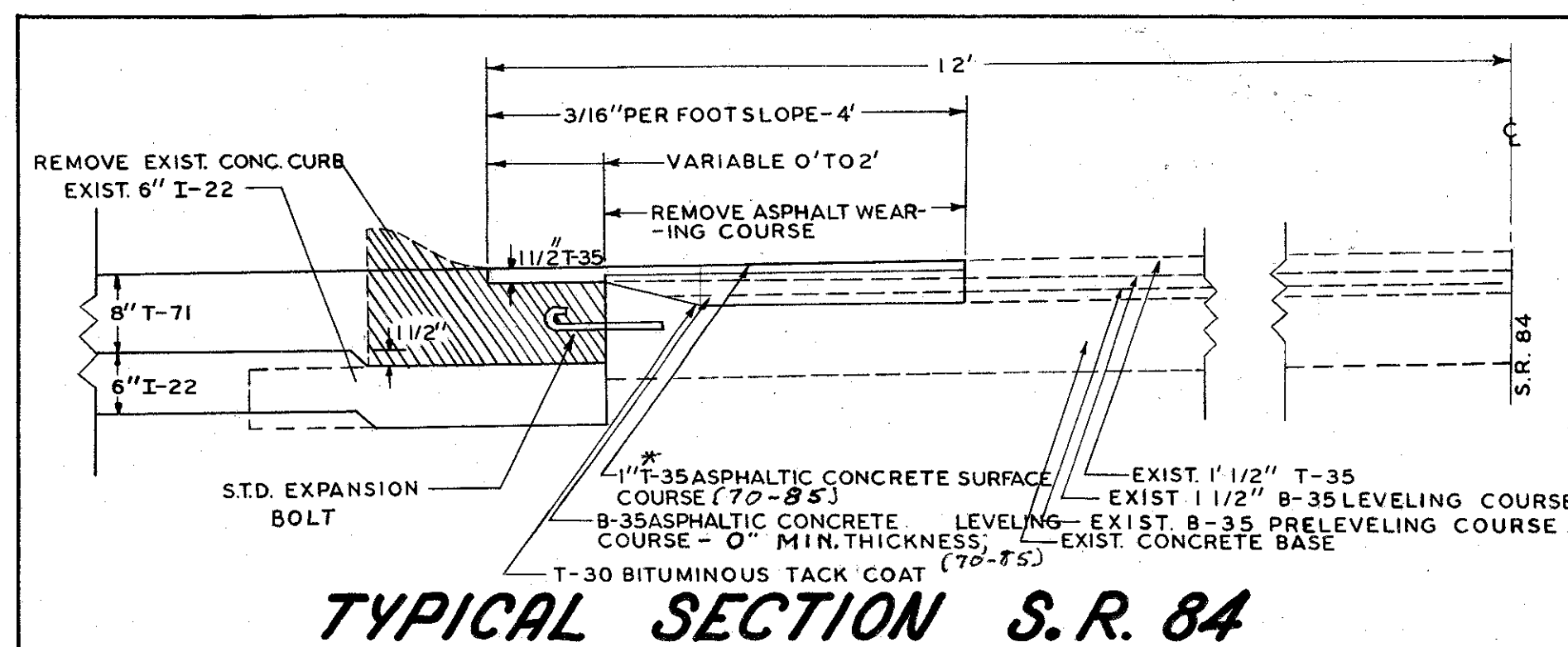

$\Delta = 6^\circ - 29' - 00''$
 $D = 2^\circ - 07' - 40''$
 $R = 2692.88$
 $T = 152.52$
 $L = 304.71$

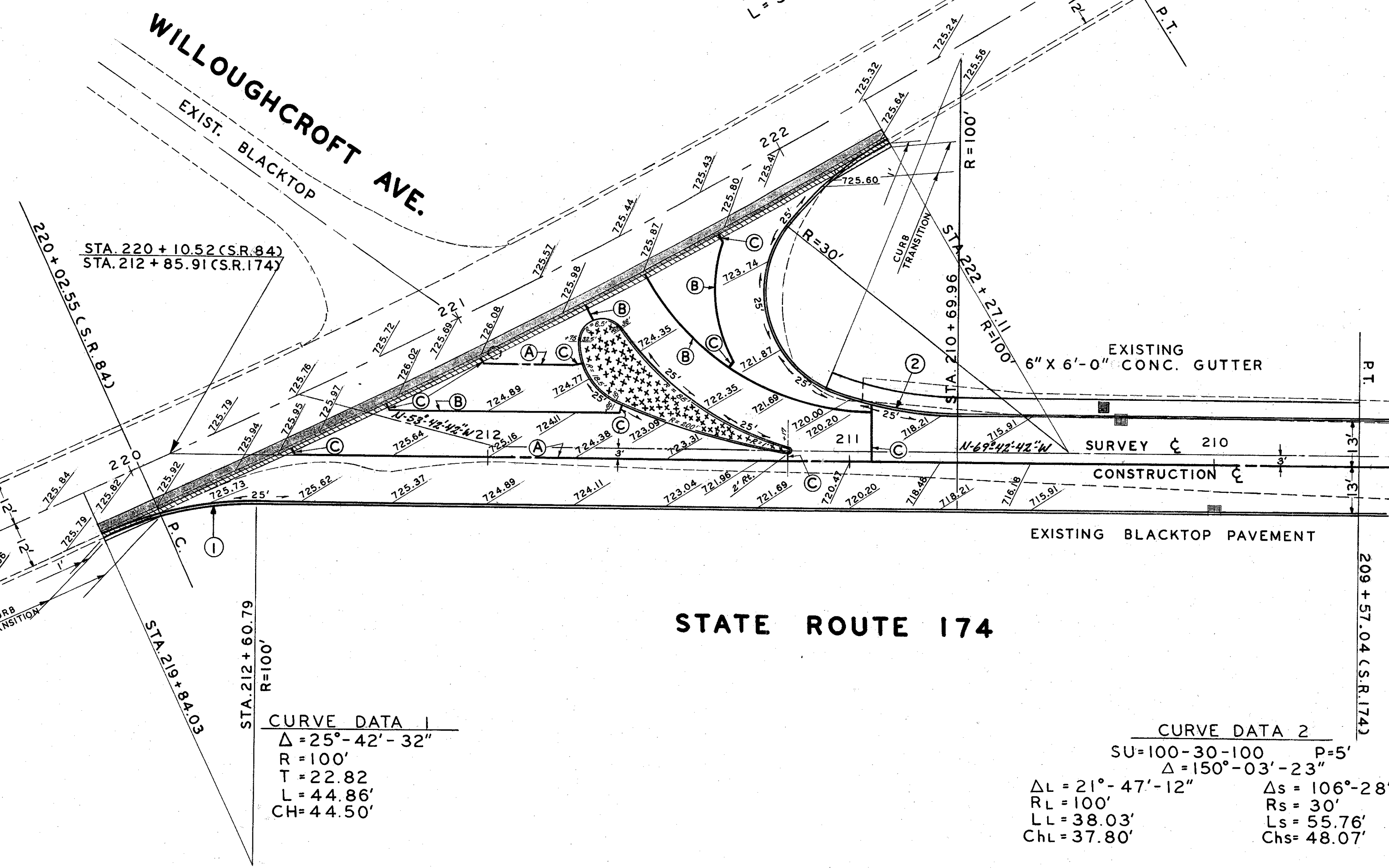

LEGEND

- (A) STANDARD LONGITUDINAL JOINT
- (B) STANDARD KEY JOINT WITHOUT TIE BARS
- (C) 2' EXPANSION JOINT, WITHOUT DOWELS, LOCATED ON RADIAL LINES.
- REMOVAL & DISPOSAL OF EXIST. CONC. CURB
- REMOVAL & DISPOSAL OF EXIST. ASPHALT WEARING COURSE RESURFACE WITH ASPHALT (1" - 1 1/2" T-35; B-35 LEVELING COURSE (VARIABLE THICKNESS), 0.10 GAL/SQ. YD. T-30
- 4" PORTLAND CEMENT CONCRETE TRAFFIC ISLAND PAVEMENT

CURVE DATA 1

$\Delta = 25^\circ - 42' - 32''$
 $R = 100'$
 $T = 22.82$
 $L = 44.86'$
 $CH = 44.50'$

CURVE DATA 2

$SU = 100 - 30 - 100$ $P = 5'$
 $\Delta = 150^\circ - 03' - 23''$
 $\Delta L = 21^\circ - 47' - 12''$ $\Delta s = 106^\circ - 28' - 59''$
 $RL = 100'$ $Rs = 30'$
 $LL = 38.03'$ $Ls = 55.76'$
 $ChL = 37.80'$ $Chs = 48.07'$