

MAP OF SURVEY

for

THE DOUGHERTY LUMBER COMPANY

Known as being all of Sublot Nos. 3 through 5 inclusive and all of Sublots H, I, J and K in Block 3, all of Sublot Nos. 1 through 6 inclusive and all of Sublots B, C, D, E, F and G in Block 4, part of Block 5, all of Sublot Nos. 17, 18, 19A, 20, 21A, 22, 23A, and 36 through 40 inclusive in Block 6, all of Sublot Nos. 8 through 11 inclusive and all of Sublot Nos. 14A, 15A and 16, and part of Sublot Nos. 12 and 13A in Block 7, and all of Sublot Nos. 7, 8, 18, 19, and 20 in Block 8 of The Shaker Vineyards Land Company's Euclid Avenue Subdivision of part of Original Willoughby Township Lot No. 4, Tract No. 8 and Lot Nos. 7, 8, 9, and 10 in Tract No. 12 as shown by the recorded plat in Volume H of Maps, Pages 61 and 62 of Lake County Records, part of East 293rd Street (formerly Third Avenue) vacated in Volume P of Maps, Page 61 of Lake County Records, part of East 294th Street (formerly First Avenue) vacated in Volume M of Maps, Page 94 of Lake County Records, and other lands in Original Willoughby Township Lot Nos. 7, 8, and 9 in Tract No. 12, now situated in the

CITY OF WICKLIFFE  
COUNTY OF LAKE - STATE OF OHIO

by

McSTEEN & ASSOCIATES, INC.

ENGINEERS & SURVEYORS

1415 East 286th Street  
Wickliffe, Ohio 44092  
(440) 585-9800

This survey is a boundary survey prepared in accordance with Chapter 4733-37, Ohio Administrative Code. The basis of bearings for this survey is North 42°-43'-30" West as the centerline of Silver Street, as evidenced by monuments found, and is the same bearing as found in Volume H of Maps, Pages 61 and 62 of Lake County Records. Distances are given in feet and decimal parts thereof. All iron pins shown as set are 5/8-inch diameter x 30-inch in length iron rebar with a plastic identification cap stamped "McSTEEN CA 96-026". All iron pins set from prior survey are 5/8-inch diameter x 30-inch in length iron rebar with a plastic identification cap stamped "McSTEEN 7104".

  
ROBERT A. DORNER  
REG. PROF. SURV. No. 6943  
Job No.: 12-207  
Field Date: September 13, 2012  
Survey Date: October 8, 2012  
Reference Job No.: 09-150

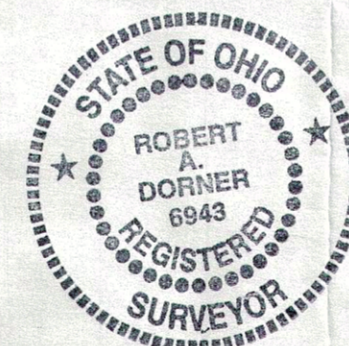

SURVEY AREA TABULATION

SURVEY PARCEL No. 1 .....	29,753 SQUARE FEET (0.683 ACRE)
SURVEY PARCEL No. 2 .....	72,897 SQUARE FEET (1.673 ACRE)
SURVEY PARCEL No. 3 .....	76,568 SQUARE FEET (1.758 ACRE)
SURVEY PARCEL No. 4 .....	90,079 SQUARE FEET (2.068 ACRES)
SURVEY PARCEL No. 5 .....	87,767 SQUARE FEET (2.015 ACRES)
SURVEY PARCEL No. 6 .....	94,563 SQUARE FEET (2.171 ACRES)
SURVEY PARCEL No. 7 .....	12,414 SQUARE FEET (0.285 ACRE)
-----	
TOTAL AREA .....	464,041 SQUARE FEET (10.653 ACRES)