

**PLAT OF CONSOLIDATION  
OF LANDS OF  
THE CITY OF WICKLIFFE**

BEING PARTS OF  
THE SHAKER VINEYARDS LAND COMPANY'S EUCLID AVENUE SUBDIVISION  
RECORDED IN VOLUME 69, PAGE 2 OF LAKE COUNTY PLAT RECORDS  
SITUATED IN THE CITY OF WICKLIFFE  
LAKE COUNTY, OHIO

MARCH 18, 2020 SCALE 1" = 60'

**APPROVALS**

APPROVED BY THE CITY OF WICKLIFFE ENGINEER THIS  
13<sup>TH</sup> DAY OF MARCH, 2020.

BY:   
PETER J. FORMICA, P.E.  
CITY ENGINEER

APPROVED BY THE MAYOR OF THE CITY OF WICKLIFFE  
THIS 14<sup>TH</sup> DAY OF MARCH, 2020.

BY:   
JOHN A. BARBISH,  
MAYOR

**CERTIFICATION**

THIS PLAT WAS PREPARED BY ME AND IS TRUE AND CORRECT TO THE BEST OF MY KNOWLEDGE AND BELIEF. DIMENSIONS SHOWN HEREON ARE EXPRESSED IN FEET AND DECIMAL PARTS THEREOF. BEARINGS SHOWN HEREON ARE BASED UPON THOSE FOUND ON PLAT RECORDED IN VOLUME 69, PAGE 2 OF LAKE COUNTY PLAT RECORDS. NO. 5 REINFORCING BARS 30" LONG AND CAPPED "CT CONSULTANTS INC." HAVE BEEN PLACED AT ALL POINTS MARKED "I.P. SET."

BY:   
TIMOTHY P. HADDEN  
OHIO REGISTERED SURVEYOR NO. 6786

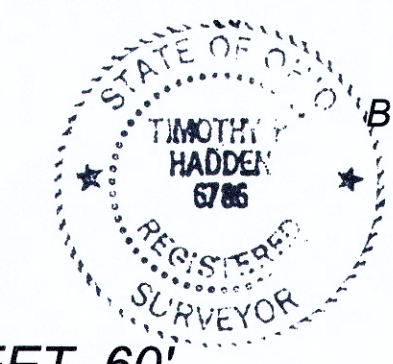

**AREA TABULATION**

FROM PPN 29-A-004-E-00-032-0	(DOC. 2020R006523)	3,540 SQ. FT.	(0.0813 AC.)
FROM PPN 29-A-004-E-00-054-0	(DOC. 2020R006522)	2,437 SQ. FT.	(0.0560 AC.)
AREA IN PPN 29-A-004-E-00-025-0		94,655 SQ. FT.	(2.173 AC.)
AREA IN PPN 29-A-004-E-00-031-0		120,145 SQ. FT.	(2.758 AC.)
AREA IN PPN 29-A-004-E-00-062-0		100,167 SQ. FT.	(2.300 AC.)
AREA IN CONSOLIDATED PARCEL NO. 1		320,944 SQ. FT.	(7.368 AC.)



110219180712SURVEY118012-CONSOLIDATION.DWG - CONSOL. 1 - 3/18/2020 11:52:31 AM - TIM HADDEN