

BASIS OF BEARINGS ARE TO AN ASSUMED MERIDIAN ALONG THE CENTERLINE OF LLOYD ROAD NORTH 27°53'00" WEST

RESURVEY OF LANDS

ALL THAT CERTAIN LANDS SITUATE IN LOT 4, TRACT 12, IN THE CITY OF WICKLIFFE, TOWNSHIP NUMBER 9 NORTH, RANGE IX WEST, IN THE CONNECTICUT WESTERN RESERVE SURVEY, COUNTY OF LAKE, STATE OF OHIO. A RESURVEY OF THE LANDS TO EDWARD G. & LIZZETTE STUCKERT, AS RECORDED IN DEED VOLUME 891, PAGE 384 (PPN 29A-02G-015), IN THE OFFICE OF THE COUNTY RECORDER.

REFERENCES

-DEEDS OF RECORD

LEGEND

- 5/8" IRON PIN FOUND/SET
- ⊙ IRON PIPE
- STONE MONUMENT
- ⊠ MONUMENT BOX
- ⊙ P.K. NAIL FOUND/SET
- DRILL HOLE FOUND
- CALC CALCULATED
- MEAS MEASURED
- OBS OBSERVED
- DEED DEED RECITED
- PLAT PLAT RECITED



SCALE: 1" = 30'

MAY 11, 2005

ALL IRON PIN SET ARE 5/8" X 30" REBAR WITH CAP "CRABBS 7245".

PREPARED FOR: - EDWARD & LIZZETTE STUCKERT -	PROJECT NAME: RESURVEY OF LANDS	PROJECT ADDRESS: 867 LLOYD ROAD WICKLIFFE, OHIO
	PROJECT LOCATION: LAKE COUNTY, OHIO	JOB NUMBER: 3789
FOR INQUIRIES CONCERNING THIS SURVEY CONTACT:		CHK: T. STOCKER
CSS CRABBS' SURVEYING SERVICE 10 WEST ERIE STREET, SUITE 101 PAINESVILLE, OHIO 44077 1-800-488-3968	DRN: S. LOVEJOY	PAGE 1 OF 1
	REV:	

THIS SURVEY WAS PERFORMED TO AN ACCURACY OF ± 0.01 FEET IN THE 2003 OHIO ADMINISTRATIVE CODE 4733-37.

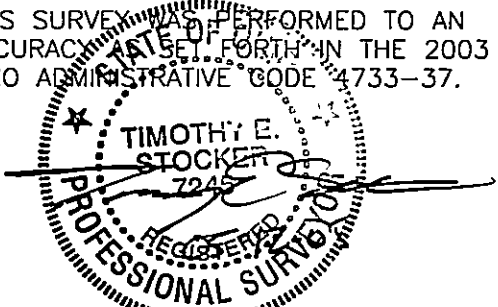

TIMOTHY E. STOCKER, P.S. 7245