

SOM CENTER ROAD  
S.R. 91 - 80' RW

N 01°11'52" W  
125.00' DEED OBS

0.1148 AC IN RW

#5769  
J.M. OCKULY  
DOC. 2010R002869  
PPN 27-A-004-0-00-014-0

N 88°45'41" E  
309.29' OBS - 310' DEED

5/8" IRON PIN FOUND  
& USED AT 39.54' CL

3/4" IRON PIPE  
FOUND & USED

0.8872 ACRES  
#5777  
BRIDGETTE HALE  
DOC. 2006R014910  
PPN 27-A-004-0-00-031-0

124.86' OBS - 125' DEED  
S 01°14'19" E

5/8" IRON PIN FOUND  
& USED AT 39.58' CL

5/8" IRON PIN  
FOUND & USED

309.38' OBS - 310' DEED  
S 88°44'10" W

#5805  
V. VITALONE  
DOC. 2012R002453  
PPN 27-A-004-0-00-035-0

POB

N 01°11'52" W  
1056.03' OBS

144.63' OBS

5/8" IRON PIN FOUND  
& USED AT 39.04' CL

NOTES & REFERENCES

- DEEDS OF RECORD
- OCCUPATION AGREES WITH TITLE LINES AS PREVIOUSLY MONUMENTED EXCEPT AS SHOWN ON THIS PLAT



SCALE: 1" = 50'  
SURVEY: OCTOBER 15, 2017  
MAP: OCTOBER 25, 2017

RESURVEY OF LANDS

ALL THAT CERTAIN LANDS SITUATE IN LOT 10, TRACT 10, CITY OF WILLOUGHBY, TOWNSHIP NUMBER 9 NORTH, RANGE X WEST, IN THE CONNECTCUT WESTERN RESERVE SURVEY, COUNTY OF LAKE, STATE OF OHIO. A RESURVEY OF THE LANDS TO BRIDGETTE HALE, AS RECORDED IN DOCUMENT NUMBER 2006R014910 (PPN 27-A-004-0-00-031-0) IN THE OFFICE OF THE COUNTY RECORDER.

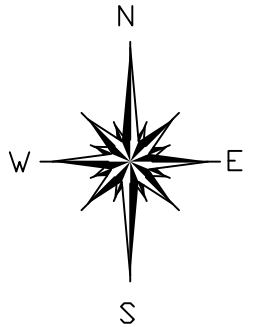

BASIS OF BEARINGS ARE TO AN ASSUMED MERIDIAN ALONG THE CENTERLINE OF SOM CENTER ROAD NORTH 01°-11'-52" WEST

LEGEND

- IRON PIN FOUND/SET
- ⊙ IRON PIPE
- STONE MONUMENT
- ⊠ MONUMENT BOX
- ⊕ P.K. NAIL FOUND/SET
- DRILL HOLE FOUND
- CALC CALCULATED
- MEAS MEASURED
- OBS OBSERVED
- DEED DEED RECITED
- PLAT PLAT RECITED

THIS SURVEY WAS PERFORMED TO AN ACCURACY AS SET FORTH IN THE 2003 OHIO ADMINISTRATIVE CODE 4733-37.

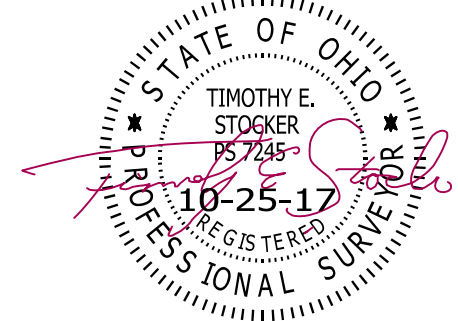

TIMOTHY E. STOCKER, P.S. 7245

PREPARED FOR:  BRIDGETTE HALE	PROJECT NAME: RESURVEY OF LANDS	PROJECT ADDRESS: 5777 SOM CENTER RD WILLOUGHBY, OHIO
	PROJECT LOCATION: LAKE COUNTY, OHIO	JOB NUMBER: 6917
FOR INQUIRIES CONCERNING THIS SURVEY CONTACT:  <b>CSS</b> CRABBS' SURVEYING SERVICE P.O. BOX 908 PAINESVILLE, OHIO 44077 1-800-488-3968		CHK: T. STOCKER DRN: S. HUPERTZ REV: PAGE 1 OF 1

1" IRON PIN FOUND & USED WITHIN A MON BOX ASSEMBLY

RIDGE ROAD  
S.R. 84 - VARIABLE WIDTH