

BEARINGS ARE PER THE CENTERLINE BEARING OF LITTLE MOUNTAIN ROAD (S68°32'00"E) PER THE BOUNDARY SURVEY BY RALPH GROMLEY-AZTECH ENGINEERING & SURVEYING DATED FEBRUARY 17, 2004 AND ARE USED TO DENOTE ANGLES ONLY.

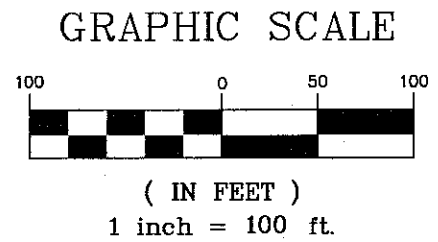

LEGEND:
 ○ = IP FOUND
 ● = IP FOUND
 ⊙ = IP SET
 5/8"x30" REBAR CAPPED "AZTECH 8249"

▨ = GRAVEL DRIVE AREA OVER P/L

REFERENCES:
 BOUNDARY SURVEY BY RALPH GROMLEY AZTECH ENGINEERING & SURVEYING DATED FEBRUARY 17, 2004
 BOUNDARY SURVEY BY TIMOTHY STOCKER CRABBS' SURVEYING SERVICE DATED OCTOBER 9, 2019
 LOT CONSOLIDATION SURVEY AZTECH ENGINEERING & SURVEYING DATED APRIL, 2021

APPROVALS

MAYOR _____ DATE _____
 LAW DIRECTOR _____ DATE _____

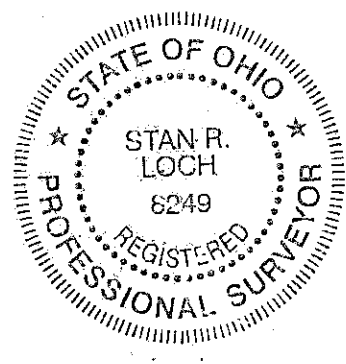

I CERTIFY THAT I HAVE SURVEYED THE PREMISES AND PREPARED THE SURVEY MAP IN ACCORDANCE WITH THE PROVISIONS OF CHAPTER 4733-37 OF THE OHIO ADMINISTRATIVE CODE.

STAN R. LOCH
 REG SURVEYOR #8249
 DATE 11.8.21

5425 WARNER ROAD - SUITE 12
 VALLEY VIEW, OHIO 44125
 440-602-9071



ENGINEERING and SURVEYING
 Civil Engineering · Land Surveying

SHEET CONTENT

LOT SPLIT SURVEY FOR
DONNA KNAPP
 BEING DOC. NOS. 2021R018176
 PART OF LOTS 4 & 11
 TRACT 1
 VILLAGE OF KIRTLAND HILLS
 LAKE COUNTY
 STATE OF OHIO

REVISIONS			
NO.	DATE	DESCRIPTION	BY
1	9/22/21	REVISED PER VILLAGE	CL
2	11/8/21	REVISED LOT SPLIT PL	CL

HORIZ. SCALE		VERT. SCALE	
1" = 100'			
DRAWN BY CL	DATE 8/11/2021	CHECKED BY SRL	DRAWING NO 2021 LOT SPLIT
JOB NO 131497	SHEET 1 OF 1		