

RESURVEY OF LANDS

ALL THAT CERTAIN LANDS SITUATE IN LOT 87, TRACT 3, CITY OF KIRTLAND, TOWNSHIP NUMBER 9 NORTH, RANGE IX WEST, IN THE CONNECTICUT WESTERN RESERVE SURVEY, COUNTY OF LAKE, STATE OF OHIO. A RESURVEY OF THE LANDS TO KARL E. & GRETCHEN A. MANSFIELD, AS RECORDED IN DOCUMENT NUMBER 2006R034353 (PPN 20-A-024-000-036-0) IN THE OFFICE OF THE COUNTY RECORDER.

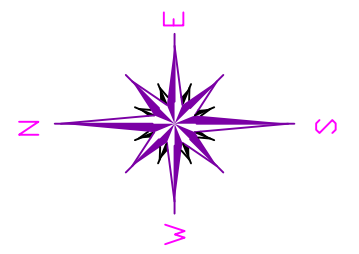

BASIS OF BEARINGS ARE TO AN ASSUMED MERIDIAN ALONG THE CENTERLINE OF EUCLID CHARDON ROAD NORTH 68°-27'-58" EAST



SCALE: 1" = 60'
 SURVEY: FEBRUARY 24, 2020
 MAP: FEBRUARY 26, 2020

LEGEND

- IRON PIN FOUND/SET
- ⊙ IRON PIPE
- STONE MONUMENT
- ⊠ MONUMENT BOX
- ⊕ P.K. NAIL FOUND/SET
- DRILL HOLE FOUND
- CALC CALCULATED
- MEAS MEASURED
- OBS OBSERVED
- DEED DEED RECITED
- PLAT PLAT RECITED

NOTES & REFERENCES

- ALL IRON PIN SET ARE 5/8" X 30" REBAR WITH CAP "CRABBS 7245".
- DEEDS OF RECORD
- OCCUPATION AGREES WITH TITLE LINES AS PREVIOUSLY MONUMENTED EXCEPT AS SHOWN ON THIS PLAT

THIS SURVEY WAS PERFORMED TO AN ACCURACY AS SET FORTH IN THE 2003 OHIO ADMINISTRATIVE CODE 4733-37.

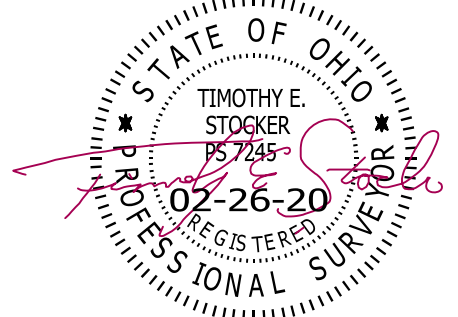

TIMOTHY E. STOCKER, P.S. 7245

#7114
 G.W. CLEVELAND
 DOC. 2017R002016
 PPN 20-A-024-0-00-010-0

S 01°21'09" E
 470.80' OBS - 471.35' DEED

1.1019 ACRES
 #7100
KARL E. & GRETCHEN A. MANSFIELD
 DOC. 2006R034353
 PPN 20-A-024-0-00-036-0

S 01°18'23" E
 351.11' OBS

1" IRON PIPE FOUND & USED

F.G. RAISHART, ET AL
 DOC. 2009R015821
 PPN 20-A-024-0-00-033-0

#7090
 B.J. MORVAJO, ET AL
 DOC. 2013R024549
 PPN 20-A-024-0-00-032-0

PREPARED FOR: KARL E. & GRETCHEN A. MANSFIELD	PROJECT NAME: RESURVEY OF LANDS	PROJECT ADDRESS: 7100 EUCLID CHARDON KIRTLAND, OHIO
	PROJECT LOCATION: LAKE COUNTY, OHIO	JOB NUMBER: 7666
FOR INQUIRIES CONCERNING THIS SURVEY CONTACT: CSS CRABBS' SURVEYING SERVICE P.O. BOX 908 PAINESVILLE, OHIO 44077 1-800-488-3968		CHK: T. STOCKER DRN: S. HUPERTZ REV: PAGE 1 OF 1