

# Plat of Survey

for

**David Laguardia**

7633 Salida Road

Lot No. 6, Tract No. 16

Mentor-On-the-Lake - Lake County - Ohio

July 2018 Scale 1"=60'

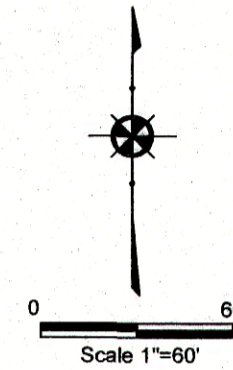

## NOTES:

This plat was prepared without the benefit of an abstract of title and is subject to any state of facts revealed by a examination of the same.

Documents used in preparation of this survey are cited on the plat.

Occupation is consistent with the title lines except where noted on survey.

Size of monumentation found or set is noted on plat.

All iron pins set are 5/8" x 30" and are capped H. JONES PLS6343

Bearings are based upon the centerline of Salida Road as being North 73°09'00" East and are used to describe angles only.

*Harry S. Jones Jr.* #6343 7/23/18  
 Harry S. Jones Jr. P.S. #6343 Date

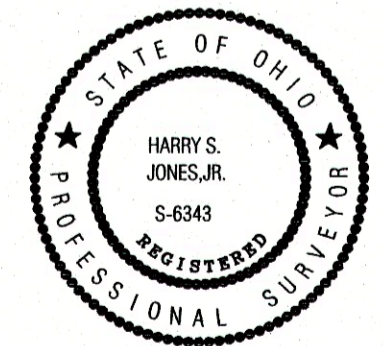

REVISIONS			Jones Surveying, LLC	
NO.	DATE	BY	SCALE	PHONE NO.
1		CAD	1"=60'	440-357-1811
2		CAD		
3		DRAWN BY GMB	DATE 7/23/2018	DRAWING NO. 18-164
4		CHKD. HSJ	APPD	
5		CREW CHIEF		

ENGINEERS - SURVEYORS - PLANNERS  
 1924 MENTOR AVE., PAINESVILLE, OHIO  
 (PH.) 440-357-1811 (FAX) 440-357-9173  
 (E-MAIL) hjonesurveying@yahoo.com