

# LOT LINE ADJUSTMENT

for

## EMERALD MENTOR LLC

BEING PART OF ORIGINAL LOT NO. 3, TRACT NO. 4 IN ORIGINAL MENTOR TOWNSHIP

NOW IN THE

CITY OF MENTOR  
COUNTY OF LAKE - STATE OF OHIO

by

**McSTEEN & ASSOCIATES, INC.**

ENGINEERS & SURVEYORS  
26451 Curtiss Wright Parkway  
Richmond Heights, Ohio 44143  
(216) 797-9800

Bearings shown hereon are to an assumed meridian and are used to denote angles only. Distances are given in feet and decimal parts thereof. All iron pins shown as set are 30" long 1/2" rebar with an identification cap stamped "McSteen & Assoc."

The undersigned hereby certify that these drawings accurately show the buildings as constructed.



*Timothy J. Feller*  
TIMOTHY J. FELLER REG. PROF. SURVEYOR # 7104  
JOB No. 00-158

Date: 11-29-01

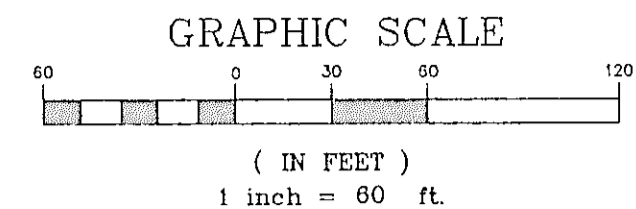

Ⓐ  
R = 20.00'  
J = 91'14"04"  
A = 31.85'  
C = 28.59'  
S 41'17"58" E

Ⓑ  
R = 30.00  
J = 42'47"38"  
A = 22.41'  
C = 21.89'  
N 62'32"14" W

Ⓒ  
R = 200.00  
J = 25'00"00"  
A = 87.27  
C = 86.58'  
N 83'33"57" E

### APPROVALS

This drawing is hereby accepted by Ronald M. Traub Director of Community Development for the City of Mentor, this 13<sup>th</sup> day of Dec. 2001.

*Ronald M. Traub*  
City of Mentor  
Ronald M. Traub  
Director, Community Development

This drawing is hereby accepted by John W. Konrad City Engineer for the City of Mentor, this 13<sup>th</sup> day of Dec. 2001.

*John W. Konrad*  
City of Mentor  
John W. Konrad  
City Engineer

RECEIVED FOR RECORD

# 200154674

AT 2:57 AM/PM

RECORDERS FEE 27.00

Vol. 41 Page 16

FRANK A. SUPONCIC  
Lake County Recorder

5/8" PIN MON BOX

1/2" IRON PIN SET No. 7104 REC. & USED

1/2" IRON PIN SET No. 7104

1/2" IRON PIN SET No. 7104

1/2" IRON PIN SET No. 7104

1/2" IRON PIN SET No. 7104

1/2" IRON PIN SET No. 7104

1/2" IRON PIN SET No. 7104

1/2" IRON PIN SET No. 7104

1/2" IRON PIN SET No. 7104

1/2" IRON PIN SET No. 7104

1/2" IRON PIN SET No. 7104

1/2" IRON PIN SET No. 7104

1/2" IRON PIN SET No. 7104

1/2" IRON PIN SET No. 7104

1/2" IRON PIN SET No. 7104

1/2" IRON PIN SET No. 7104

1/2" IRON PIN SET No. 7104

1/2" IRON PIN SET No. 7104

1/2" IRON PIN SET No. 7104

## LANMARK DRIVE 65'

PUBLIC RIGHT-OF-WAY

VOL.17, PG. 21 L.C.M.R.

1630.10' DEED & USED

50.00'

88'45"56"

50.00'

353.47'

79.17'

30'

30'

30'

30'

30'

30'

30'

30'

30'

30'

30'

30'

30'

30'

30'

30'

30'

30'

30'

30'

30'

30'

30'

30'

30'

SUBLOT 205 HOME TOWN PARK SUBDIVISION No. 3 VOLUME 0, PAGE 6  
SUBLOT 206  
SUBLOT 207 N 03°02'42" E  
SUBLOT 208 374.30' ACT. 374.32' DEED  
SUBLOT 209  
SUBLOT 210  
SUBLOT 212

LANMARK WOODS SUBDIVISION VOLUME 17, PAGE 21

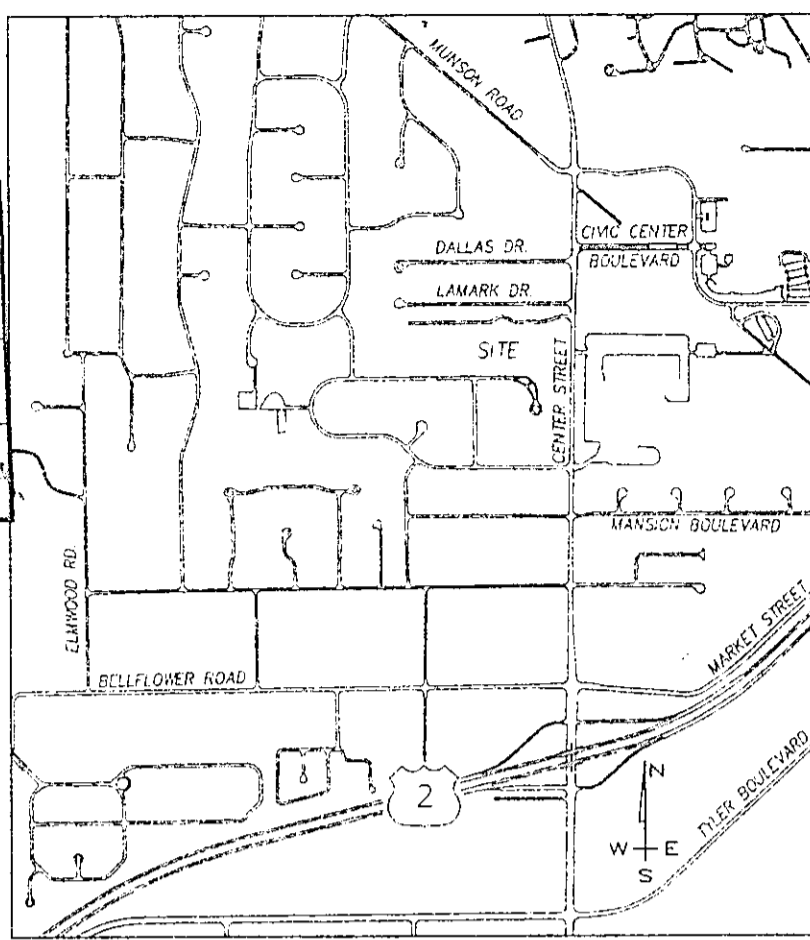

VICINITY MAP  
NO SCALE

5/8" PIN MON BOX

1/2" PIN FOUND  
0.77' S  
2.28' E

1/2" IRON PIN SET No. 7104

1/2" IRON PIN SET No. 7104

1/2" IRON PIN SET No. 7104

1/2" IRON PIN SET No. 7104

1/2" IRON PIN SET No. 7104

1/2" IRON PIN SET No. 7104

1/2" IRON PIN SET No. 7104

1/2" IRON PIN SET No. 7104

1/2" IRON PIN SET No. 7104

1/2" IRON PIN SET No. 7104

1/2" IRON PIN SET No. 7104

1/2" IRON PIN SET No. 7104

1/2" IRON PIN SET No. 7104

1/2" IRON PIN SET No. 7104

1/2" IRON PIN SET No. 7104

1/2" IRON PIN SET No. 7104

1/2" IRON PIN SET No. 7104

S 86°55'00" E

LOT "A"  
4.2520 ACRES

LOT "B"  
7.6745 ACRES

EMERALD MENTOR LLC  
P.P. No. 16C-084-20

EMERALD MENTOR LLC  
P.P. No. 16C-084-12

2.1448 ACRES

5.5297 ACRES

145.00' AREA  
0.1138 ACRES

PHASE 2  
HEATHERSTONE CONDOMINIUM  
VOL. 41 PAGE 14  
AREA  
0.6439 ACRES

PHASE 1  
HEATHERSTONE CONDOMINIUM  
VOL. 40 PAGE 21

EXCEPTION: TO CITY OF MENTOR  
Doc. No. 990048848  
S 04°19'04" W  
374.88' DEED & USED

(S.R. 615) PUBLIC RIGHT-OF-WAY  
CENTER STREET

SUBLOT 214 SUBLOT 215 SUBLOT 216 SUBLOT 217 SUBLOT 218 SUBLOT 219 SUBLOT 220 SUBLOT 221 SUBLOT 222 SUBLOT 223 SUBLOT 224

HOME TOWN PARK SUBDIVISION No. 4  
VOLUME 0, PAGE 41

CENTER POINT SUBDIVISION  
VOLUME 3, PAGE 13

Flat Approved  
For Recording  
Lake County Engineer

By *Richard R. Negfield* Date 12-26-2001