

16c-84-12,20

MAP OF SURVEY of LAFAYETTE VILLA

Situated in the:
CITY OF MENTOR
COUNTY OF LAKE - STATE OF OHIO

by
McSTEEN & ASSOCIATES, INC.
ENGINEERS & SURVEYORS
26451 Curtiss Wright Parkway
Richmond Heights, Ohio 44143
(216) 797-9800

Bearings shown hereon are to an assumed meridian and are used to denote angles only. Distances are given in feet and decimal parts thereof. All iron pins shown as set are 30" long 1/2" rebar with an identification cap stamped "McSteen & Assoc".

[Signature] 1.9.01
TIMOTHY J. FELLER REG. PROF. SURVEYOR # 7104
JOB No. 00-158

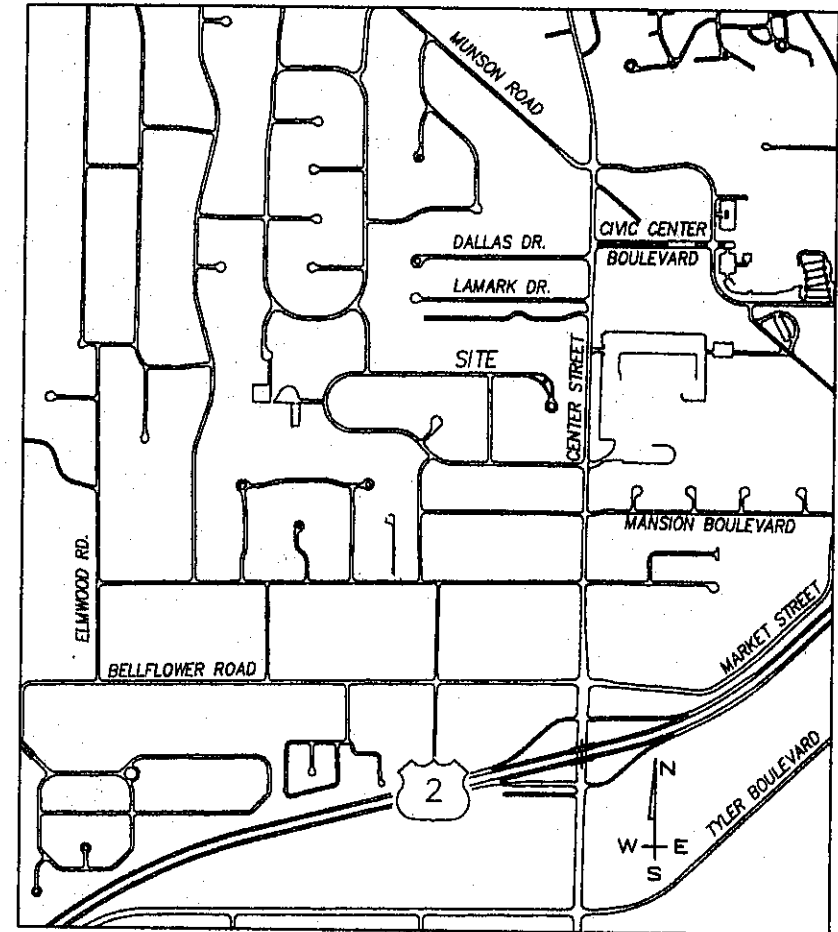
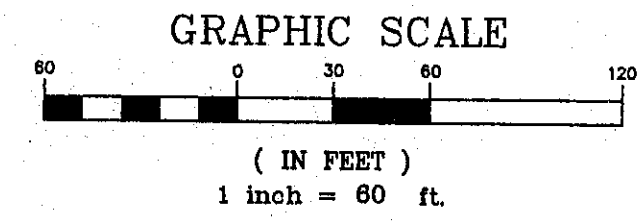

VICINITY MAP
NO SCALE

SUBLOT 205 HOME TOWN PARK SUBDIVISION No. 3
VOLUME 0, PAGE 6
SUBLOT 206 ACT. 374.32' DEED
SUBLOT 207 374.30'
SUBLOT 208 N 03702'42" E
SUBLOT 209
SUBLOT 210
SUBLOT 212

LANMARK WOODS SUBDIVISION
VOLUME 17, PAGE 21

5/8" PIN
MON BOX

PRINCIPAL PLACE
OF BEGINNING

5/8" PIN
MON BOX

LANMARK DRIVE 65'
PUBLIC RIGHT-OF-WAY

S 86°55'00" E

1569.67'

1630.10' DEED & USED

50.00'
88°45'56"
REC. & USED

5/8" PIN
FOUND
0.07' S
2.28' W

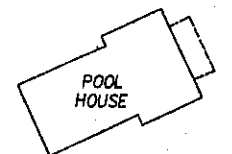

2 STORY
BRICK &
FRAME
BUILDING

2 STORY
BRICK &
FRAME
BUILDING

2 STORY
BRICK &
FRAME
BUILDING

16 C 084 0 00 020 0

R=20.00
S 41° 15' 58" E
28.50' rad.
31.85' Arc.

333.47'
S 04°19'04" W
373.68' DEED & USED

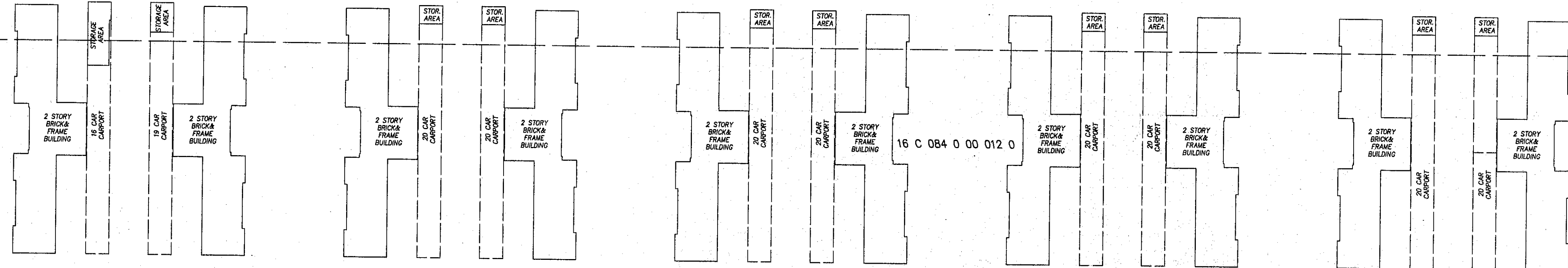

EXCEPTION: TO CITY OF MENTOR
Doc. No. 990045948

CENTER STREET
PUBLIC RIGHT-OF-WAY
(S.R. 615)

N 86°56'03" W

1581.80'

1621.81' OBS. 1621.46' DEED

1/2" IRON PIN
SET "McSTEEN"
(TYPICAL)

HOME TOWN PARK SUBDIVISION No. 4
VOLUME 0, PAGE 41

CENTER POINTE SUBDIVISION
VOLUME 3, PAGE 13