

BASIS OF BEARINGS ARE TO AN ASSUMED MERIDIAN ALONG THE CENTERLINE OF S STATE STREET NORTH 25°-49'-32" WEST

RESURVEY OF LANDS

ALL THAT CERTAIN LANDS SITUATE IN LOT 14, TRACT 2, CITY OF PAINESVILLE, TOWNSHIP NUMBER 11 NORTH, RANGE VIII WEST, IN THE CONNECTICUT WESTERN RESERVE SURVEY, COUNTY OF LAKE, STATE OF OHIO. A RESURVEY OF THE LANDS TO ROBERT A. TENNEY, AS RECORDED IN DOCUMENT NUMBER 2001R051553, (PPN 15-B-009-0-00-049-0), IN THE OFFICE OF THE COUNTY RECORDER.

THIS SURVEY WAS PERFORMED TO AN ACCURACY AS SET FORTH IN THE 2003 OHIO ADMINISTRATIVE CODE 4733-37.

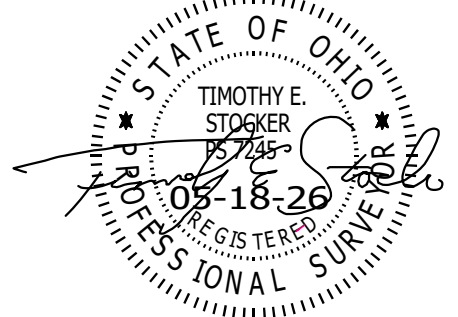

TIMOTHY E. STOCKER, P.S. 7245

PREPARED FOR: ROBERT A. TENNEY	PROJECT NAME: RESURVEY OF LANDS	PROJECT ADDRESS: 524 S STATE STREET PAINESVILLE, OHIO
	PROJECT LOCATION: LAKE COUNTY, OHIO	JOB NUMBER: 10735
FOR INQUIRIES CONCERNING THIS SURVEY CONTACT:  CRABBS' SURVEYING SERVICE P.O. BOX 908 PAINESVILLE, OHIO 44077 440-466-2025 / 440-357-5941 crabbssurveyinginc@gmail.com www.crabbssurveying.com		CHK: T. STOCKER, SR, P.S. CHK: T. STOCKER, JR, P.S. DRN: S. LOVEJOY REV: PAGE 1 OF 1

