

**NOTES:**  
 This plat was prepared without the benefit of an abstract of title and is subject to any state of facts revealed by a examination of the same.

Documents used in preparation of this survey are cited on the plat.

Occupation is consistent with the title lines except where noted on survey.

Size of monumentation found or set is noted on plat.

Bearings are based upon the centerline of Richmond Road being South 86°55'05" East and are used to describe angles only.

TOTAL 8.519 Ac.  
 STATE ROUTE 2 3.584 Ac.  
 NET 4.935 Ac.

THEODORE GROVER DANIELS, TRUSTEE  
 2013R021568  
 11B-68-5

SUBJECT PROPERTY IS ZONED  
 "I-2 HEAVY INDUSTRIAL"

MAPLEVIEW VILLAGE LLC  
 2012R021634  
 11B-68-4

CITY OF PAINESVILLE  
 0030/0004  
 Vol. 30, Page 4

**SURVEY CERTIFICATION**

I hereby certify that this plat was prepared from a field survey made under my direct supervision. Monuments were found or set as indicated. Dimensions are expressed in feet and decimal parts thereof. All of which are correct to the best of my knowledge and belief. This plat was prepared in accordance with the provisions of Chapter 4733-37 of the Ohio Administrative Code. All Iron Pins Set are 5/8" x 30" long rebar and capped "H. Jones - 6343".

*Harry S. Jones Jr.*  
 Harry S. Jones Jr. P.S. #6343

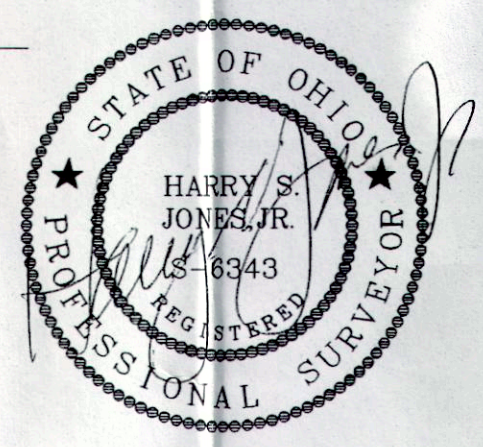

1/30/14

**Jones Surveying, LLC**  
 ENGINEERS - SURVEYORS - PLANNERS  
 1924 MENTOR AVE., PAINESVILLE, OHIO 440-357-1811  
 440-357-9173 (FAX) njonesurveying@yahoo.com

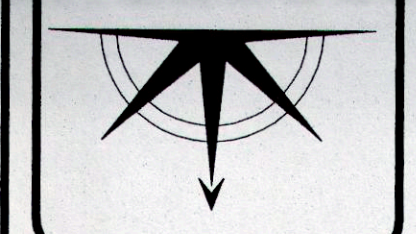

Date: 1/29/14  
 Scale: Hor. 1"=80'  
 Vert.  
 Filename: 12-151rev  
 Tab Name: 12-151  
 Computer: GMB

**SURVEY PLAT**  
 PART OF LOT 11, TRACT 4  
 PAINESVILLE TWP. - LAKE COUNTY - OHIO

Sheet 1 of 1  
 Contract No. 12-151