

HALE ROAD

60' RW

RESURVEY OF LANDS

ALL THAT CERTAIN LANDS SITUATE IN A PORTION OF SUBLot 25, AS ILLUSTRATED IN FRUITLAND ACRES SUBDIVISION, RECORDED IN PLAT VOLUME F, PAGE 73 AND IN LOTS 13 & 14, TOWNSHIP OF PAINESVILLE, TOWNSHIP NUMBER 11 NORTH, RANGE VII WEST, IN THE CONNECTCUT WESTERN RESERVE SURVEY, COUNTY OF LAKE, STATE OF OHIO. A RESURVEY OF THE LANDS TO MEGAN C. MOORE, AS RECORDED IN DOCUMENT NUMBER 2012R018526 (PPN 11-B-032-A-00-021-0) IN THE OFFICE OF THE COUNTY RECORDER.



BASIS OF BEARINGS ARE TO AN ASSUMED MERIDIAN ALONG THE CENTERLINE OF FRUITLAND AVENUE NORTH 00°-51'-11" WEST

NOTES & REFERENCES

- ALL IRON PIN SET ARE 5/8" X 30" REBAR WITH CAP "CRABBS 7245".
- DEEDS OF RECORD
- PLAT VOL. F, PG. 73
- OCCUPATION AGREES WITH TITLE LINES AS PREVIOUSLY MONUMENTED EXCEPT AS SHOWN ON THIS PLAT

LEGEND

- IRON PIN FOUND/SET
- ⊙ IRON PIPE
- STONE MONUMENT
- ⊗ MONUMENT BOX
- ⊕ P.K. NAIL FOUND/SET
- DRILL HOLE FOUND
- CALC CALCULATED
- MEAS MEASURED
- OBS OBSERVED
- DEED DEED RECITED
- PLAT PLAT RECITED

THIS SURVEY WAS PERFORMED TO AN ACCURACY AS SET FORTH IN THE 2003 OHIO ADMINISTRATIVE CODE 4733-37.

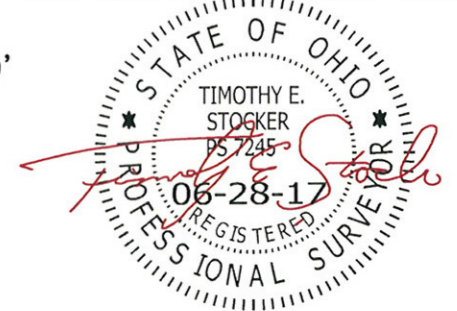

TIMOTHY E. STOCKER, P.S. 7245



SCALE: 1" = 40'

SURVEY: JUNE 22, 2017

MAP: JUNE 28, 2017

FRUITLAND AVENUE

50' RW

S 00°51'11" E

1956.75' OBS

81.75' DEED MEAS

N 00°51'11" W

131.50' DEED MEAS

0.0736 AC IN RW

POB

CAPPED 5/8" IRON PIN SET AT 25.00' CL

CAPPED 5/8" IRON PIN SET AT 25.86' CL

3/4" IRON PIPE FOUND & USED AT 25.07' CL

#175
A. TOREKI
VOL. 181, PG. 1014
PPN 11-B-032-A-00-043-0

N 89°14'03" E
281.61' OBS - 282.15' DEED

0.6078 ACRES
#179
MEGAN C. MOORE
DOC. 2012R018526
PPN 11-B-032-A-00-021-0

S/L 23

S/L 25

LOT 13
LOT 14

3/4" IRON PIPE FOUND & USED

FRUITLAND ACRES PLAT VOL. F, PG. 73

81.75' OBS

J.V. STROPKEY
DOC. 2000R026961
PPN 11-B-032-D-00-001-0

CAPPED 5/8" IRON PIN SET

56.58' OBS
S 00°45'57" E

CAPPED 5/8" IRON PIN SET

ITEM OF INTEREST
SUBJECTS HOUSE IS OVER THE LINE AS SHOWN

291.21' OBS
S 74°19'31" W
CSX TRANSPORTATION INC
PPN 11-B-999-00-00-200-A

PREPARED FOR: MEGAN C. MOORE	PROJECT NAME: RESURVEY OF LANDS	PROJECT ADDRESS: 179 FRUITLAND AVENUE PAINESVILLE, OHIO
	PROJECT LOCATION: LAKE COUNTY, OHIO	JOB NUMBER: 6810
FOR INQUIRIES CONCERNING THIS SURVEY CONTACT: CSS CRABBS' SURVEYING SERVICE P.O. BOX 908 PAINESVILLE, OHIO 44077 1-800-488-3968		CHK: T. STOCKER DRN: S. HUPERTZ REV: PAGE 1 OF 1