

# SKETCH TO ACCOMPANY LEGAL DESCRIPTION

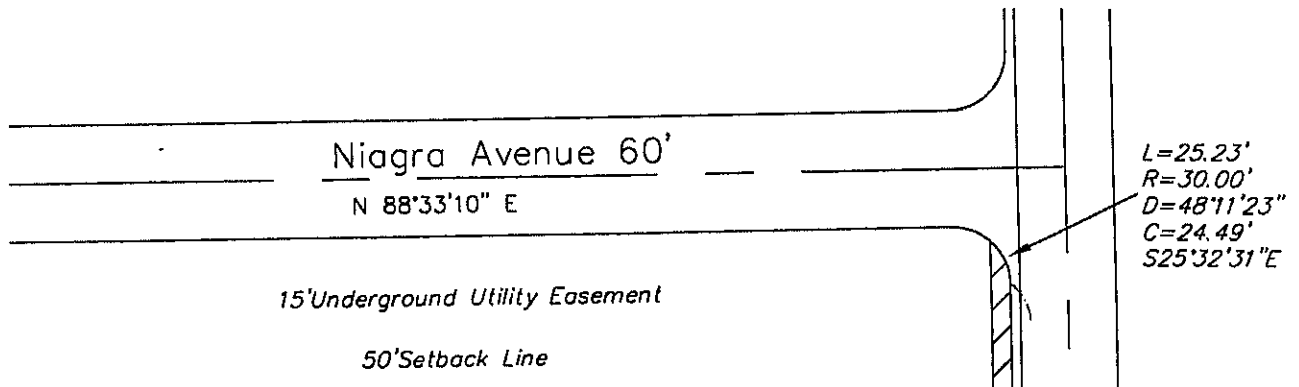

WIND POINT RESERVE  
INDUSTRIAL SUBDIVISION  
VOL.39 PAGE 5  
L.C.P.R.

Sublot #2  
23.8302 Acres

10' ROADWAY ACQUISITION NO.1

9,145 SQUARE FEET  
0.2099 ACRES

SCALE: 1 INCH = 100 FEET  
BASIS OF BEARING: PLAT FOR  
WIND POINT RESERVE INDUSTRIAL SUBDIVISION  
VOL.39 PAGE 5 L.C.P.R.



NO PLAT REQUIRED  
LOT LINE ADJUSTMENT  
Approved by *[Signature]*  
Lake County Planning Commission  
Log No. 238-8 Date 2-26-02

N01°26'50"W 921.36'  
S01°26'50"E 899.00'

Blackmore Road (Width Varies)

30.00' R/W

S88°33'10"W

P.O.B.

10.00'  
P.P.O.B.  
5.00'

25.00' R/W

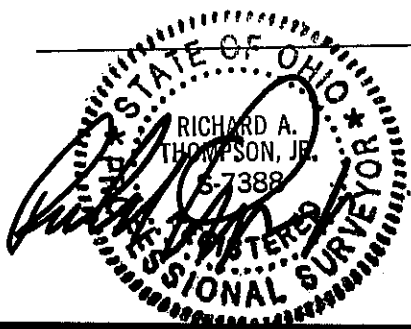

PPN 03A-014-023  
Halcon Rojo, LLC  
Doc. #200008887  
3-15-2000

DEMIR1-9901  
MPS/ROW TAKES.DWG  
06-07-01

3A-14X