

MUSIC EXPRESS BROADCASTING CORP.
OF NORTHEAST OHIO
Vol. 1044-1229
1B-122-61

GERALD & BARBARA KRAUTER, TR.
#2003R018473
1B-122-51

DONALD MAH, TRUSTEE
#2005R019679
1B-122-18

SPLIT "G"
3.4168 AC.

DONALD MAH, TRUSTEE
#2005R018771
1B-122-67

ORIGINAL - 4.6624 AC.
SPLIT "G" - 3.4168 AC.
BALANCE - 1.2456 AC.
R/W - 0.1053 AC.
NET - 1.1403 AC.

ORIGINAL - 1.6772 AC.
SPLIT "B" - 3.4168 AC.
TOTAL - 5.0940 AC.
R/W - 0.0628 AC.
NET - 5.0312 AC.

TOTAL - 1.1720 AC.
R/W - 0.0575 AC.
NET - 1.1145 AC.

TOTAL - 1.2811 AC.
R/W - 0.0630 AC.
NET - 1.2181 AC.

TOTAL - 1.2870 AC.
R/W - 0.0633 AC.
NET - 1.2237 AC.

GERALD & BARBARA KRAUTER, TR.
#2003R018469
1B-122-25

MICHAEL ZINGLEMANN
#2005R005184
1B-122-29

THOMAS & DORIS PERKINS
#2006R001372
1B-122-70

THOMAS & DORIS PERKINS
#2006R001372
1B-122-30

EUGENE MACKEY
#200137460
1B-122-64

GERALD & BARBARA KRAUTER, TR.
#2005R005477
1B-122-72

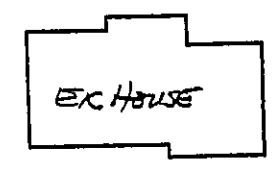

NOTE: ALL IRON PINS SET ARE
5/8" X 30" AND ARE CAPPED
BABCOCK, JONES & ASSOC.

Bearings are based upon the centerline of McMackin Road being North
1°45'00" East and are used to describe angles only.

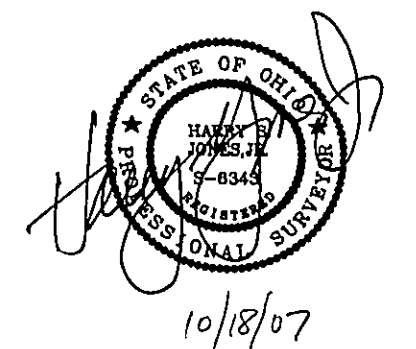
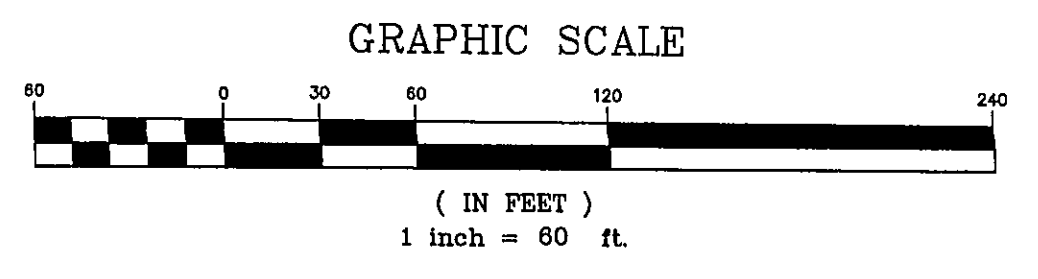

| REV. NO. | DESCRIPTION | DATE | BY | CHK'D |
|----------|--------------------------------|----------|------|-------|
| 1 | REVISED PLAT | 10/27/04 | B.P. | H.J. |
| 2 | REVISED PLAT | 11/9/04 | H.J. | H.J. |
| 3 | ADDED PARCELS A & B TO BALANCE | 12/28/04 | H.J. | H.J. |
| 4 | ADDED EXIST BLDGS TO 29 & 30 | 1/19/05 | B.P. | H.J. |
| 5 | REVISED LOT SPLIT | 10/10/07 | H.J. | H.J. |
| 6 | REVISED BY L.C. ENGINEER | 10/18/07 | H.J. | H.J. |

bj BABCOCK, JONES AND ASSOCIATES, INC
CIVIL ENGINEERS - SURVEYORS - LAND PLANNERS
PAINESVILLE OHIO 44077

DATE 10/26/04
DESIGN BY H.J.
DRAWN BY B.P.
APPROVED BY H.J.
CREW CHIEF W.B.

PLAT OF SURVEY
FOR DON MAH
LOT No. 4 - TRACT No. 4
NORTH RIDGE ROAD & McMACKIN ROAD
MADISON TOWNSHIP LAKE COUNTY STATE OF OHIO

| | |
|--------|-----------|
| SCALE | 1"=60' |
| JOB NO | 00-019-LS |
| SHEET | 1 OF 1 |