

LOT SPLIT OF LANDS

ALL THAT CERTAIN LANDS SITUATE IN LOT 4, TRACT 3, TOWNSHIP OF MADISON, TOWNSHIP NUMBER 11 NORTH, RANGE VI WEST, IN THE CONNECTICUT WESTERN RESERVE SURVEY, COUNTY OF LAKE, STATE OF OHIO. A LOT SPLIT AND REAMINDER OF THE LANDS TO JEFFREY A. CRAFT, AS RECORDED IN DOCUMENT NUMBER 2002R006507, (PPN 01-B-115-0-00-002-0), IN THE OFFICE OF THE COUNTY RECORDER.

ACREAGE SUMMARY

0.7658	ACRES (ORIGINAL)
- 0.2762	ACRES (SPLIT)
= 0.4896	ACRES (REMAINDER)

CURVE DATA

C 1 A=429.82' R=1330.00' Δ=18°30'59" S 70°49'15" W C=427.95' T=216.80'	C 2 A=385.08' R=1330.00' Δ=16°35'21" S 71°47'04" W C=383.74' T=196.90'
C 3 A=40.61' MEAS R=195.98' Δ=11°52'21" S 49°12'15" W C=40.537' T=20.38'	C 4 A=51.93' R=195.98' PLAT Δ=15°10'52" S 35°40'38" W C=51.775' T=26.12' OBS
C 5 A=48.10' PLAT OBS R=167.41' PLAT Δ=16°27'38" S 36°19'00" W C=47.93' T=24.21'	

LEGEND

●	IRON PIN FOUND/SET
⊙	IRON PIPE
⊠	STONE MONUMENT
⊞	MONUMENT BOX
⊕	P.K. NAIL FOUND/SET
○	DRILL HOLE FOUND
○	CALC CALCULATED
—	MEAS MEASURED
—	OBS OBSERVED
—	DEED DEED RECITED
—	PLAT PLAT RECITED

NOTES & REFERENCES

- ALL IRON PIN SET ARE 5/8" X 30" REBAR WITH CAP "CRABBS 7245".
- DEEDS OF RECORD
- PLAT VOL. D, PG. 29
- OCCUPATION AGREES WITH TITLE LINES AS PREVIOUSLY MONUMENTED EXCEPT AS SHOWN ON THIS PLAT

THIS SURVEY WAS PERFORMED TO AN ACCURACY AS SET FORTH IN THE 2003 OHIO ADMINISTRATIVE CODE 4733-37.

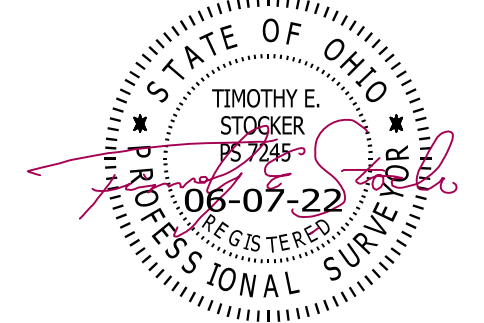

TIMOTHY E. STOCKER, P.S. 7245

PREPARED FOR: JEFFREY A. CRAFT		
PROJECT NAME: LOT SPLIT OF LANDS	PROJECT ADDRESS: 6595 6599 SWETLAND RD MADISON, OHIO	CHK: T. STOCKER DRN: S. LOVEJOY
PROJECT LOCATION: LAKE COUNTY, OHIO	JOB NUMBER: 8708	PAGE 1 OF 1

FOR INQUIRIES CONCERNING THIS SURVEY CONTACT:
CSS CRABBS' SURVEYING SERVICE
 P.O. BOX 908
 PAINESVILLE, OHIO 44077
 440-400-2025

ITEMS OF INTEREST

- NOTE 1 : CONCRETE DRIVE IS SHARED
- NOTE 2 : SUBJECTS HOUSE IS LOCATED IN RIGHT OF WAY AS SHOWN
- NOTE 3 : SUBJECTS BLACKTOP DRIVEWAY IS LOCATED IN RIGHT OF WAY



SCALE: 1" = 50'
 SURVEY: JUNE 5, 2022
 MAP: JUNE 7, 2022

