

0/0 3A-84-15

Thomas H. Coffman, PS # 6857

NORTH Ridge Road
N 73° 52' 00" E 290.15'

TOWNLINER ROAD 50'
321.05

1.4346

RESIDUE - 1.7937 AC.

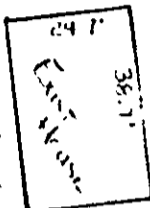

R.A. TARRANTS
VOL. 586-112

SPLIT '1' - 0.6402 AC.

NO PLAT REQUIRED
Approved by
Lake County Planning Commission
Log No. 2438-PS Date 4/13/95
8850

WEST 278.86'

SPLIT '2' - 0.6402 AC.

Solan, Mary Ann
1049-1244

WEST 278.86'

SPLIT '3' - 0.6402 AC.

Goodell

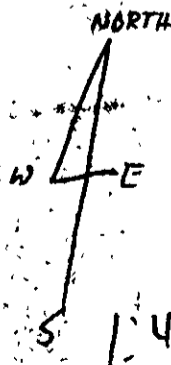

240.10
100.00
100.00
100.00
100.00
740.90
100.00

2940
500' 02' 00" W
2950
821.05'
2960
100.00'