

7 DEC. 1979

SCALE 1" = 100 ft.

- IRON PIN FOUND
- 1/2" φ IRON REBAR  
30" Long CAPPED  
"PETER 6420" SET
- PROPERTY LINE
- |- LOT LINE

ROAD DOCK

(60 ft. w.)  
N 23° 49' 00" W 701.53'

LOT 11  
TRACT 1

DAVID &  
PATRICIA  
WELCH

Doc. # 990047384

PARCEL 1  
5.7009 Ac.

(5.2177 Ac. EXCLUSIVE OF  
ROAD R/W)

S 89° 44' 00" E  
526.72'



PARCEL 2a  
4.3059 Ac.

NO PLAT REQUIRED

Approved by *man*  
Lake County Planning Commission  
Log No. 3517-sub Date 12-29-79

EXIST. DWELLING

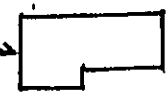

918.73'  
N 89° 44' 00" W

LOT 12  
TRACT 1

DAVID & PATRICIA WELCH  
VOL. 546 P. 931

S 89° 44' 00" E  
271.00'

PARCEL 2b  
0.8697 Ac.

271.00'  
S 89° 54' 00" E

36.18'  
104.00'

50° 42' W  
90.75'  
53° 12' W  
91.00'

33.00'  
58° 18' E

13.61'  
S 29° 15' 00" W

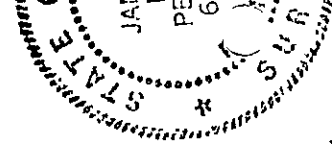

F  
OF W  
EXCLU