

THE ESTATE OF HENRY K. WHITE.

PART OF LOTS 7 AND 8, TRACT 4, WILLOUGHBY TOWNSHIP, AND PART OF TRACTS 2 AND 12, MAYFIELD TOWNSHIP.

The Bearings are given to an assumed meridian, the line between Lake and Cuyahoga Counties being taken as an East and West line. The bearings given correctly indicate the angles. Distances are given in feet and decimals. The total area equals $89 \frac{25}{100}$ acres. All of which I certify to be correct,

H. P. Cummings, surveyor.
Nov. 7, 1899.

Scale, 1 inch = 200 feet.

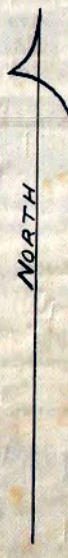

Heirs of Henry Bishop

North 1851.0

MAYFIELD TOWNSHIP

North 1851.0

North 1851.0

Lucian Bishop

John Stephenson

William Gidley

STAKE SET

STAKE SET

STAKE SET

STAKE SET

East 994.5

East 2038.2

LAKE COUNTY CUYAHOGA COUNTY

STONE FOUND 148.7 East

680.0 East

East 895.0

East 148.7

5 1/2 acres 1/2 width

RIGHT OF WAY

East line of Barn 20 FEET WIDE

N. 1° 31' W. 1040.1 EAST LINE OF LOT 7.

18 47/100 ACRES

51 22/100 ACRES

WILLOUGHBY TOWNSHIP

N. 1° 08' W. 1309.7

N. 1° 14' W. 1165.0 EAST LINE OF LOT 8

A.F. White

A.F. White

A.F. White

CENTER LINE OF ROAD CROSSING SOUTHERLY PART OF TRACT 4
 S. 68° 19' E. 730.0
 S. 88° 22' E. 338.4
 N. 77° 46' E. 621.6
 N. 87° 08' E. 375.9

East line of House

West line of Barn

East line of House

W.E. Pease

Estate of Simon Arnold

A.F. White

Lucian Bishop

John Stephenson

William Gidley