

CURVE	RADIUS	LENGTH	CHORD	BEARING	DELTA ANGLE
C1	345.00'	47.69'	47.65'	S. 88° 30' 46" W	07° 55' 11"
C2	345.00'	348.11'	333.53'	S. 55° 38' 49" W	57° 48' 43"
C3	265.00'	394.67'	359.19'	N. 48° 06' 47" W	85° 19' 55"
C4	370.00'	4.18'	4.18'	N. 87° 51' 04" W	00° 38' 51"
C5	25.00'	36.10'	33.04'	S. 46° 48' 39" E	82° 43' 40"

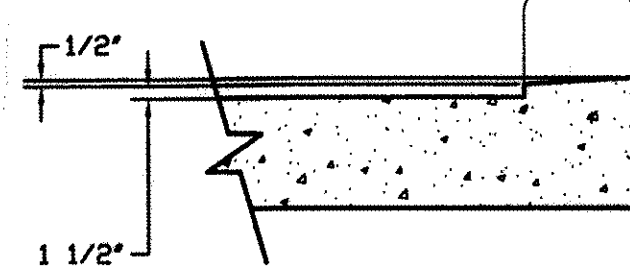
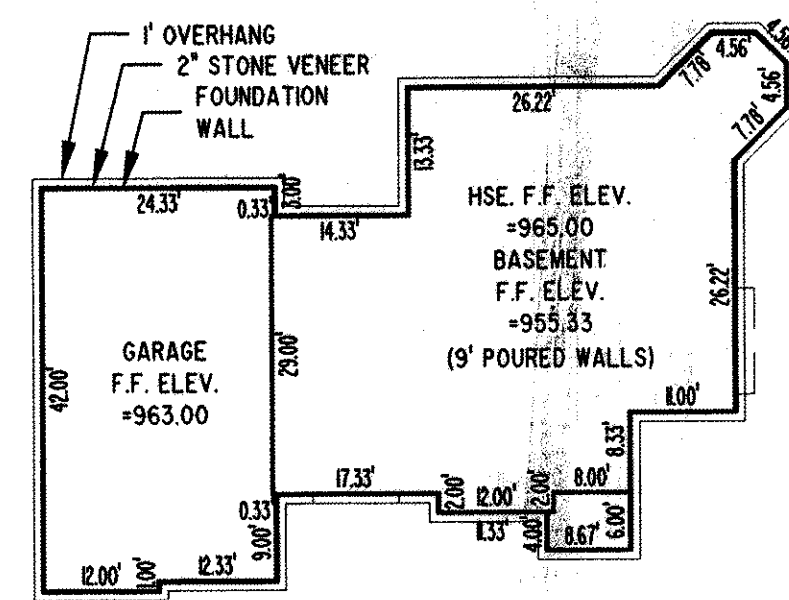

CURB CUT DETAIL

Stormwater Management Plan
Approved as shown and for noted
JAMES R. GILBERT
County Drainage Engineer
By L.S. Date 11/3/2012

1. THE TRENCH SHALL BE A MINIMUM OF 12" DEEP AND 12" WIDE
2. MINIMUM DISTANCE FROM LEACH LINE TO INTERCEPTOR DRAIN - 8'
3. THE PIPING SHALL BE PLACED AT A MINIMUM SLOPE OF 0.50%
4. THE INVERT OF THE DRAIN OUTLET SHALL BE 4" ABOVE THE RECEIVING WATER LEVEL OR GROUND SURFACE

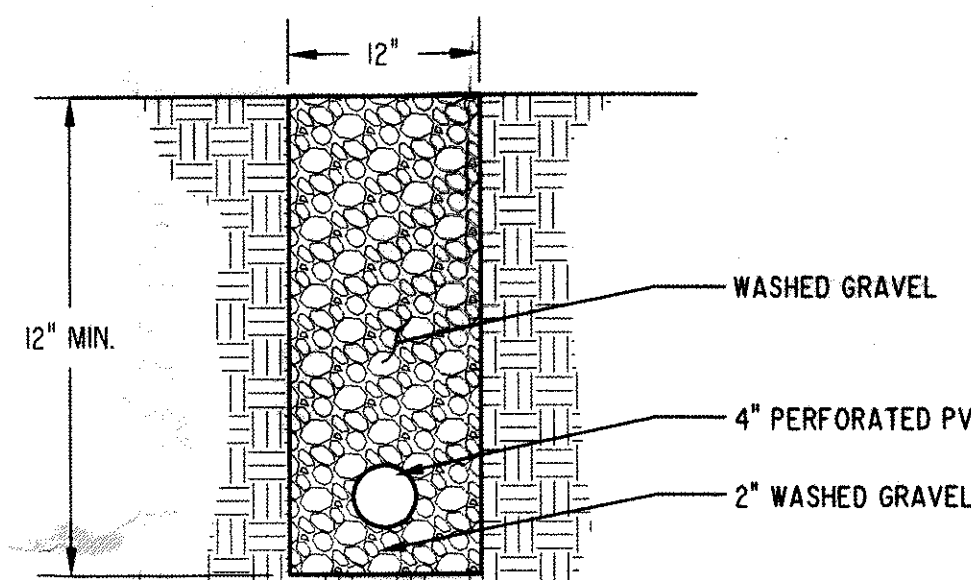

TYPICAL INTERCEPTOR DRAIN CROSS SECTION

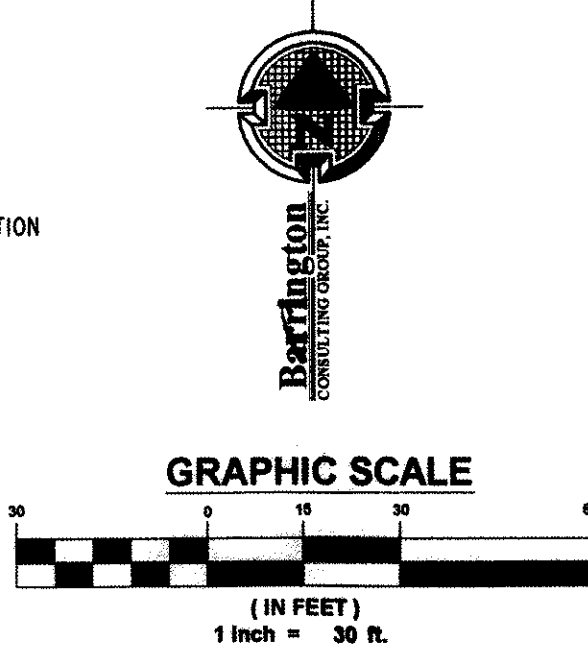

- EX. STORM MANHOLE
- EX. CURB INLET
- EX. INLET BASIN
- EX. FIRE HYDRANT
- EX. WATER VALVE
- SOIL TEST HOLE
- SIGN
- EX. UTILITY BOXES
- MONUMENT BOX FOUND
- IRON PIN FOUND

EROSION AND SEDIMENT CONTROL SCHEDULE

SILT FENCE
ALL SILT FENCE SHALL BE INSTALLED PRIOR TO ANY EARTHWORK ACTIVITIES AT THE SITE IN THE LOCATIONS SHOWN ON THE SITE PLAN AS WELL AS ALONG THE FRONT OF ANY LOT THAT SLOPES TOWARDS THE STREET.

TEMPORARY SEEDING
DISTURBED AREAS OF THE SITE THAT ARE TO REMAIN IDLE FOR MORE THAN TWENTY-ONE (21) DAYS SHALL BE PROPERLY SEEDDED AND STRAW MULCHED WITHIN SEVEN (7) DAYS OF COMPLETION OF INITIAL GRADING. TEMPORARY SEEDING AND MULCHING OF A THIRTY (30) FOOT STRIP OF THE ENTIRE FRONT OF THE LOT SHALL BE MAINTAINED ON THE SITE ONCE INITIAL GRADING IS COMPLETE.

MULCHING
STRAW MULCH SHALL BE APPLIED AT A RATE OF 1 BALE PER EVERY TEN (10) FEET OF CURB, AT A WIDTH OF THIRTY (30) FEET OF THE ENTIRE LENGTH OF THE LOT. WOOD CHIPS MAY ALSO BE USED BUT MUST BE SPREAD AT A MINIMUM DEPTH OF FOUR INCHES OVER THE THIRTY-FOOT WIDTH AND MUST BE ACCOMPANIED BY A PROPERLY INSTALLED SILT FENCE.

MAINTENANCE
EROSION AND SEDIMENT CONTROLS SHALL BE INSPECTED EVERY SEVEN (7) DAYS OR WITHIN 24 HOURS OF A 0.5" OR GREATER RAINFALL EVENT. NECESSARY REPAIRS SHALL BE MADE AT THIS TIME.

NOTE:
ALL EROSION AND SEDIMENT CONTROL SPECIFICATIONS, APPLICATIONS, AND TIMETABLES ARE BASED ON THE DESCRIPTIONS AND STANDARDS OF THE OHIO DEPARTMENT OF NATURAL RESOURCES "RAINWATER AND LAND DEVELOPMENT MANUAL" AND CAN BE FOUND IN THE LAKE COUNTY EROSION AND SEDIMENT CONTROL RULES AS ADOPTED DECEMBER 21, 1999.

THE SPECIFIED EROSION AND SEDIMENT CONTROL STANDARDS ARE GENERAL GUIDELINES AND SHALL NOT LIMIT THE RIGHT OF THE COUNTY TO IMPOSE, AT ANY TIME, ADDITIONAL, MORE STRINGENT REQUIREMENTS. NOR SHALL THE STANDARDS LIMIT THE RIGHT OF THE COUNTY TO WAIVE, IN WRITING, INDIVIDUAL REQUIREMENTS.

EROSION AND SEDIMENT CONTROL SCHEDULE

INGRESS-EGRESS
A STONE ACCESS DRIVE COMPLETE WITH UNDERLYING GEO-TEXTILE FABRIC (20 FEET WIDE AND 50 FEET LONG) FOR INGRESS AND EGRESS AT THE SITE SHALL BE INSTALLED. THIS DRIVE SHALL BE THE ONLY ENTRANCE AND EXIT TO THE SITE.

STREETS DIRECTLY ADJACENT TO THE CONSTRUCTION ENTRANCES AND RECEIVING TRAFFIC FROM THE DEVELOPMENT AREA, SHALL BE CLEANED DAILY TO REMOVE SEDIMENT TRACKED OFF-SITE. IF APPLICABLE, THE CATCH BASINS ON THESE STREETS NEAREST TO THE CONSTRUCTION ENTRANCES SHALL BE CLEANED WEEKLY.

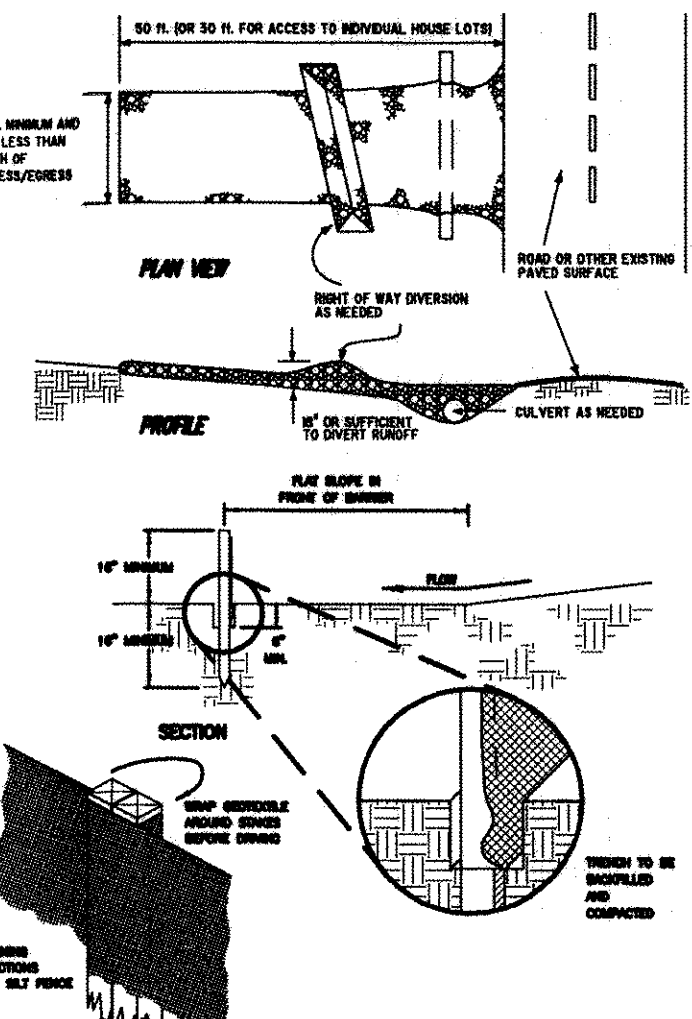

TEMPORARY SEEDING SPECIFICATIONS			
SEEDING DATES	SPECIES	LB./1000 FT.	PER AC.
MARCH 1 TO AUGUST 15	OATS	3	4 BUSHEL
	TALL FESCUE	1	40 LB.
	ANNUAL RYEGRASS	1	40 LB.
	PERENNIAL RYEGRASS	1	40 LB.
	TALL FESCUE	1	40 LB.
AUGUST 16 TO NOVEMBER 1	ANNUAL RYEGRASS	1	40 LB.
	RYE	3	2 BUSHEL
	TALL FESCUE	1	40 LB.
	ANNUAL RYEGRASS	1	40 LB.
	WHEAT	3	2 BUSHEL
NOVEMBER 1 TO SPRING SEEDING	TALL FESCUE	1	40 LB.
	ANNUAL RYEGRASS	1	40 LB.
	PERENNIAL RYEGRASS	1	40 LB.
	TALL FESCUE	1	40 LB.
	ANNUAL RYEGRASS	1	40 LB.

NOTE: OTHER APPROVED SEED SPECIES MAY BE SUBSTITUTED.

REVIEWED AND ACCEPTED
LAKE COUNTY GENERAL
HEALTH DISTRICT
12/23/12

SEWAGE DISPOSAL PERMIT MUST BE
OBTAINED BY A LAKE COUNTY LICENSED
SEWER INSTALLER BEFORE INSTALLATION IS
STARTED

Sub. SB 110 Section 3718.023(D) states that site
approvals granted by the Board of Health after
September 17, 2010 & prior to January 1, 2012 are
valid for 3 years from the date of the approved site
application (approved sewage system site plans).

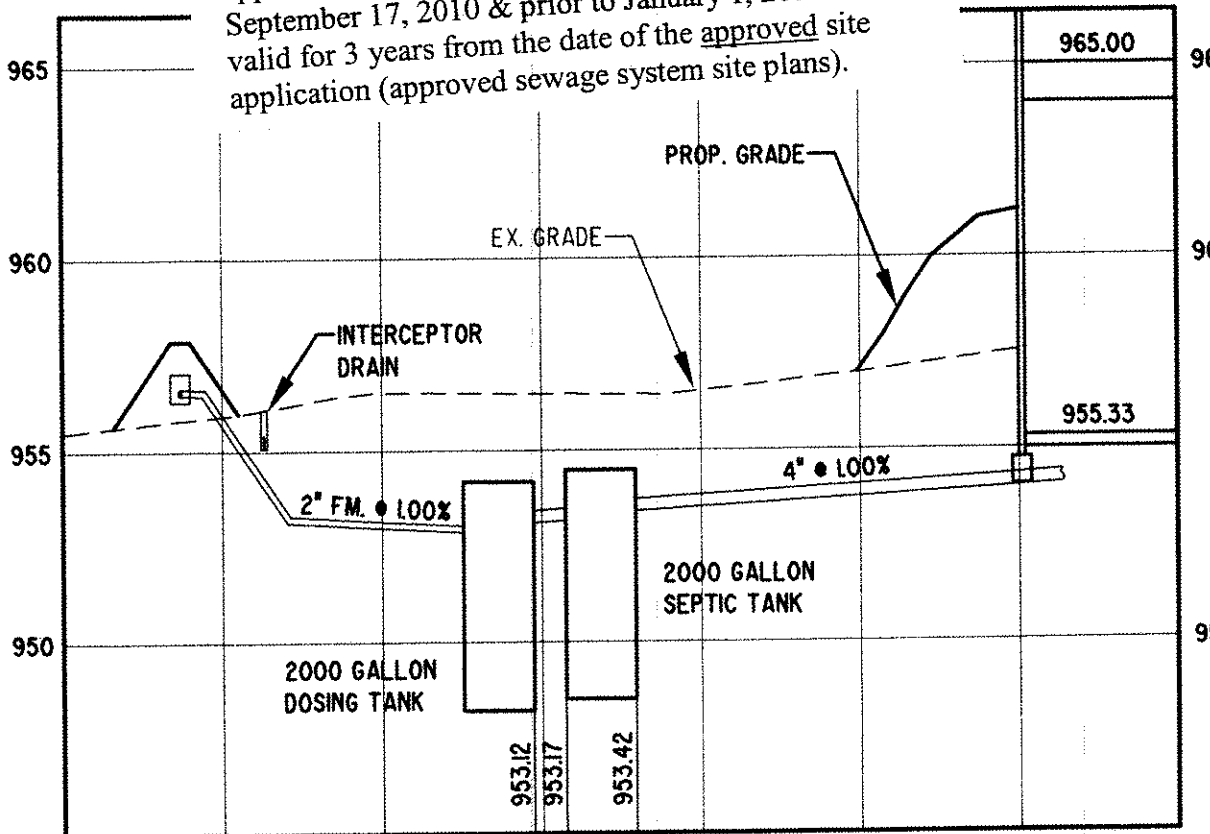

HYDRAULIC PROFILE

SCALE: 1"=30', 1"=5'

THIS PARTICULAR PROJECT WAS DESIGNED FOR A THREE BEDROOM HOUSE PRODUCING AN AVERAGE FLOW OF 288 GALLONS PER DAY AND HAVING RESIDENTIAL STRENGTH WASTEWATER OF 140 MGAL OF BOD(5). THE SYSTEM DESIGN IS CAPABLE OF ACCOMMODATING PEAK FLOW OF UP TO 480 GALLONS PER DAY AND WASTEWATER STRENGTHS NOT TO EXCEED 250 MGAL OF BOD(5) FOR SHORT PERIODS OF TIME.
THE SEPTIC SYSTEM DESIGN IS BASED UPON A SOIL REPORT PREPARED BY FLOYD McCLARY & RAY BURNS DATED OCTOBER 12, 2011.

SEPTIC SYSTEM NOTES:

1. ALL ASPECTS OF THE SEPTIC SYSTEM SHALL ADHERE TO THE CURRENT REGULATIONS OF THE OHIO DEPARTMENT OF HEALTH AND THE LAKE COUNTY GENERAL HEALTH DISTRICT PART (CHAPTER) 29 "SEWAGE TREATMENT SYSTEM RULES"
2. THE FULL SOIL ABSORPTION AREA AND ANY APPLICABLE DOWNHILL UNDISTURBED AREAS OF THE PROPOSED AND DUPLICATION SYSTEM SHALL BE FREE OF ANY SITE DISTURBANCE. IF ANY DISTURBANCE OR DAMAGE HAS OCCURRED, INSTALLATION SHALL NOT PROCEED AND THE REGISTERED INSTALLER SHALL CONTACT THE OWNER AND THE LAKE COUNTY GENERAL HEALTH DISTRICT.
3. THE SYSTEM MUST BE INSTALLED WHEN THE SOILS ARE DRY. THE INSTALLATION OF A SYSTEM IN WET CONDITIONS CAN CAUSE SOIL COMPACTION AND SMEARING WHICH LEADS TO SYSTEM FAILURE.
4. PRIOR TO EXCAVATION, THE REGISTERED INSTALLER SHALL CHECK ALL ELEVATIONS IN THE LAYOUT PLAN RELATIVE TO THE ESTABLISHED BENCHMARK.
5. THE INSTALLER MUST BE REGISTERED AND APPROVED PER THE LAKE COUNTY GENERAL HEALTH DISTRICT.
6. THE SYSTEM INSTALLER SHALL CONSULT WITH THE DESIGNER PRIOR TO ANY INTENDED CHANGES TO THE SYSTEM.
7. THE SYSTEM INSTALLER SHALL COORDINATE WITH THE DESIGNER IN ORDER TO PROVIDE AN ACCURATE AS-BUILT.
8. THE PROPOSED SEPTIC FIELD AREA, DUPLICATION AREA AND ANY APPLICABLE DOWNHILL UNDISTURBED AREAS SHALL BE ROPED OFF PRIOR TO THE START OF ANY CONSTRUCTION TO PREVENT DISTURBANCE TO THESE AREAS.
9. MOUNDS SHALL NOT BE INSTALLED WHERE GROUND SLOPES EXCEED 15%.
10. ALL ELECTRICAL WORK SHALL COMPLY WITH THE NATIONAL ELECTRICAL CODE.

GENERAL NOTES:

1. BENCHMARK - TOP STEM OF EXISTING FIRE HYDRANT LOCATED AT THE INTERSECTION OF QUARRY VIEW LN. & STRUMBLY GLEN, ELEVATION = 958.02.
2. DRIVEWAY APRON TO BE 6" THICK CONCRETE.
3. ALL DOWNSPOUTS TO BE OUTLETED TO SPLASH BLOCKS.
4. CONTRACTOR RESPONSIBLE FOR CONTACTING THE OHIO UTILITY PROTECTION SERVICE (1.800.362.2764) AND ALL UTILITY COMPANIES A MINIMUM OF 48 HOURS PRIOR TO CONSTRUCTION.
5. THE LOCATION BOTH HORIZONTAL AND VERTICAL OF EXISTING UNDERGROUND UTILITIES SHOWN HEREON HAVE BEEN OBTAINED BY A DILIGENT AND COMPREHENSIVE SEARCH OF AVAILABLE RECORDS. VERIFICATION BY FIELD OBSERVATION HAS BEEN CONDUCTED WHERE PRACTICAL HOWEVER, BARRINGTON CONSULTING GROUP, INC. DOES NOT GUARANTEE THE COMPLETENESS, NOR ACCURACY THEREOF.
6. CONTRACTOR SHALL VERIFY ELEVATIONS OF LATERAL INVERTS IN THE FIELD PRIOR TO FOUNDATION EXCAVATION.

CERTIFICATION:

THIS PLAN REPRESENTS A SURVEY WHICH MEETS THE MINIMUM STANDARDS FOR A BOUNDARY SURVEY IN THE STATE OF OHIO AS SPECIFIED IN THE ADMINISTRATIVE CODE CHAPTER 4733-37. SURVEYED ON JULY 21st 2010 UNDER THE SUPERVISION OF DAVID W. NOVAK, P.S. No. 7507. ALL PINS SHOWN WERE EITHER FOUND OR NOTED

"I THE UNDERSIGNED HEREBY CERTIFY THAT THIS TOPOGRAPHY INDICATED BY 1' CONTOURS AND ELEVATIONS SHOWN HEREON REPRESENTS AN ACTUAL SURVEY MADE BY ME ON THE 17th DAY OF NOVEMBER, 2011 AND THE ELEVATIONS WERE TAKEN AT APPROPRIATE INTERVALS AND AS OF THAT DAY THEY EXISTED AS INDICATED HEREON.

"I HEREBY CERTIFY THAT THIS PLAN WAS PREPARED BY ME AND IS CORRECT TO THE BEST OF MY KNOWLEDGE"

DAVID W. NOVAK, P.S. No. 7507

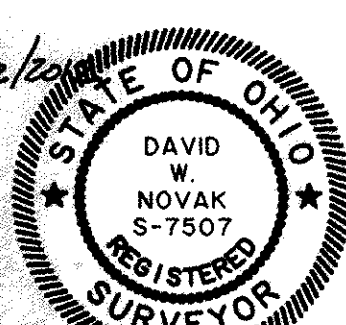

REVISIONS	BY
12/21/11	TDR

Barrington
CONSULTING GROUP, INC.
9114 TYLER BLVD., MENTOR, OHIO 44060
PHONE 440.205.1260 FAX 440.205.1262
www.BarringtonCGI.com

VELOTA CONSTRUCTION
TONY VELOTTA
2839 RIVERS EDGE DR.
WILLOUGHBY HILLS, OHIO 44094
PH: 440.943.2893/FAX: 440.951.6565

SITE PLAN
10128 QUARRY CT., KIRTLAND, OHIO 44094
SL 9 CHAPIN LEDGES SUBDIVISION VOL. 54 PG. 8
HOSTELLEY RESIDENCE

DRAWN
W.S.O.
CHECKED
D.W.N.
DATE
NOV. 22, 2011
SCALE
1"=30'
JOB NO.
11101
SHEET
1/2