

UNIT 59  
PAYTON MODEL  
BASEMENT  
12' x 24' DECK/PATIO

NOTE:  
AN ALTERNATE SOURCE OF  
POWER SHALL BE PROVIDED  
FOR THE SUMP PUMP ON ALL  
UNITS THAT REQUIRE SUMP  
PUMPS.

### "AS-BUILT" CERTIFICATION

I HEREBY CERTIFY THAT THE CIRCLED  
INFORMATION IS EXISTING AS OBTAINED ON  
THE SITE AND IS  
CORRECT TO THE BEST OF MY KNOWLEDGE  
AND BELIEF.

I ALSO HEREBY CERTIFY THAT AS OF THAT  
DATE EROSION CONTROL ITEMS WERE IN  
PLACE PER THE APPROVED SITE PLAN.

DATE \_\_\_\_\_ NAME \_\_\_\_\_

**SITE PLAN GENERAL NOTES:**  
SEE IMPROVEMENT PLANS FOR THE LANDING  
AT DUGAN'S FARM CONDO, PHASE 3, FOR  
EROSION CONTROL AND GRADING ITEMS.

THE CONDOMINIUM BOUNDARY MUST BE  
STAKED TO CONFIRM BUILDING LOCATIONS.

DRIVEWAYS SHALL BE 6" THICK AND HAVE  
3' FLARES ON EACH SIDE.

F.G. = ELEVATION OF GARAGE FLOOR AT  
FRONT OF GARAGE.

000.00 = SPOT ELEVATIONS

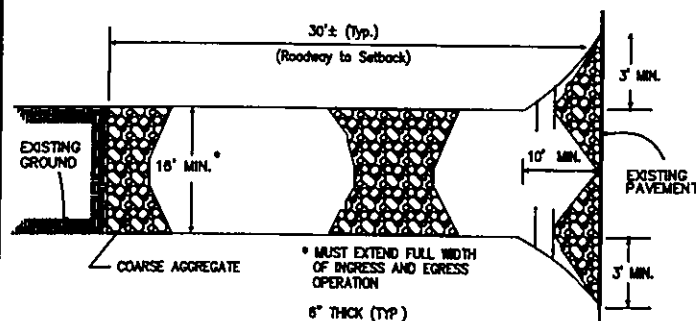

STONE CONSTRUCTION ENTRANCE  
NO SCALE

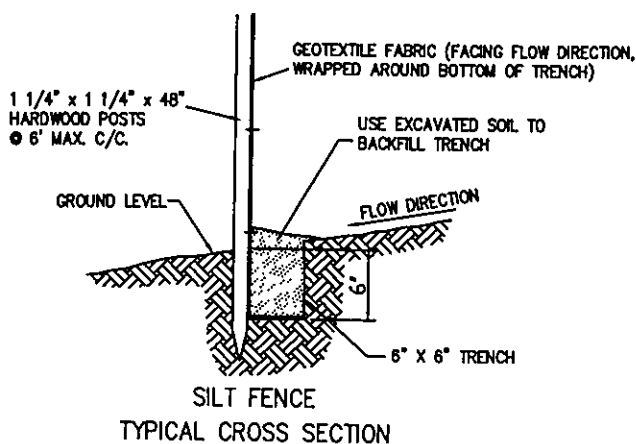

APPROVED

☐ AS NOTED

☒ AS SUBMITTED

☐ NOT APPROVED

*JEW 16-5-07*

SIGNATURE

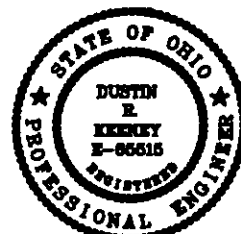

I, THE UNDERSIGNED, HEREBY CERTIFY THAT THIS  
TOPOGRAPHY, INDICATED BY 6", 1", OR 2" CONTOURS,  
AND ELEVATIONS SHOWN HEREON, REPRESENT AN  
ACTUAL FIELD SURVEY MADE BY ME ON THE 9th  
DAY OF MARCH, 2006, AND THAT THE ELEVATIONS  
WERE TAKEN AT APPROPRIATE INTERVALS AND THAT AS  
OF THAT DATE, THEY EXISTED AS INDICATED HEREON.

*Dustin R. Keeney*  
DUSTIN R. KEENEY, P.E. # 85515



2 WORKING DAYS  
BEFORE YOU DIG

CALL TOLL FREE 800-362-2764

OHIO UTILITIES PROTECTION SERVICE  
NON-MEMBERS MUST BE CALLED DIRECT



**EXISTING UNDERGROUND UTILITIES NOTE:**  
THE SIZE AND LOCATION, BOTH HORIZONTAL AND VERTICAL  
OF THE UNDERGROUND UTILITIES SHOWN HEREON, HAVE BEEN  
OBTAINED BY A SEARCH OF AVAILABLE RECORDS. VERIFICATION  
BY FIELD OBSERVATION HAS BEEN CONDUCTED WHERE PRACTICAL.  
HOWEVER, POLARIS ENGINEERING & SURVEYING, INC. DOES NOT  
GUARANTEE THE COMPLETENESS NOR ACCURACY THEREOF.

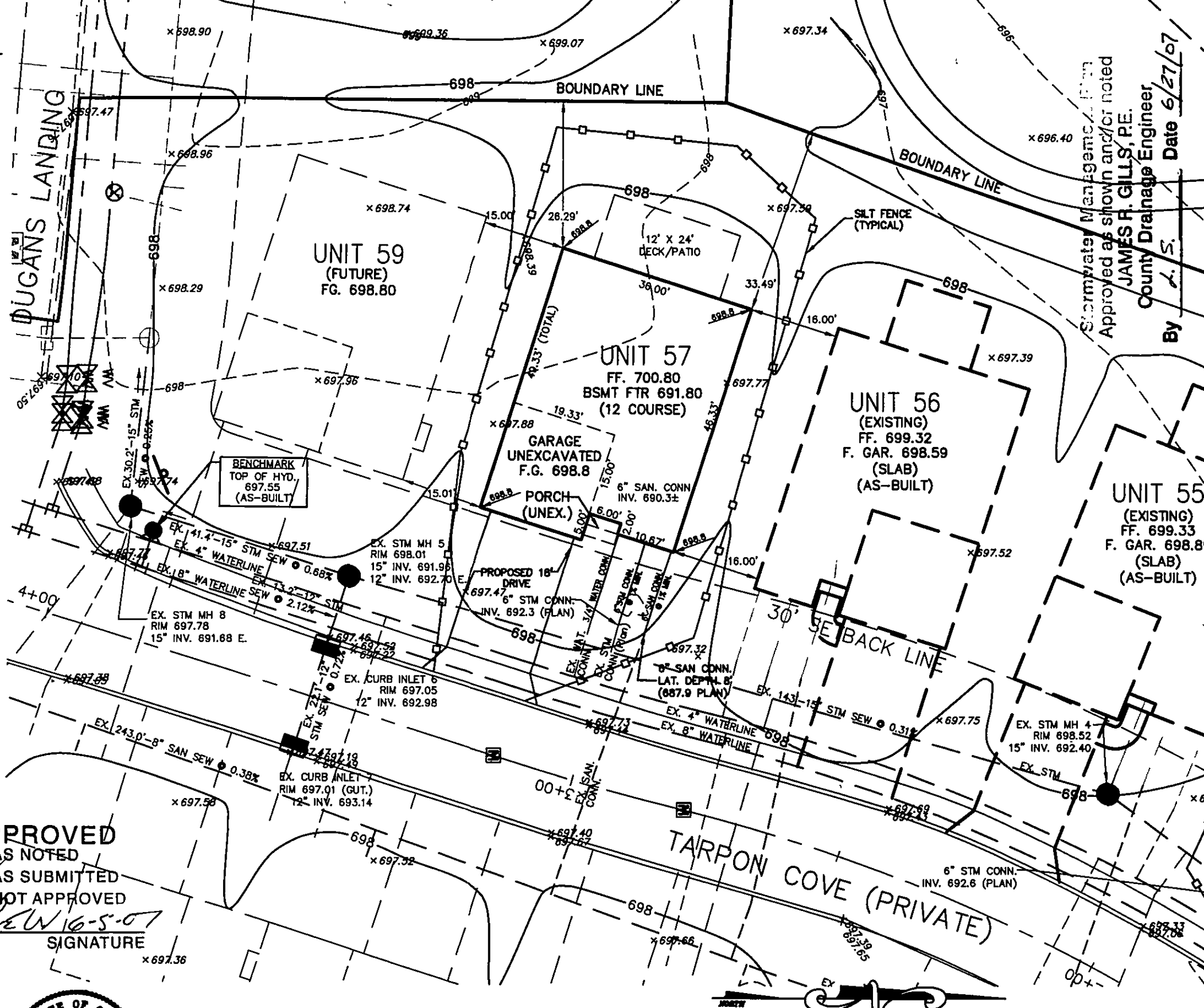

**POLARIS ENGINEERING  
& SURVEYING, INC.**  
34600 CHARDON ROAD  
SUITE D  
WILLOUGHBY HILLS, OH 44094  
(440) 844-4433  
(440) 844-3722 (Fax)  
www.polaris-es.com

DATE: 5/29/07  
SCALE: HOR. 1"=20'  
VERT. none  
FILENAME: 07-0529  
Unit 57  
Tab: Unit 57

SITE PLAN FOR:  
SUBLOT No. 57  
(3984 Tarpon Cove)  
**The Landing At Dugan's Farm  
Condo, Phase 3**  
PERRY VILLAGE - LAKE COUNTY - OHIO

OWNER:  
DUGAN'S LANDING, LLC  
P.O. BOX 949  
CHARDON, OHIO 44024

PHONE: (440) 354-8401  
FAX: (440) 354-5780

CONTACT:  
Bob Johnson

CONTRACT No.  
03530

SHEET	OF
1	1