

LOW YIELD WATER
FIXTURES REQUIRED
ON ALL:

SEWAGE DISPOSAL PERMIT MUST BE
OBTAINED BY A LAKE COUNTY LICENSED
INSTALLER BEFORE INSTALLATION IS
STARTED.

Shower Head
Toilet

Reviewed and Accepted
LAKE COUNTY GENERAL HEALTH DISTRICT
Date 10.8.92
JOEL LUCIA, R. S., M. P. H.
Health Commissioner
BY N. Niekus

- A. To be brought to finished grade
- 1. Septic tank manhole covers
- 2. Splitter box cover
- 3. Distribution box cover
- B. No footer drains or downspouts
to be discharged into septic tanks
- C. All waste water to be discharged into
septic tanks

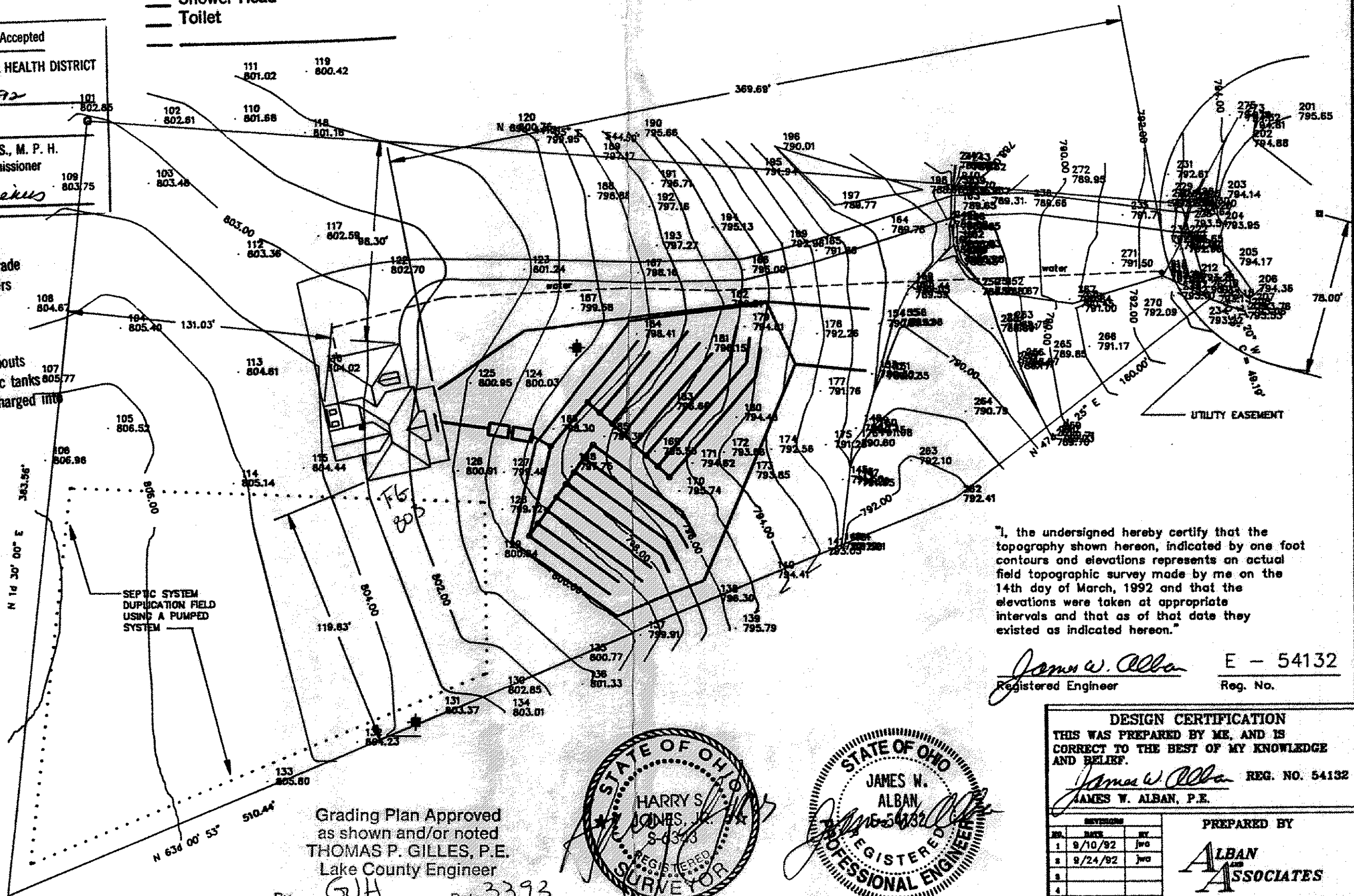

SEPTIC SYSTEM
DUPLICATION FIELD
USING A PUMPED
SYSTEM

Grading Plan Approved
as shown and/or noted
THOMAS P. GILLES, P.E.
Lake County Engineer

By GJH Date 3/3/93
DOWN SPOUTS TO SPLASH BLOCKS

"I, the undersigned hereby certify that the
topography shown hereon, indicated by one foot
contours and elevations represents an actual
field topographic survey made by me on the
14th day of March, 1992 and that the
elevations were taken at appropriate
intervals and that as of that date they
existed as indicated hereon."

James W. Alban
Registered Engineer

E - 54132
Reg. No.

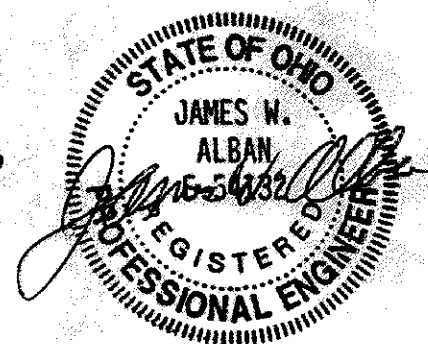
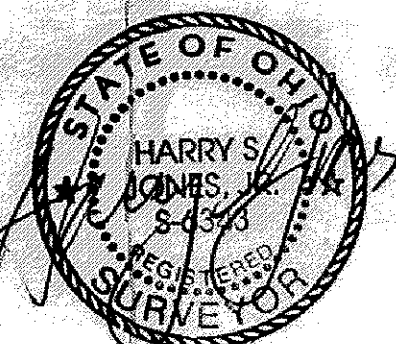

DESIGN CERTIFICATION			
THIS WAS PREPARED BY ME, AND IS CORRECT TO THE BEST OF MY KNOWLEDGE AND BELIEF.			
<u>James W. Alban</u>			REG. NO. 54132
JAMES W. ALBAN, P.E.			
REVISIONS			PREPARED BY
NO.	DATE	BY	
1	8/10/92	jwa	ALBAN ASSOCIATES PAINESVILLE, OHIO
2	9/24/92	jwa	
3			
4			
DRAWN BY jwa			SCALE 1" = 50'
DATE 8/10/92			DRAWING NO. S1