

SYMBOL LEGEND	
	Iron Pin Monument Found
	Ex. Gas Valve
	Iron Pin Set
	Ex. Catch Basin
	Ex. Tree
	Ex. Water Service Valve
	Ex. Fire Hydrant
	Ex. Telephone Ped.
	Ex. Electric Box
	Ex. Cable TV Box
	Iron Pin Found
	Prop. Drainage Flow Direction
	Ex. Manhole
	Ex. Pine
	Ex. Water Valve

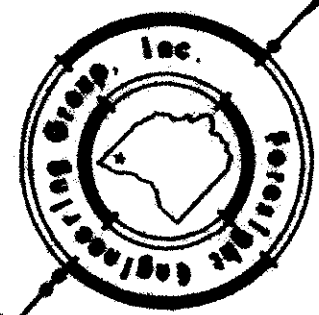
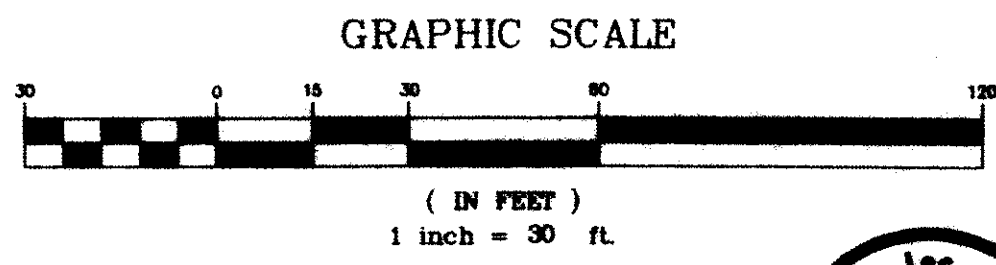

Grading Plan Approved
as shown and/or noted
THOMAS P. GILLES, P.E.
Lake County Engineer

By 6/14 Date 8-27-97

ROOF DRAINS
SHALL DISCHARGE
TO SPLASH BLOCKS

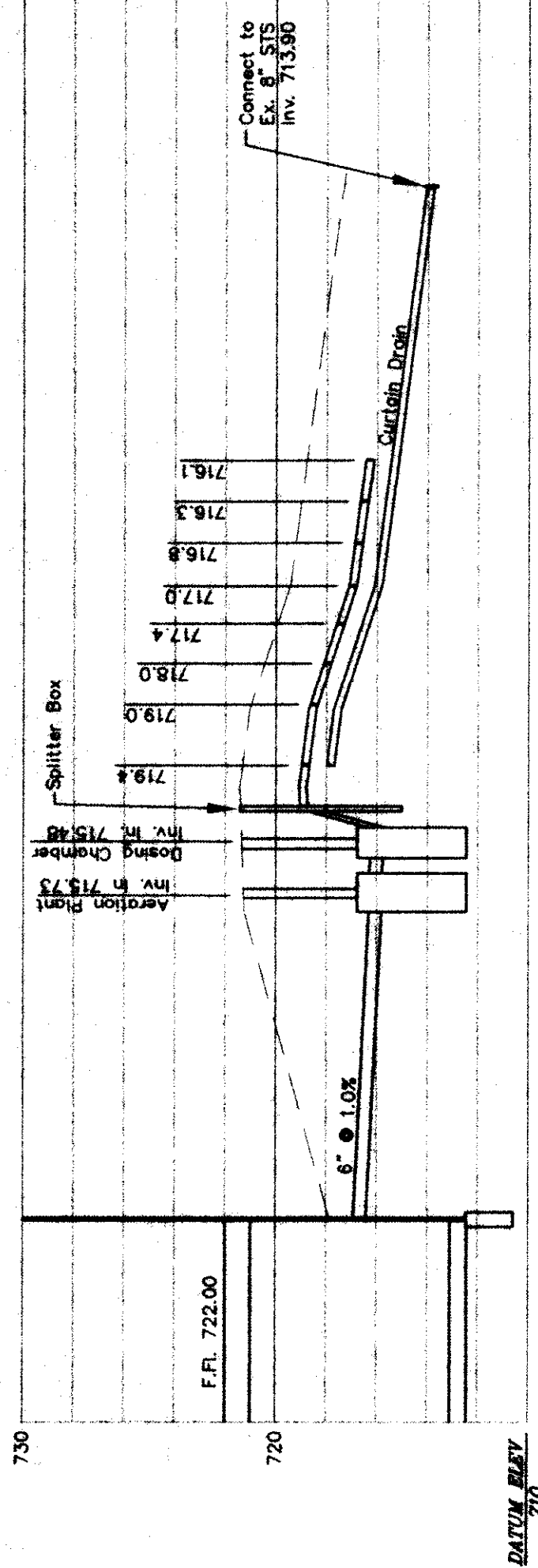

HYDRAULIC PROFILE
1"=30' Horiz. 1"=6' Vert

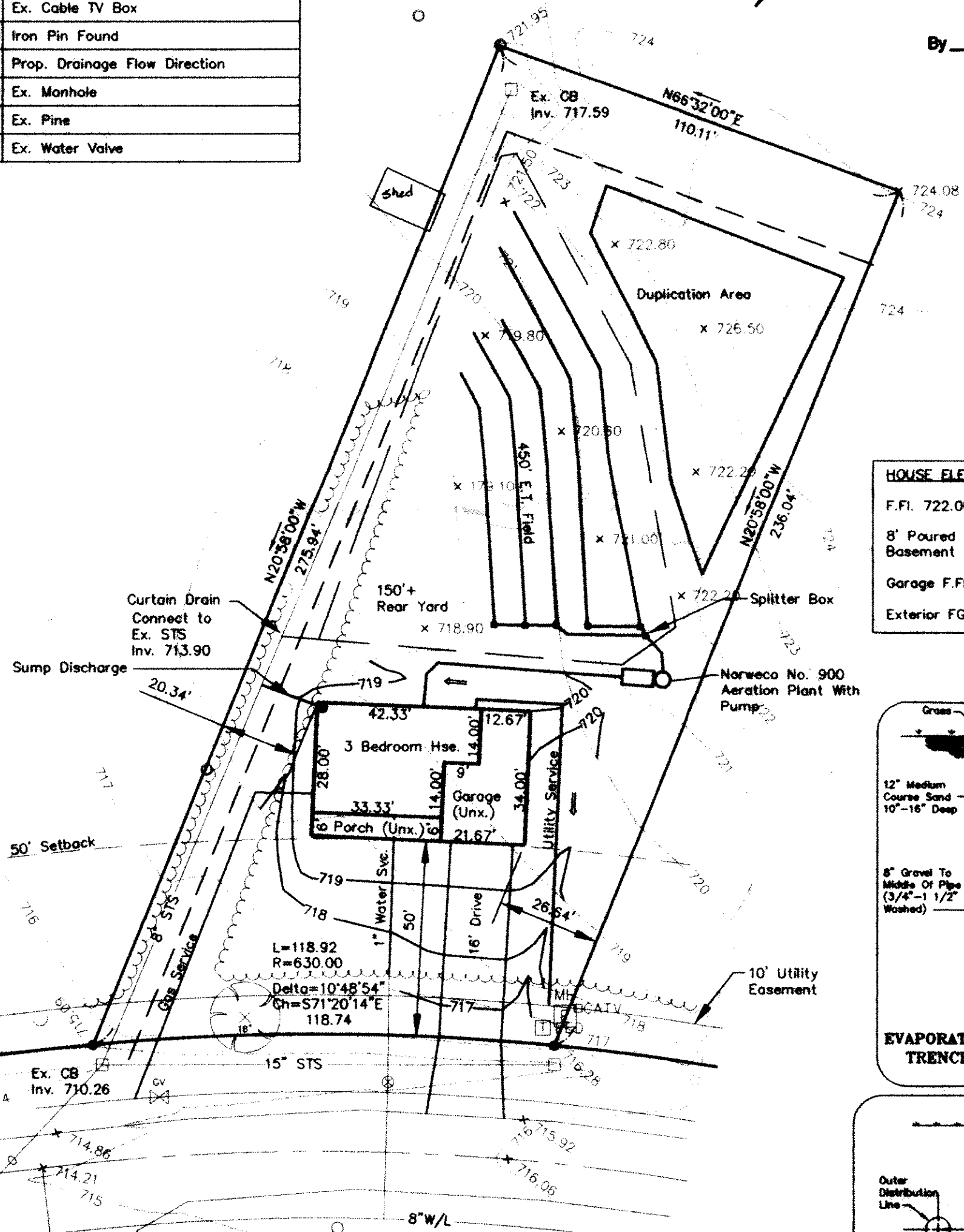

HOUSE ELEVATIONS
F.F.I. 722.00
8" Poured Basement Walls
Basement F.F.I. 713.33
Garage F.F.I. 720.00
Exterior FG 720.0

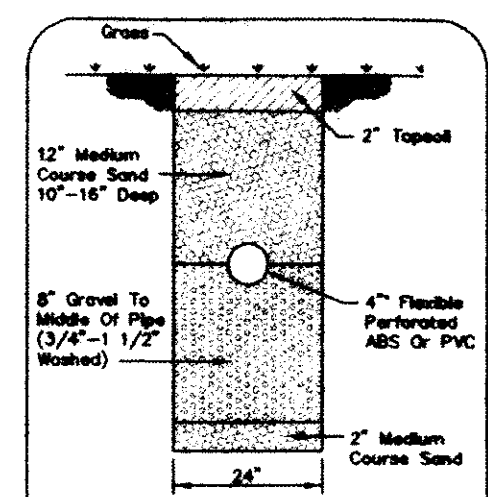

EVAPORATION-TRANSPIRATION
TRENCH CROSS-SECTION
NO SCALE

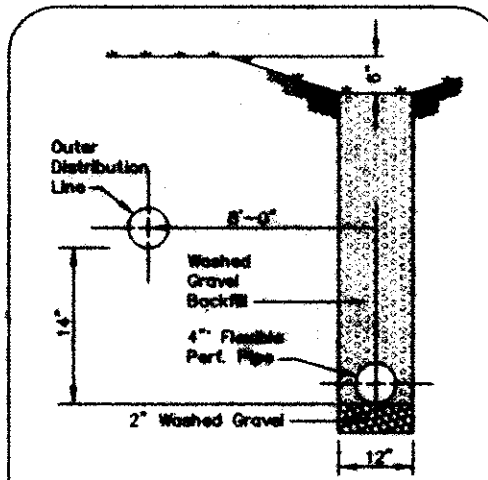

CURTAIN DRAIN CROSS SECTION
NO SCALE

APPROVED
SIDE LINES & SET BACK
PERRY TOWNSHIP ZONING
PERMIT NO. 6524
ZONING INSPECTOR

SITE PLAN

for : McCullough Builder CLIENT
P.O. Box 349 ADDRESS Perry Oh 44081 CITY STATE ZIP

17 SUBLOT No. South Perry Pines SUBDIVISION NAME VOL. PAGE
Perry Ohio CITY STATE

Foresight Engineering Group
Engineers & Surveyors
216 286-1010
216 286-1034 fax
320 Center Street, Unit F
Chardon, Ohio 44024

DESIGN CERTIFICATION

This Site Plan was prepared by Foresight Engineering Group, Inc., and is correct to the best of my knowledge and belief.

Steve N. Roessner
NAME

CHECK LIST

LOT DIMENSIONS & BEARINGS
TIE TO NEAREST STREET
SUBLOT No. (PARCEL No.)
SURROUNDING OWNERS
BUILDING DIMENSIONS
SETBACK, SIDEYARD, REARYARD
FINISH GRADES
DRIVE & APRON TYPE, WIDTH, THICKNESS
SIDEWALK TYPE, WIDTH, THICKNESS
CULVERT TYPE, DIAM., LENGTH
WATER MAIN SIZE, LOCATION
SAN. SEWER SIZE, % GRADE, LOC.
SAN. MH. CAST. ELEV., INV. ELEV.
SAN. CONN. SIZE, % GRADE, LOC.
STORM SEWER SIZE, % GRADE, LOC.
STORM MH. CAST. ELEV., INV. ELEV.
PAVT TYPE, GRADE, CURBS
GAS LINE LOC., SIZE
SEPTIC SYSTEM & DUPLICATION
WELL LOCATION & ISOLATION RADIUS

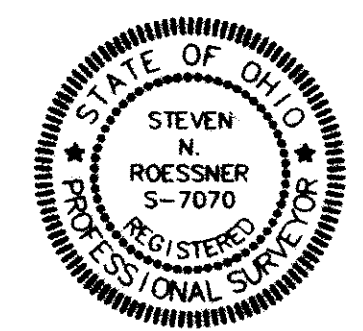

STATE SEAL

"AS BUILT" CERTIFICATION

I hereby certify that the circled information is existing as obtained on the site 19 and is correct to the best of my knowledge and belief.

NAME

SCALE : 1" = 30'	1
FILE NAME: I:\MCC19703\topo	2
DATE : July 25, 1997	3

BENCHMARK:

Top stem of fire hydrant located
opposite S/L 17 - EL. 717.74

"I, the undersigned hereby certify that this topography, indicated by 6", 1' or 2' contours, and the elevations shown hereon represent an actual field survey made by Foresight Engineering Group, Inc. on the 24th day of July 19 97 and that the elevations were taken at appropriate intervals and that as of that date they existed as indicated hereon."

Steve N. Roessner
NAME



EXISTING UNDERGROUND UTILITIES NOTES:

The location both horizontal and vertical of the underground utilities shown hereon, have been obtained by a diligent and comprehensive search of available records. Verification by field observation, has been conducted where practical. However, Foresight Engineering Group, Inc. does not guarantee the completeness nor accuracy thereof.