

W:\2009-09-01\0000018 09045 Bldg.dwg 6/29/2009 12:11:34 PM C:\Program Files\Autodesk\AutoCAD 2009\AutoCAD.exe

FORM W \BLOCKS\FORMS\BCGA3-SHARP.DWG

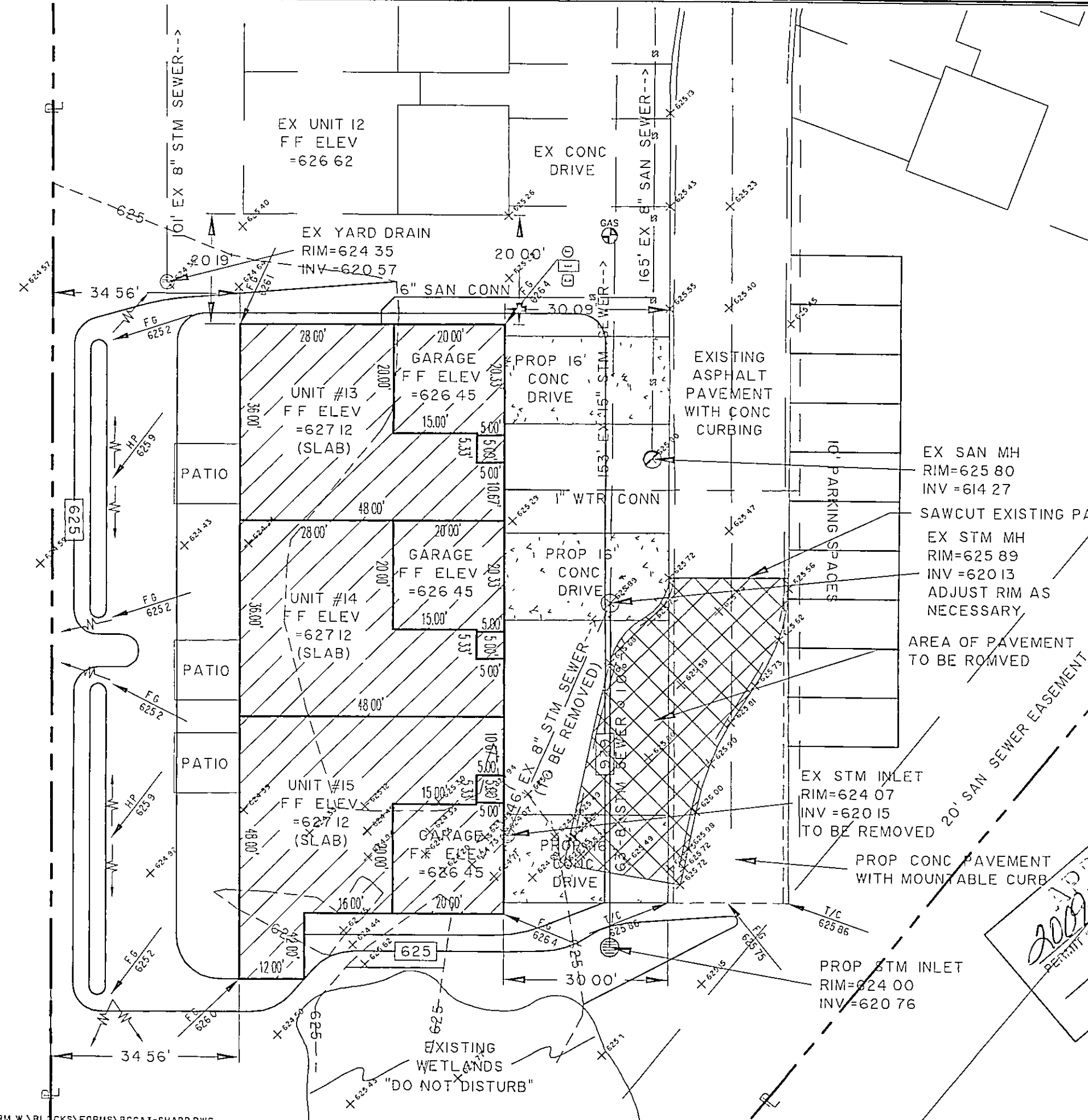

GENERAL NOTES:

- 1. BENCHMARK - RIM OF EXISTING SANITARY LOCATED IN FRONT OF PROPOSED UNIT 13, ELEVATION = 625.80.
- 2. DRIVEWAY APRON TO BE 6" THICK CONCRETE.
- 3. ALL DOWNSPOUTS TO BE OUTLETED TO SPLASH BLOCKS.
- 4. CONTRACTOR RESPONSIBLE FOR CONTACTING THE OHIO UTILITY PROTECTION SERVICE (1.800.362.2764) AND ALL UTILITY COMPANIES A MINIMUM OF 48 HOURS PRIOR TO CONSTRUCTION.
- 5. THE LOCATION BOTH HORIZONTAL AND VERTICAL OF EXISTING UNDERGROUND UTILITIES SHOWN HEREON, HAVE BEEN OBTAINED BY A DILIGENT AND COMPREHENSIVE SEARCH OF AVAILABLE RECORDS. VERIFICATION BY FIELD OBSERVATION HAS BEEN CONDUCTED WHERE PRACTICAL, HOWEVER, BARRINGTON CONSULTING GROUP, INC. DOES NOT GUARANTEE THE COMPLETENESS, NOR ACCURACY THEREOF.
- 6. CONTRACTOR SHALL VERIFY ELEVATIONS OF LATERAL INVERTS IN THE FIELD PRIOR TO FOUNDATION EXCAVATION.
- 7. SEE SHEET 2 FOR EROSION AND SEDIMENT-CONTROL PLAN
- 8. SEE SHEET 2 FOR SEEDING INFORMATION

CERTIFICATION :

"I THE UNDERSIGNED HEREBY CERTIFIES THAT THIS TOPOGRAPHY INDICATED BY 1 FOOT CONTOURS AND ELEVATION SHOWN HEREON REPRESENTS AN ACTUAL SURVEY MADE BY ME ON THE 16th DAY OF JUNE, 2009 AND THE ELEVATIONS WERE TAKEN AT AN APPROPRIATE INTERVAL AND AS OF THAT DAY THEY EXISTED AS INDICATED HEREON

"I HEREBY CERTIFY THAT THIS PLAN WAS PREPARED BY ME AND IS CORRECT TO THE BEST OF MY KNOWLEDGE AND BELIEF"

David W. Novak
DAVID W. NOVAK, P.S. No. 7507
CERT 1 EWG

James R. Gills
DATE 7/1/09
Painesville Township
Zoning Inspector

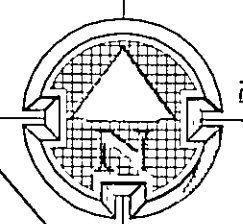

Barrington
CONSULTING GROUP, INC.

Stormwater Management Plan
Approved as shown and/or noted
JAMES R. GILLS, P.E.
County Drainage Engineer
By *J.S.* Date 7-16-09

GRAPHIC SCALE

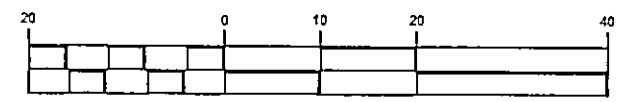

09045-BLDG 5

REVISIONS	BY

Barrington
CONSULTING GROUP, INC.
9114 TYLER BLVD., MENTOR, OHIO 44060
PHONE 440.205.1260 FAX 440.205.1262
www.BarringtonCGI.com

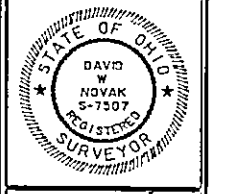

SITE PLAN
ZEPHYR DR., PAINESVILLE TWP. OHIO 44077
NAUTICA AT LAKE ERIE SHORES VOL. 57 PG. 5
PROBUILT HOMES, INC.

DRAWN WSO
CHECKED DWN
DATE JUNE 29, 2009
SCALE 1" = 20'
JOB NO. 09045-BLDG 5
SHEET 1/2
OF SHEETS